

STEP 1
PLACE THE FIRST COURSE OF SOIL REINFORCEMENT MATS ON PREPARED FOUNDATION

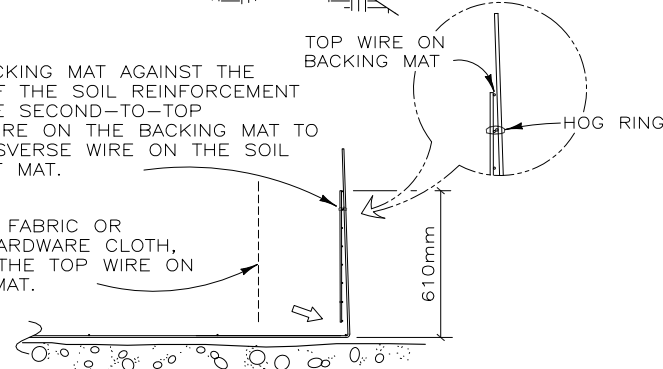

STEP 2
PLACE THE BACKING MAT AGAINST THE INSIDE FACE OF THE SOIL REINFORCEMENT MAT. CLIP THE SECOND-TO-TOP TRANSVERSE WIRE ON THE BACKING MAT TO THE TOP TRANSVERSE WIRE ON THE SOIL REINFORCEMENT MAT.

INSTALL FILTER FABRIC OR CONTINUOUS HARDWARE CLOTH, HOG-RING TO THE TOP WIRE ON THE BACKING MAT.



STEP 3
PLACE AND COMPACT THE BACKFILL IN LAYERS AND DENSITIES AS SPECIFIED IN THE PROJECT PLANS. LEAVE A VOID AT THE FACE AS SHOWN.

PLACE THE SECOND COURSE OF SOIL REINFORCEMENT MATS WITH THE BASE LONGITUDINAL WIRES RESTING ON THE TOP TRANSVERSE WIRE OF THE BACKING MAT BELOW. SLIDE THE SOIL REINFORCEMENT MAT INTO ALIGNMENT.

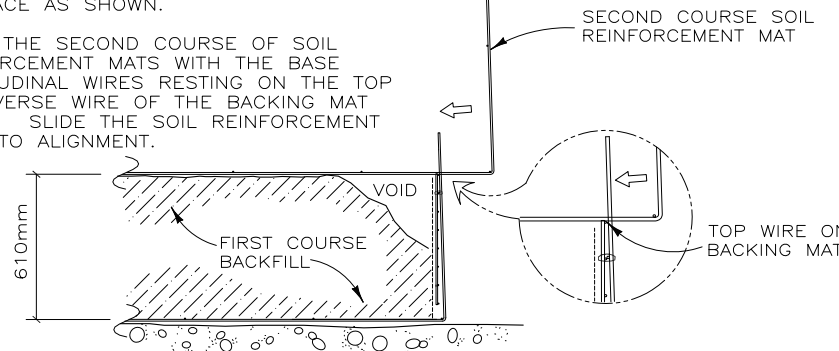

STEP 4
HOOK THE BOTTOM TRANSVERSE WIRE OF THE BACKING MAT OVER THE VERTICAL PRONGS ON THE LOWER MAT. ROTATE THE BACKING MAT TO VERTICAL AND CLIP THE SECOND-TO-TOP TRANSVERSE WIRE ON THE BACKING MAT TO THE TOP WIRE ON THE SOIL REINFORCEMENT MAT.

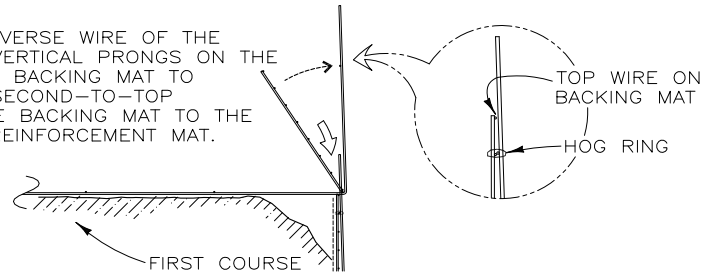

STEP 5
INSTALL THE FILTER FABRIC OR CONTINUOUS HARDWARE CLOTH. PLACE AND COMPACT THE BACKFILL TO THE BASE ELEVATION OF THE NEXT MAT. REPEAT STEPS 3 THROUGH 5 TO THE TOP LIFT.



STEP 6: TOP LIFT
PLACE THE TOP LIFT PRONGLESS MAT, BACKING MAT AND FILTER FABRIC OR CONTINUOUS HARDWARE CLOTH. PLACE AND COMPACT BACKFILL IN AREA "A". HOOK THE CAP OVER THE MIDDLE TRANSVERSE WIRE ON THE PRONGLESS MAT, AND ROTATE INTO PLACE. BACKFILL "B" TO 457mm (1'-6") MIN. COVER OVER THE CAP.

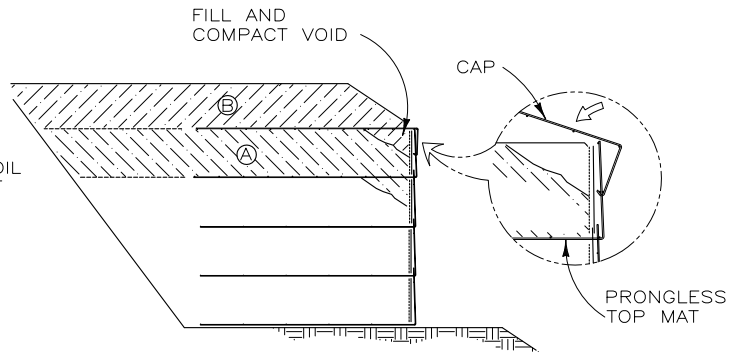

CONSTRUCTION SEQUENCE
NOT TO SCALE

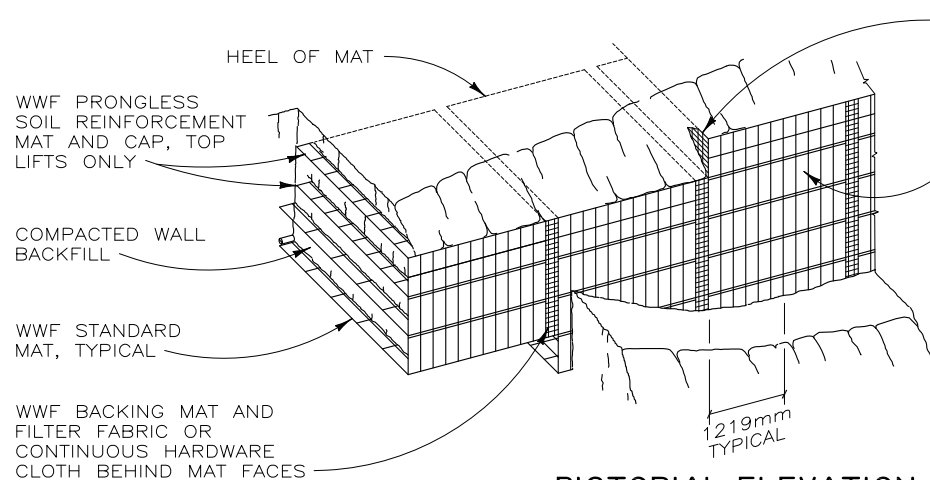

PICTORIAL ELEVATION
NOT TO SCALE

NOTES:

1. THESE DETAILS ARE INTENDED FOR INFORMATION ONLY. THEY MAY OR MAY NOT APPLY TO SPECIFIC PROJECTS.
2. THESE DETAILS SHOW HARDWARE CLOTH USED BEHIND THE BACKING MATS. IN SOME APPLICATIONS, FILTER FABRIC WILL BE REQUIRED INSTEAD OF HARDWARE CLOTH.
3. WWF = WELDED WIRE FABRIC

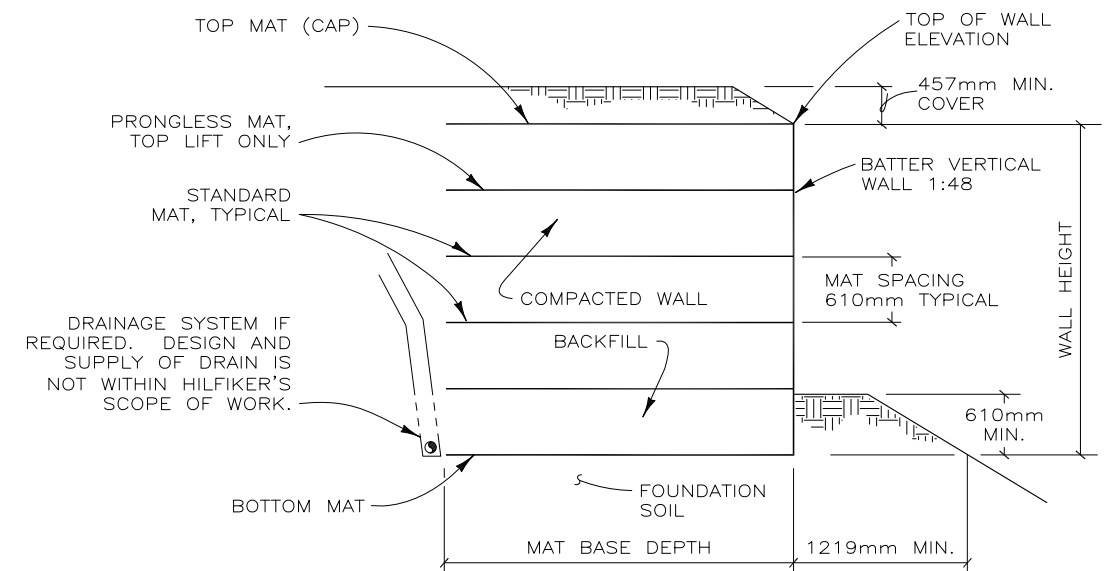
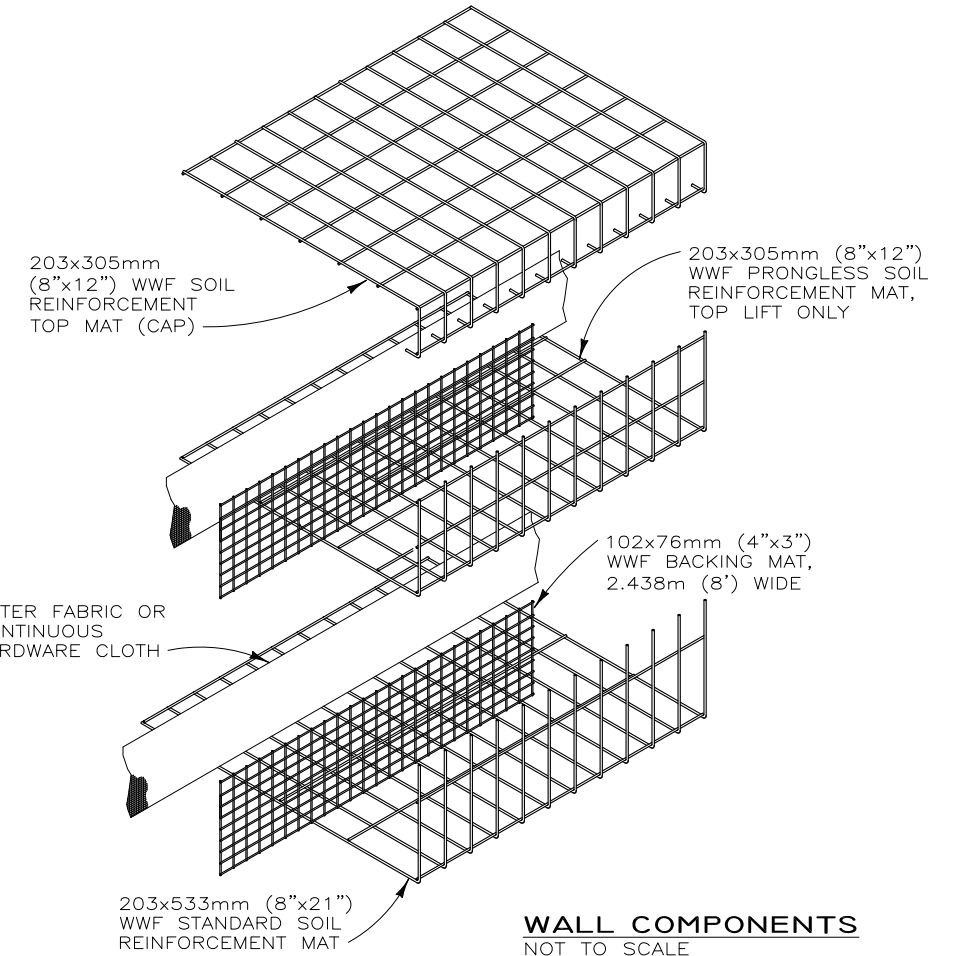

TYPICAL SECTION
NOT TO SCALE

METRIC WWW/8' WIDE MATS

THIS DRAWING IS FURNISHED SOLELY FOR THE USE OF OR IN CONNECTION WITH THIS PROJECT, AND THE PROPRIETARY INFORMATION SHOWN HEREON IS NOT TO BE TRANSMITTED TO ANY OTHER ORGANIZATION WITHOUT SPECIFIC AUTHORIZATION BY THE HILFIKER COMPANY. HILFIKER RETAINING WALLS ARE PROTECTED BY ONE OR MORE OF THE FOLLOWING PATENTS: 243,613, 243,697, 288,616, 4,117,686, 4,329,089, 4,324,508, 4,391,557, 4,505,621, 4,643,818, 4,661,023, 4,856,939, 5,076,735, 5,647,695, 5,722,799, 6,357,970 AND OTHERS. OTHER PATENTS PENDING (2004)

REV.NO.	DATE	BY	DESCRIPTION
1	6 JAN 03	DR	MINOR REVISIONS
2	9 JUL 08	AMJ	UPDATED BORDER, MINOR REVISIONS

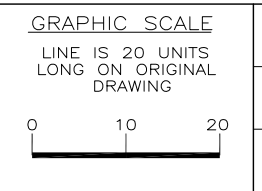

PROJ.MGR. --
ENGINEER
CADD BY HRW

HILFIKER RETAINING WALLS

1902 Hilfiker Lane
Eureka, CA 95503-5711
TOLL-FREE 800.762.8962
PH 707.443.5093 FAX 707.443.2891
WEB SITE www.hilfiker.com E-MAIL info@hilfiker.com

DWG DATE NOV 98
REVISION DATE 9 JUL 08
SCALE NOTED

STANDARD DRAWING
WELDED WIRE RETAINING WALL
610mm (2') LIFTS
STANDARD DETAILS

PROJECT NO. --
SHEET 1 OF 3

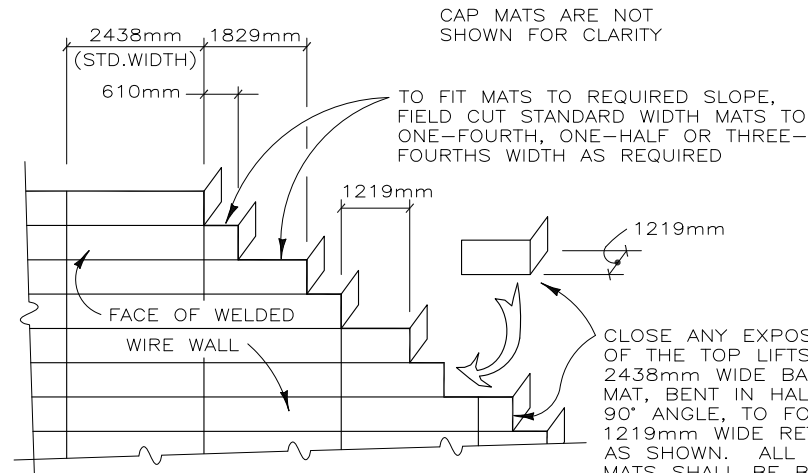

PICTORIAL ELEVATION
PARTIAL TOP MAT DETAILS
NOT TO SCALE

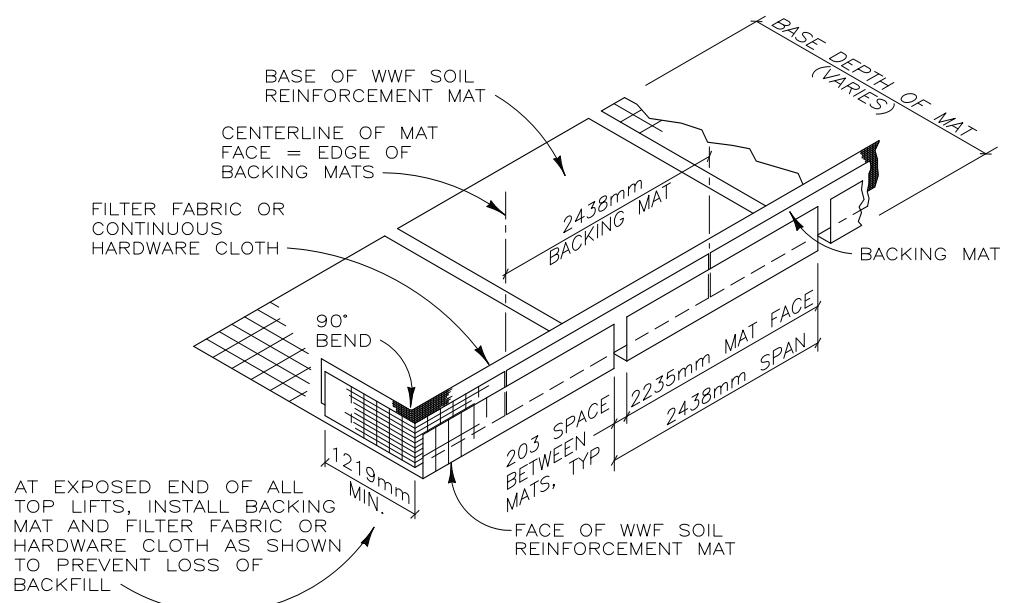

ISOMETRIC VIEW
WELDED WIRE WALL COMPONENTS WITH RETURN MAT
NOT TO SCALE

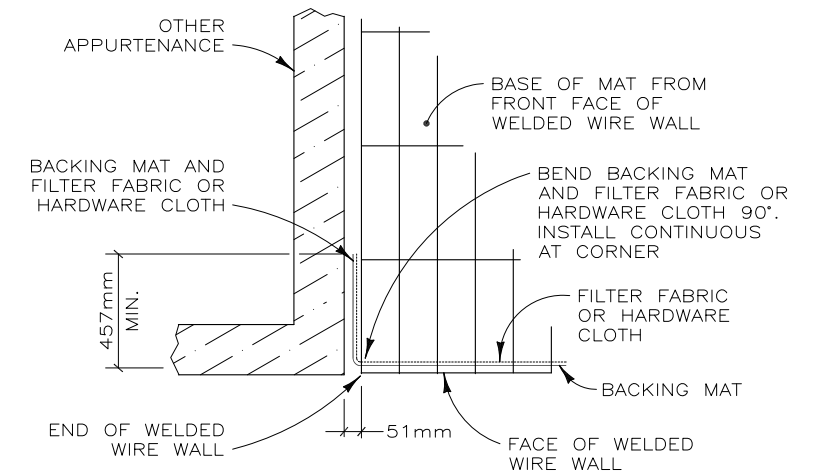

PLAN VIEW
WELDED WIRE WALL END AT OTHER APPURTENANCE
NOT TO SCALE

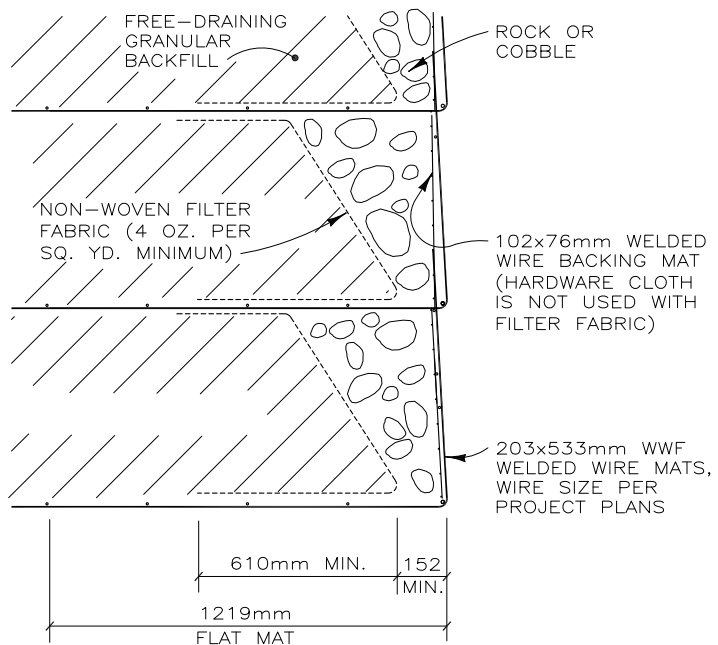

SECTION
ROCK FACING DETAIL
NOT TO SCALE

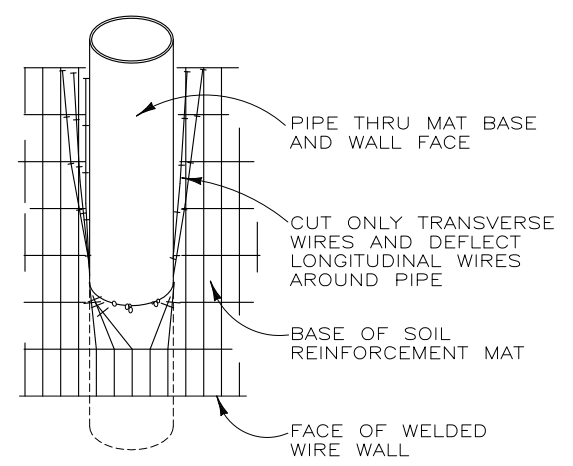

PLAN VIEW
ANGLED PIPE PENETRATION
NOT TO SCALE

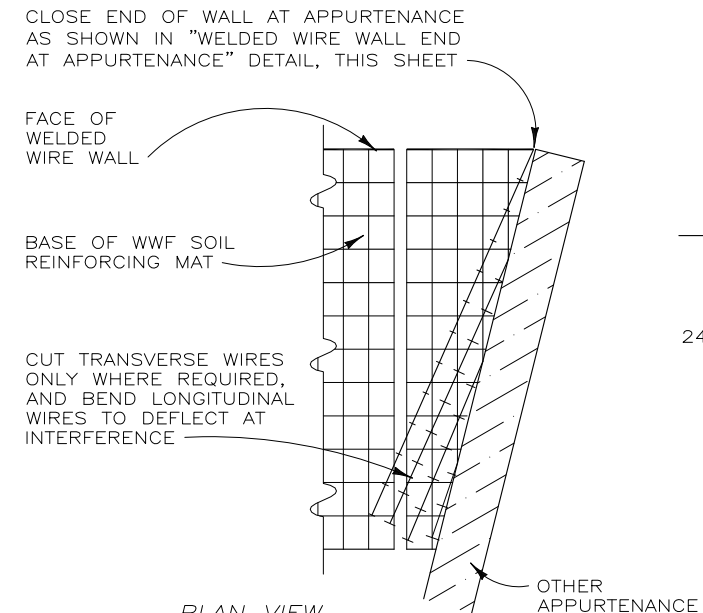

PLAN VIEW
DEFLECTED LONGITUDINAL WIRES
NOT TO SCALE

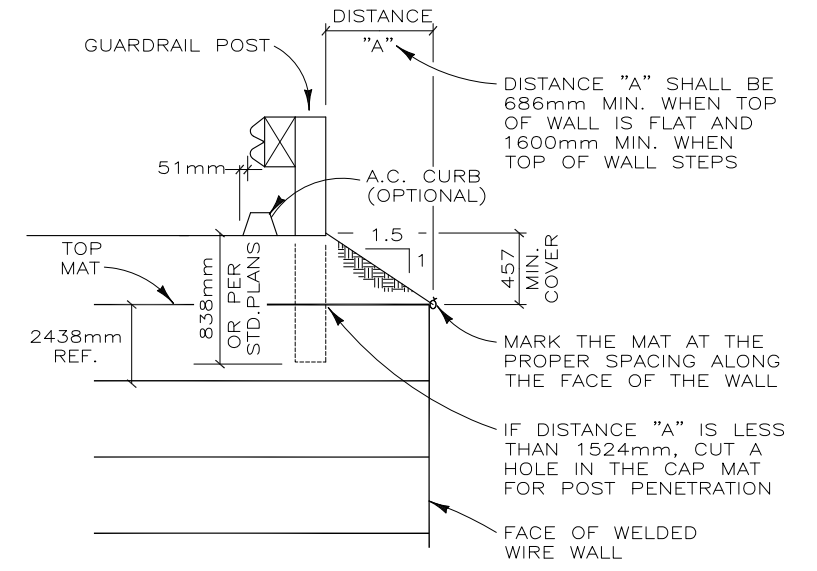

SECTION
GUARDRAIL DETAIL
NOT TO SCALE
(FENCE DETAIL SIMILAR)

METRIC WWW/8' WIDE MATS

THIS DRAWING IS FURNISHED SOLELY FOR THE USE OF OR IN CONNECTION WITH THIS PROJECT, AND THE PROPRIETARY INFORMATION SHOWN HEREON IS NOT TO BE TRANSMITTED TO ANY OTHER ORGANIZATION WITHOUT SPECIFIC AUTHORIZATION BY THE HILFIKER COMPANY. HILFIKER RETAINING WALLS ARE PROTECTED BY ONE OR MORE OF THE FOLLOWING PATENTS: 243,613, 243,697, 288,616, 4,117,686, 4,329,089, 4,324,508, 4,391,557, 4,505,621, 4,643,818, 4,661,023, 4,856,939, 5,076,735, 5,647,695, 5,722,799, 6,357,970 AND OTHERS. OTHER PATENTS PENDING (2004)

REV.NO.	DATE	BY	DESCRIPTION
1	6 JAN 03	DR	MINOR REVISIONS
2	9 JUL 08	AMJ	UPDATED BORDER, MINOR REVISIONS

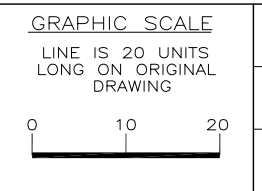

PROJ.MGR. --
ENGINEER
CADD BY HRW

HILFIKER RETAINING WALLS

1902 Hilfiker Lane
Eureka, CA 95503-5711
TOLL-FREE 800.762.8962
PH 707.443.5093 FAX 707.443.2891
WEB SITE www.hilfiker.com E-MAIL info@hilfiker.com

DWG DATE NOV 98
REVISION DATE 9 JUL 08
SCALE NOTED

STANDARD DRAWING
WELDED WIRE RETAINING WALL
610mm (2') LIFTS
STANDARD DETAILS

PROJECT NO. --
SHEET **2** OF 3

STEP 4

PLACE AND COMPACT THE BACKFILL OVER THE SLOPED CAPS TO FINAL GRADE

STEP 2

PLACE CAPS ON SLOPE

STEP 1

CUT OFF THE TOP OF THE MAT FACES, BACKING MATS, AND FABRIC PARALLEL TO FINAL GRADE

STEP 3

CLIP CAPS TO MAT FACES WITH HOG RINGS

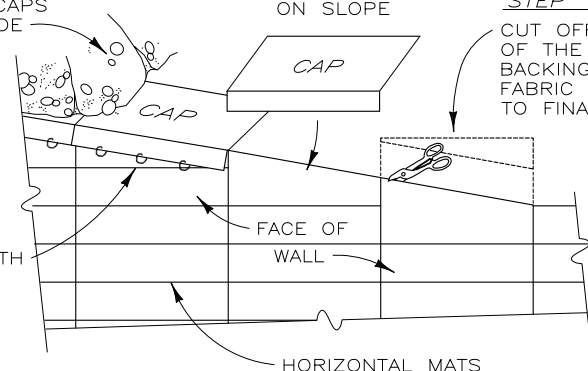

SLOPED CAP MAT DETAIL
NOT TO SCALE

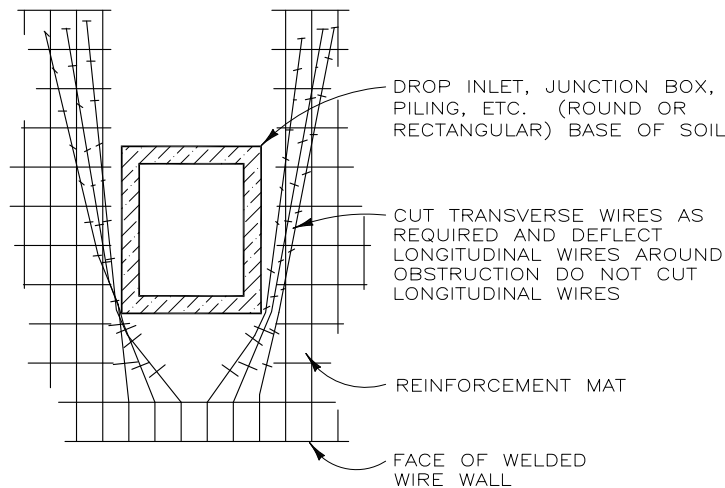

MAT PENETRATION DETAIL
NOT TO SCALE

FOR A SMOOTHER CURVE, SPLIT THE MAT BASES AND BEND THE FACES. DO NOT SPLIT MAT FACES OR CUT LONGITUDINAL WIRES

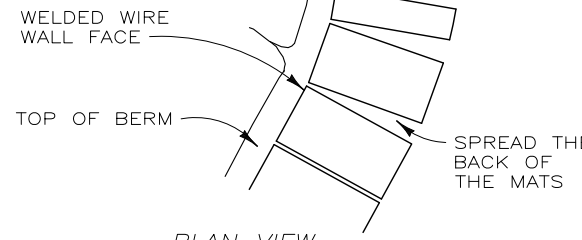

CONCAVE CURVE
NOT TO SCALE

FOR A SMOOTHER CURVE SPLIT THE MAT BASES AND BEND THE FACES. DO NOT SPLIT MAT FACES OR CUT LONGITUDINAL WIRES

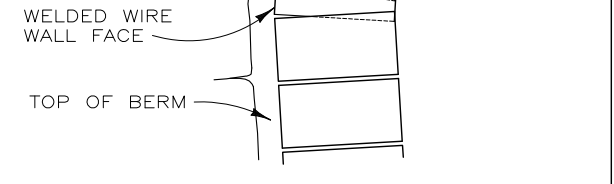

CONVEX CURVE
NOT TO SCALE

AT THE UPPER SURFACE OF THE CULVERT, CUT THE TRANSVERSE WIRES ONLY. BEND AND LIFT THE LONGITUDINAL WIRES IN THE BASE OF THE MAT TO FIT AGAINST THE SIDE OF THE CULVERT

ANY LARGE GAP AT THE TOP OF THE CULVERT MAY BE CLOSED WITH BACKING MAT AND HARDWARE CLOTH, CUT TO FIT, OR USE LARGER ROCKS OR SACKED CONCRETE

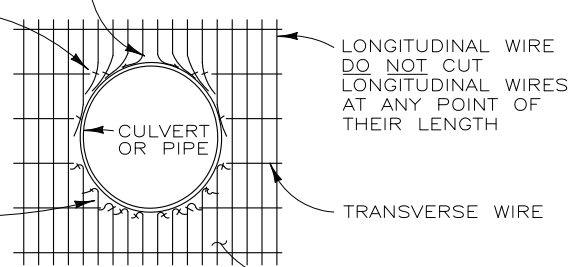

CULVERT THRU WALL FACE
NOT TO SCALE

AT THE LOWER SURFACE OF THE CULVERT, CUT THE TRANSVERSE WIRES ONLY IN THE MAT FACE. BEND THE LONGITUDINAL WIRES BACK TO FIT AGAINST THE CURVE OF THE CULVERT

NOTE: BACKING MATS AND FILTER FABRIC OR HARDWARE CLOTH (NOT SHOWN) ARE TO BE CUT OFF FLUSH WITH THE SIDES OF THE CULVERT

ELEVATION

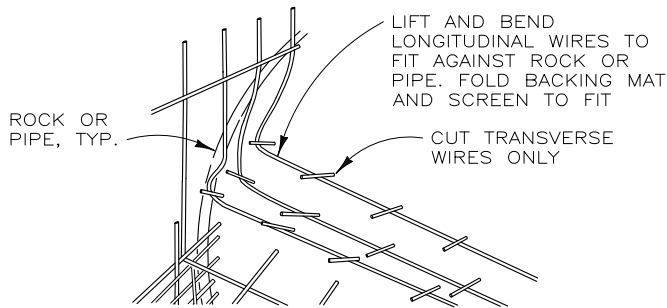

FITTING MATS TO OBSTRUCTION
NOT TO SCALE

CUT OFF THE TRANSVERSE AND LONGITUDINAL WIRES WHERE THEY INTERFERE WITH THE FACE OF THE ADJACENT WALL

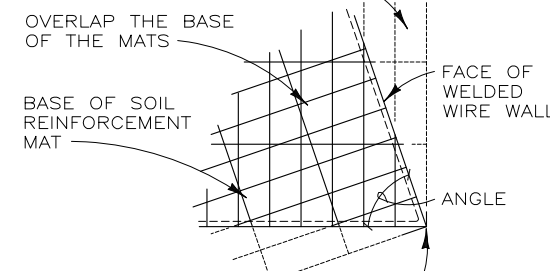

ACUTE CONVEX ANGLE
NOT TO SCALE

CUT THE TRANSVERSE WIRES ON THE BASE OF THE MATS AND BEND THE FACE OF THE MATS TO THE REQUIRED ANGLE. OVERLAP THE BASE OF THE MATS.

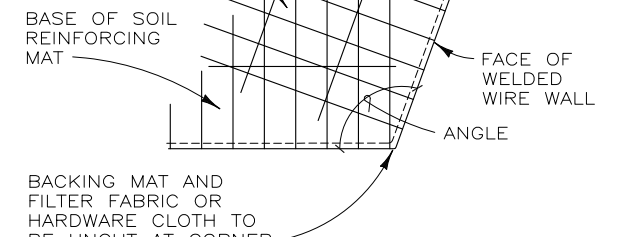

OBTUSE CONVEX ANGLE
NOT TO SCALE

BACKING MAT AND FILTER FABRIC OR HARDWARE CLOTH TO BE UNCUT AT CORNER

OVERLAP THE BASE OF THE MATS

ACUTE CONVEX ANGLE
NOT TO SCALE

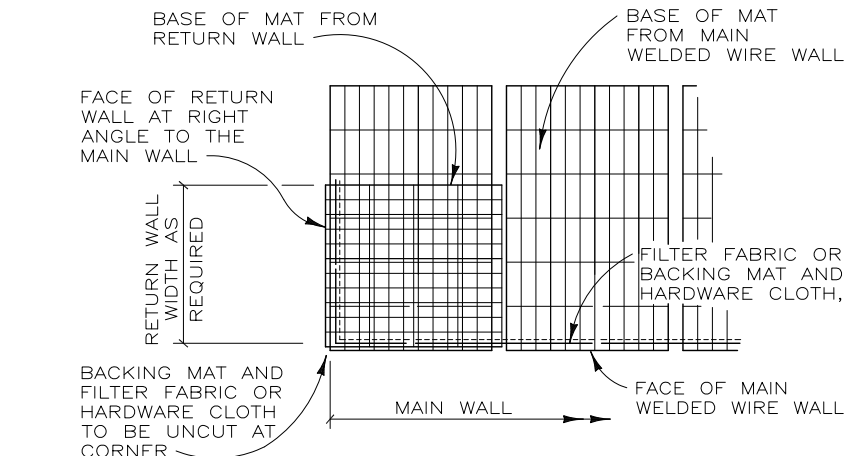

RETURN WALL DETAIL
NOT TO SCALE

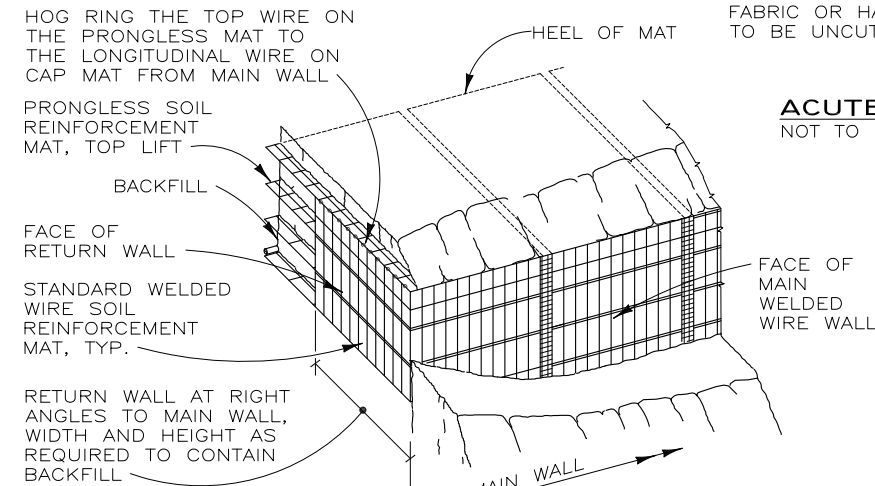

RETURN WALL DETAIL
NOT TO SCALE

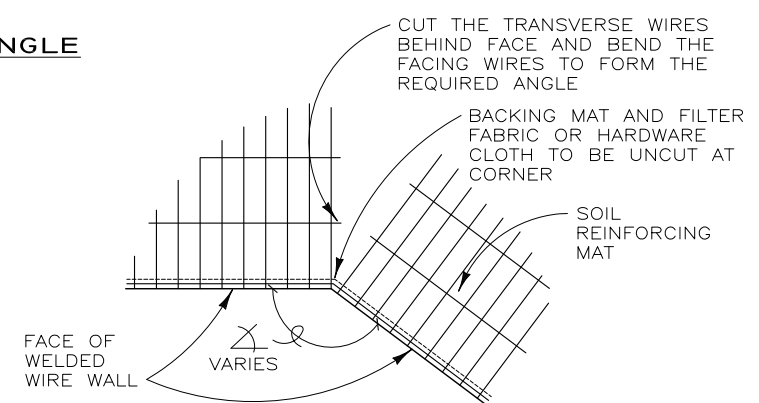

CONCAVE ANGLE DETAIL
NOT TO SCALE

METRIC 3000/8' WIDE MATS

THIS DRAWING IS FURNISHED SOLELY FOR THE USE OF OR IN CONNECTION WITH THIS PROJECT, AND THE PROPRIETARY INFORMATION SHOWN HEREON IS NOT TO BE TRANSMITTED TO ANY OTHER ORGANIZATION WITHOUT SPECIFIC AUTHORIZATION BY THE HILFIKER COMPANY. HILFIKER RETAINING WALLS ARE PROTECTED BY ONE OR MORE OF THE FOLLOWING PATENTS: 243,613, 243,697, 288,616, 4,117,686, 4,329,089, 4,324,508, 4,391,557, 4,505,621, 4,643,818, 4,661,023, 4,896,639, 5,076,735, 5,647,695, 5,722,799, 6,357,970 AND OTHERS. OTHER PATENTS PENDING (2004)

REV. NO.	DATE	BY	DESCRIPTION
1	6 JAN 03	DR	MINOR REVISIONS
2	9 JUL 08	AMJ	UPDATED BORDER, MINOR REVISIONS

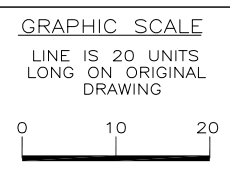

PROJ. MGR. --
ENGINEER --
CADD BY HRW

HILFIKER RETAINING WALLS

HW

1902 Hilfiker Lane
Eureka, CA 95503-5711
TOLL-FREE 800.762.8962
PH 707.443.5093 FAX 707.443.2891
WEBSITE www.hilfiker.com E-MAIL info@hilfiker.com

1902
QUALITY WALLS

DWG DATE NOV 98
REVISION DATE 9 JUL 08
SCALE NOTED

STANDARD DRAWING

WELDED WIRE RETAINING WALL

610mm (2') LIFTS

STANDARD DETAILS

PROJECT NO. --
SHEET **3** OF 3