

150113AF NBU COMAL SPRINGS CONSERVATION CENTER

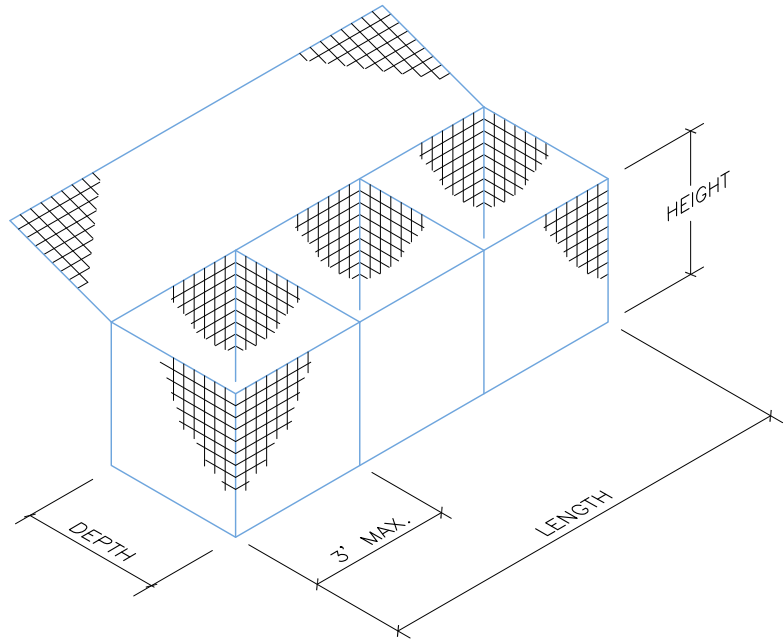

TYPICAL GABION  
NOT TO SCALE

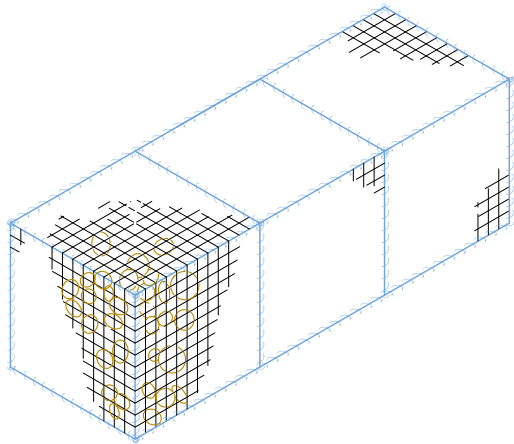

TYPICAL ASSEMBLED GABION  
NOT TO SCALE

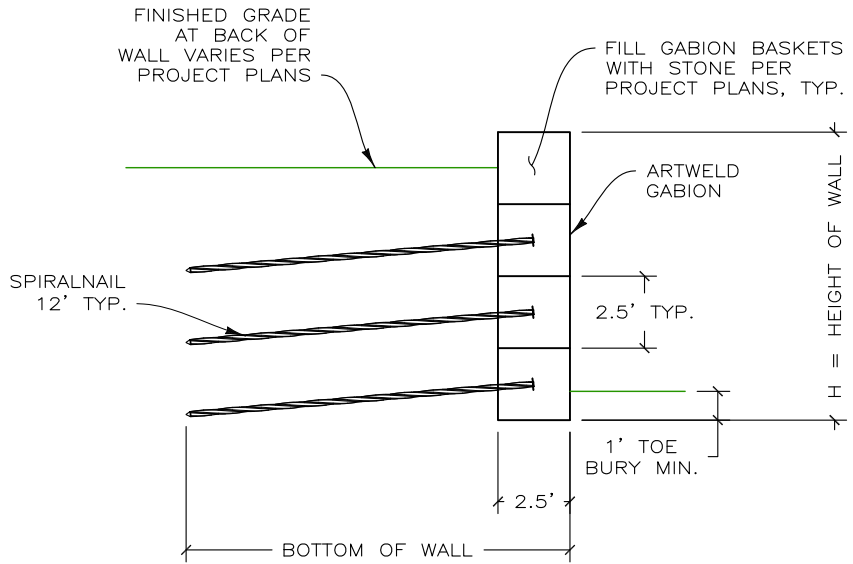

TYPICAL SECTION  
SCALE: 3" = 20'

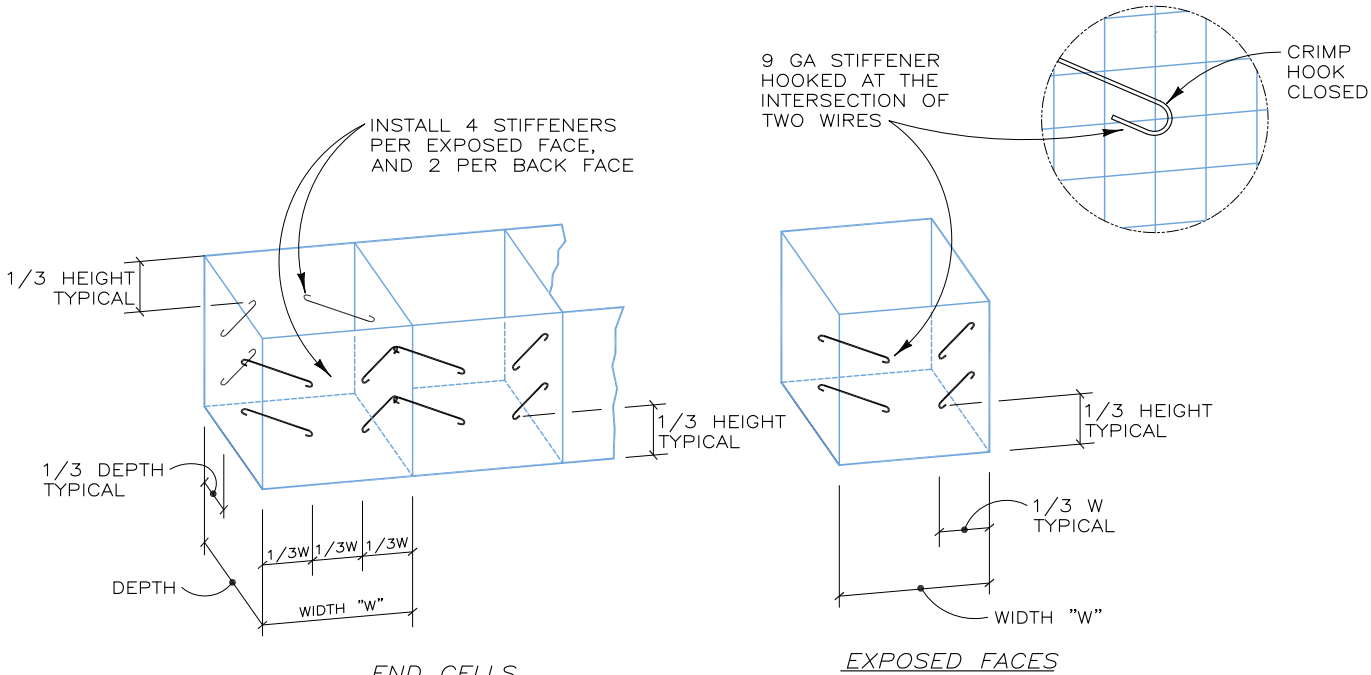

WHERE HEIGHT OF GABION IS 18" OR LESS, INSTALL 2 STIFFENERS PER FACE  
WHERE HEIGHT IS 12", NO STIFFENERS REQUIRED

STIFFENER DETAILS  
NOT TO SCALE

ESTIMATED QUANTITIES

WALL	FACE AREA
COMAL SPRINGS WALL COMPLEX	1,688 SQ. FT.
BLIEDERS CREEK WALL COMPLEX	4,530 SQ. FT.
TANK OVERFLOW DISSIPATION BASIN	396 SQ. FT.
NARROW CURB WALL	325 SQ. FT.
TOTALS	6,939 SQ. FT.

PROJECT-SPECIFIC NOTES:

- REFERENCE DRAWINGS: BASED ON LAKE/FLATO PLANS, PHASE 1 PERMIT SET FOR NBU COMAL SPRINGS CONSERVATION CENTER. SHEETS L205, L206, L302, L305, L306, L413 AND L416 THROUGH L419.
- BLACK AND WHITE REPRODUCTION OF THIS COLOR ORIGINAL MAY REDUCE ITS EFFECTIVENESS AND LEAD TO INCORRECT INTERPRETATION.
- IT IS ASSUMED THAT ALL MATERIALS, BACKFILL AND CONSTRUCTION METHODS FOR HILFIKER M.S.E. WALLS AND/OR GABIONS WILL CONFORM TO HILFIKER'S SPECIFICATIONS AND/OR THOSE OF THE HILFIKER ENGINEERING CONSULTANT.
- THIS IS NOT AN ENGINEERED SUBMITTAL. ALL INFORMATION HEREON IS DERIVED FROM THE REFERENCE DRAWINGS, AND IS SUBJECT TO GEOMETRIC AND GEOTECHNICAL CONFIRMATION. THE APPLICABLE HILFIKER CONSTRUCTION GUIDE AND SPECIFICATIONS ARE AN INTEGRAL PART OF THIS SUBMITTAL.
- UPON ENGINEERED DESIGN, HILFIKER RETAINING WALLS SHALL BE RESPONSIBLE ONLY FOR THE INTERNAL STABILITY OF THE RETAINING WALL, AND NOT FOR GLOBAL STABILITY OR FOUNDATION BEARING CAPACITY. THE OWNER/CONTRACTOR SHALL BE RESPONSIBLE FOR ALL JOB SITE DRAINAGE, SAFETY AND FALL PROTECTION PROVISIONS FOR WORKERS IN COMPLIANCE WITH OSHA AND ANY OTHER APPLICABLE REQUIREMENTS.
- WALL DESIGN SHALL REQUIRE A NON-SATURATED BACKFILL. SURFACE AND SUBSURFACE DRAINAGE CONTROL MAY BE REQUIRED TO PREVENT SATURATION OF THE BACKFILL OR TO RELIEVE HYDROSTATIC PRESSURES. DRAINAGE CONTROL SHALL BE AS SPECIFIED IN THE OWNER'S PROJECT PLANS AND SPECIFICATIONS, OR AS DIRECTED BY THE OWNER'S ENGINEER.

BID DUE: 6 JUN 16

THIS DRAWING IS FURNISHED SOLELY FOR THE USE OF OR IN CONNECTION WITH THIS PROJECT AND THE PROPRIETARY INFORMATION SHOWN HEREON IS NOT TO BE TRANSMITTED TO ANY OTHER ORGANIZATION WITHOUT SPECIFIC AUTHORIZATION BY THE HILFIKER COMPANY. HILFIKER RETAINING WALLS ARE PROTECTED BY ONE OR MORE OF THE FOLLOWING PATENTS: 243,613; 243,697; 288,616; 4,117,686; 4,329,089; 4,324,508; 4,391,557; 4,505,621; 4,343,318; 4,661,023; 4,856,939; 4,929,125; 5,076,735; 5,647,695; 5,722,799; 5,733,072; 6,357,970B1; 6,874,975B2; 7,033,118B2; AND OTHERS. OTHER PATENTS PENDING (2008)

REV.NO.	DATE	BY	DESCRIPTION
1	6 JUN 16	AMJ	BASED ON PHASE 1 PERMIT SET 5-11-16

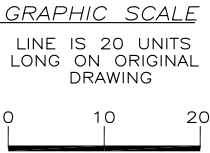

PROJ. MGR.
BH
ENGINEER
CADD BY
AMJ

**HILFIKER RETAINING WALLS**

1902 Hilfiker Lane  
Eureka, CA 95503-5711  
TOLL-FREE 800.762.8962  
PH 707.443.5093 FAX 707.443.2891  
WEBSITE www.hilfiker.com E-MAIL info@hilfiker.com

DWG DATE
26 JAN 15
REVISION DATE
6 JUN 16
SCALE
NOTED

**FOR BIDDING PURPOSES ONLY**

GABION FACED M.S.E. WITH SPIRALNAILS  
**NBU COMAL SPRINGS CONSERVATION CENTER**  
NEW BRAUNFELS, TEXAS

DETAILS AND NOTES

PROJECT NO.
150113AF
SHEET
1
OF 5

150113AF NBU COMAL SPRINGS CONSERVATION CENTER

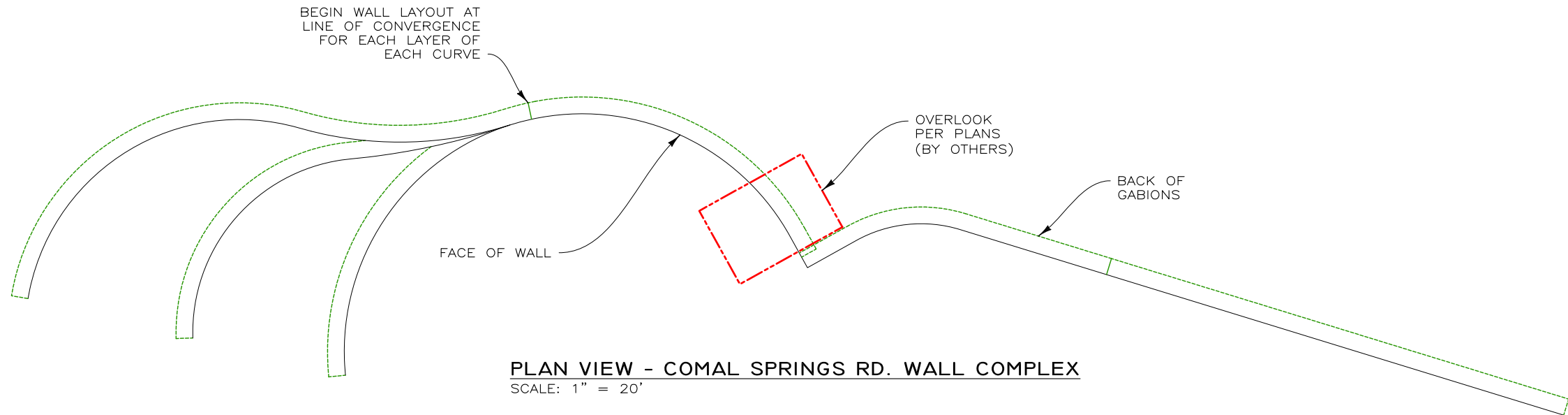

PLAN VIEW - COMAL SPRINGS RD. WALL COMPLEX  
SCALE: 1" = 20'

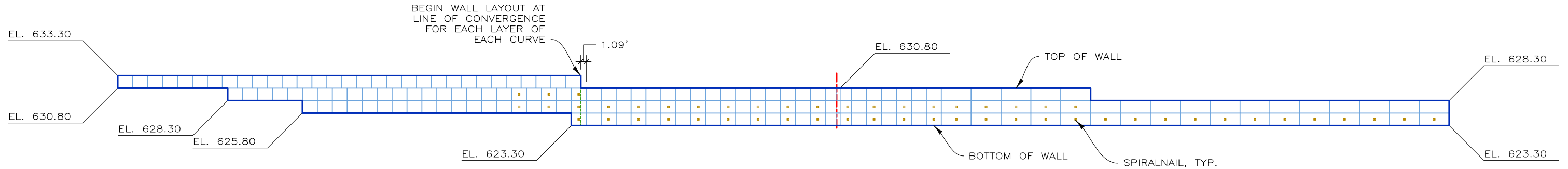

DEVELOPED ELEVATION - COMAL SPRINGS RD. WALL COMPLEX  
SCALE: 1" = 20'

THIS DRAWING IS FURNISHED SOLELY FOR THE USE OF OR IN CONNECTION WITH THIS PROJECT AND THE PROPRIETARY INFORMATION SHOWN HEREON IS NOT TO BE TRANSMITTED TO ANY OTHER ORGANIZATION WITHOUT SPECIFIC AUTHORIZATION BY THE HILFIKER COMPANY. HILFIKER RETAINING WALLS ARE PROTECTED BY ONE OR MORE OF THE FOLLOWING PATENTS: 243,613; 243,697; 288,616; 4,117,686; 4,329,089; 4,324,508; 4,391,557; 4,505,621; 4,343,318; 4,661,023; 4,856,939; 4,929,125; 5,076,735; 5,647,695; 5,722,799; 5,733,072; 6,357,970B1; 6,874,975B2; 7,033,118B2; AND OTHERS. OTHER PATENTS PENDING (2008)

REV.NO.	DATE	BY	DESCRIPTION
1	6 JUN 16	AMJ	BASED ON PHASE 1 PERMIT SET 5-11-16

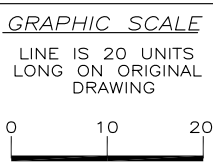

PROJ. MGR.
BH
ENGINEER
CADD BY
AMJ

**HILFIKER RETAINING WALLS**

1902 Hilfiker Lane  
Eureka, CA 95503-5711  
TOLL-FREE 800.762.8962  
PH 707.443.5093 FAX 707.443.2891  
WEBSITE www.hilfiker.com E-MAIL info@hilfiker.com

DWG DATE
26 JAN 15
REVISION DATE
6 JUN 16
SCALE
NOTED

**FOR BIDDING PURPOSES ONLY**

GABION FACED M.S.E. WITH SPIRALNAILS  
**NBU COMAL SPRINGS  
CONSERVATION CENTER**  
NEW BRAUNFELS, TEXAS

COMAL SPRINGS WALL COMPLEX

PROJECT NO.
150113AF
SHEET
2
OF 5

BID DUE: 6 JUN 16

150113AF NBU COMAL SPRINGS CONSERVATION CENTER

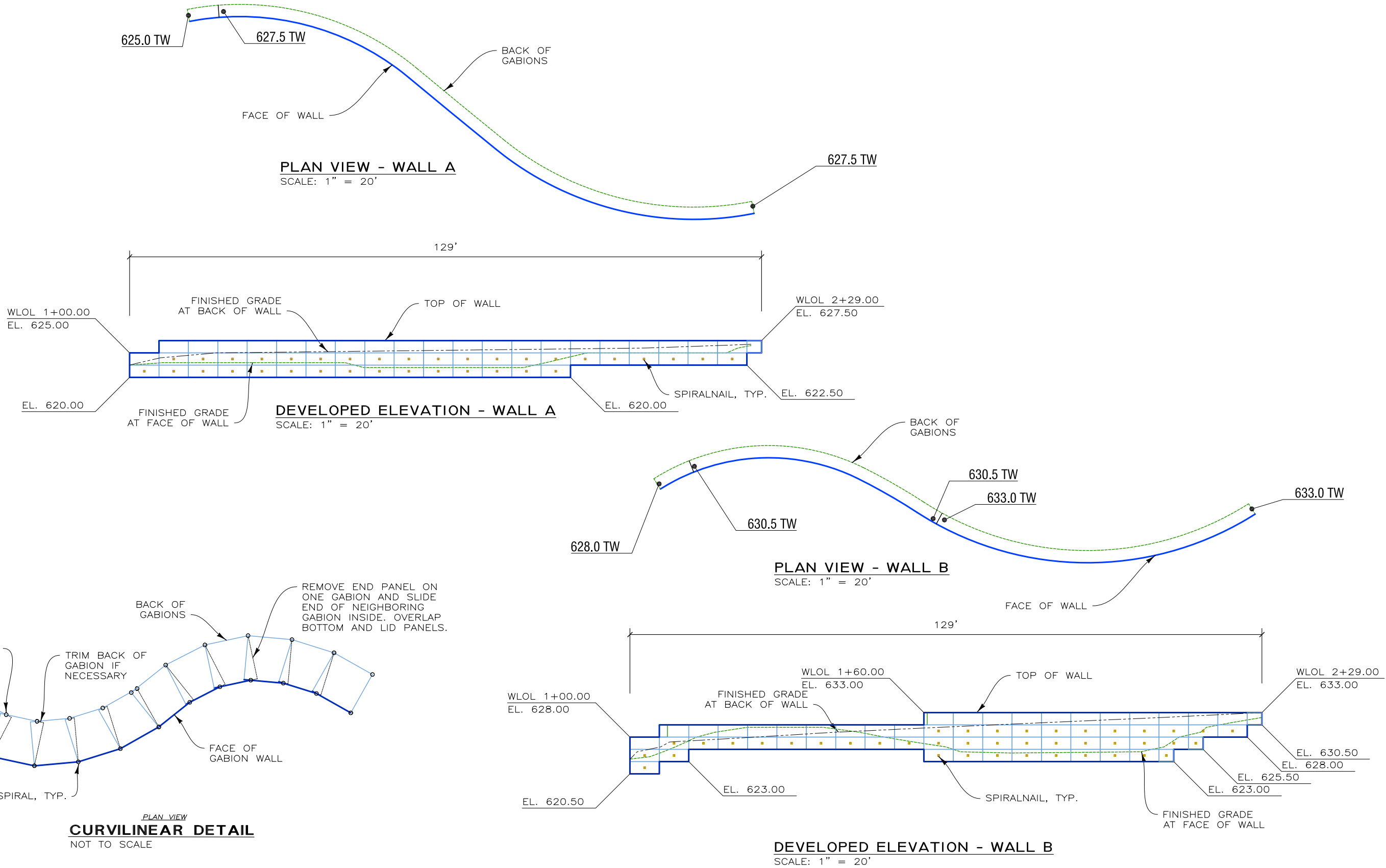

THIS DRAWING IS FURNISHED SOLELY FOR THE USE OF OR IN CONNECTION WITH THIS PROJECT AND THE PROPRIETARY INFORMATION SHOWN HEREON IS NOT TO BE TRANSMITTED TO ANY OTHER ORGANIZATION WITHOUT SPECIFIC AUTHORIZATION BY THE HILFIKER COMPANY. HILFIKER RETAINING WALLS ARE PROTECTED BY ONE OR MORE OF THE FOLLOWING PATENTS: 243,613; 243,697; 288,616; 4,117,686; 4,329,089; 4,324,508; 4,391,557; 4,505,621; 4,343,318; 4,661,023; 4,856,939; 4,929,125; 5,076,735; 5,647,695; 5,722,799; 5,733,072; 6,357,970B1; 6,874,975B2; 7,033,118B2; AND OTHERS. OTHER PATENTS PENDING (2008)

REV.NO.	DATE	BY	DESCRIPTION
1	6 JUN 16	AMJ	BASED ON PHASE 1 PERMIT SET 5-11-16

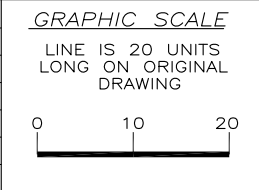

PROJ. MGR. BH
ENGINEER
CADD BY AMJ

**HILFIKER RETAINING WALLS**  

1902 Hilfiker Lane  
Eureka, CA 95503-5711  
TOLL-FREE 800.762.8962  
PH 707.443.5093 FAX 707.443.2891  
WEBSITE www.hilfiker.com E-MAIL info@hilfiker.com



DWG DATE 26 JAN 15
REVISION DATE 6 JUN 16
SCALE NOTED

<b>FOR BIDDING PURPOSES ONLY</b> GABION FACED M.S.E. WITH SPIRALNAILS <b>NBU COMAL SPRINGS CONSERVATION CENTER</b> NEW BRAUNFELS, TEXAS
BLIEDER'S CREEK — WALLS A AND B

PROJECT NO. 150113AF
SHEET <b>3</b> OF 5

BID DUE: 6 JUN 16

150113AF NBU COMAL SPRINGS CONSERVATION CENTER

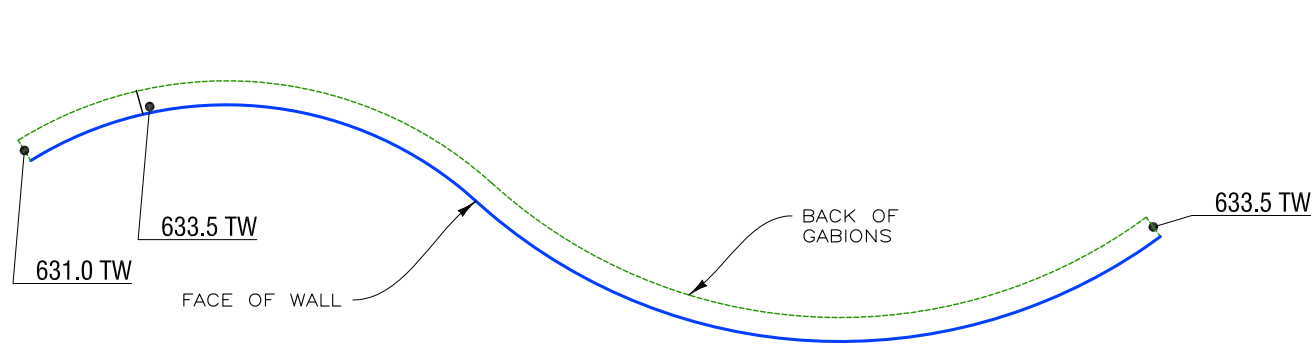

PLAN VIEW - WALL C  
SCALE: 1" = 20'

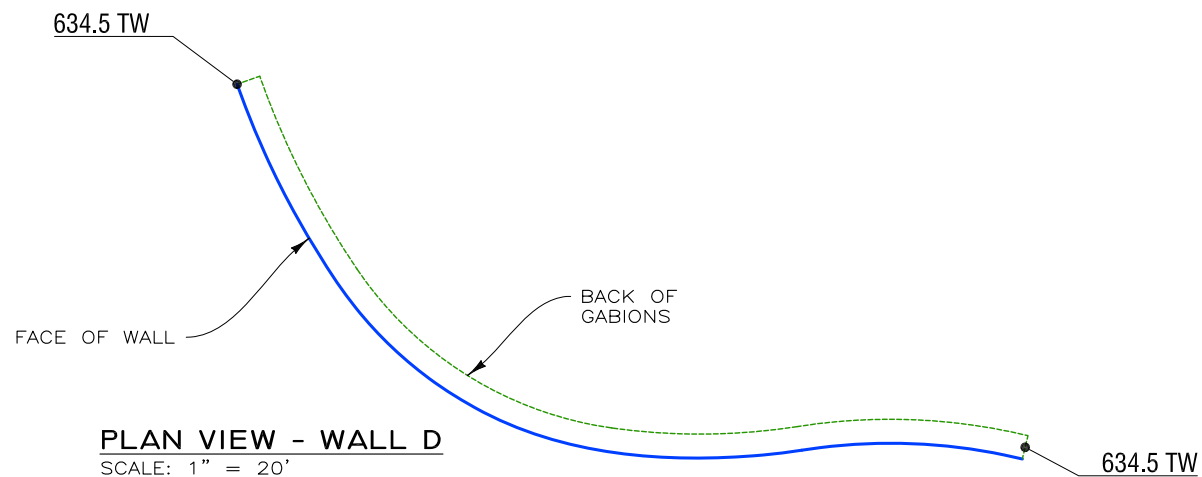

PLAN VIEW - WALL D  
SCALE: 1" = 20'

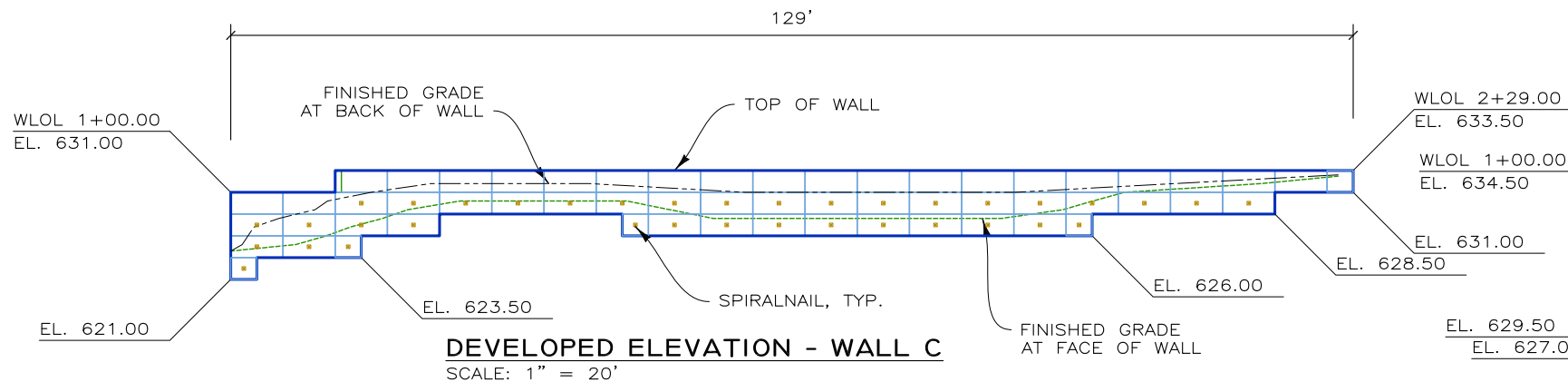

DEVELOPED ELEVATION - WALL C  
SCALE: 1" = 20'

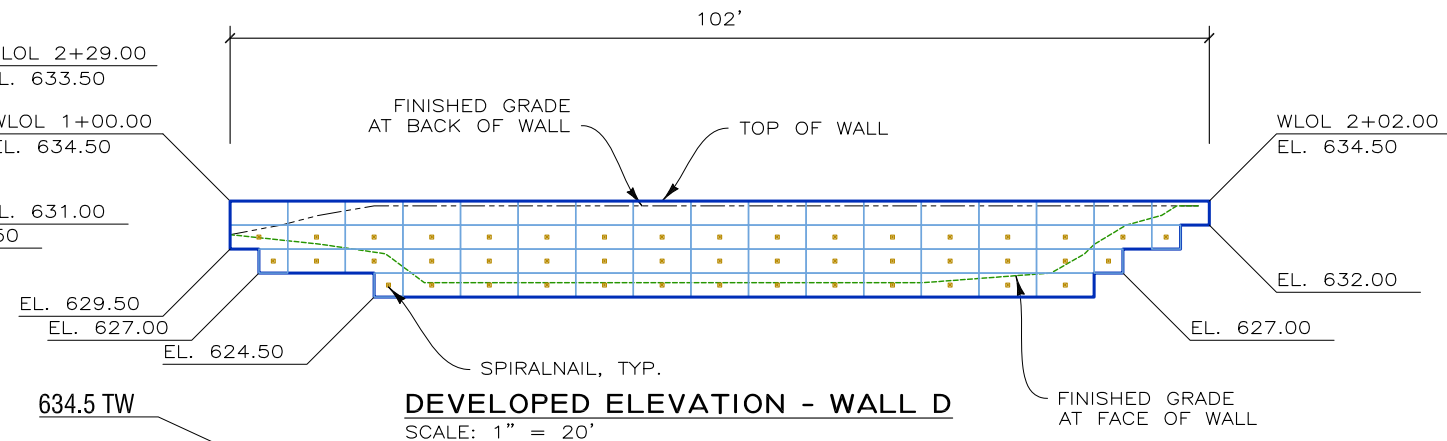

DEVELOPED ELEVATION - WALL D  
SCALE: 1" = 20'

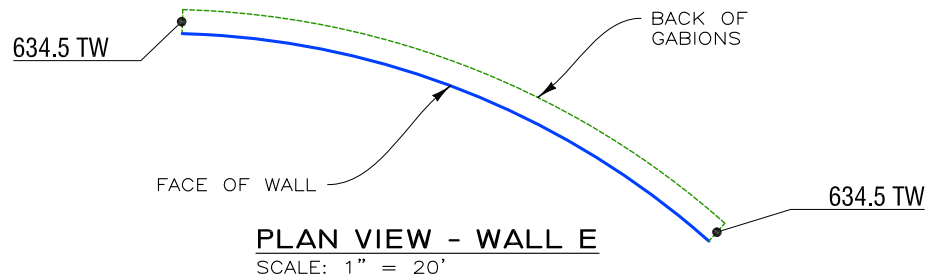

PLAN VIEW - WALL E  
SCALE: 1" = 20'

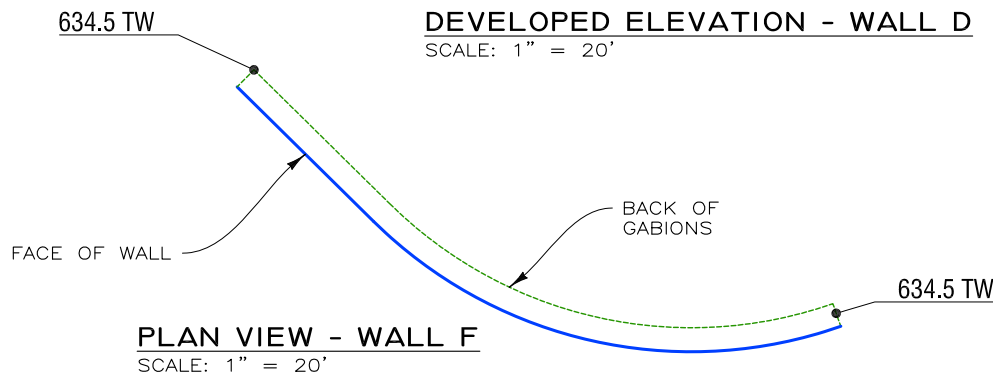

PLAN VIEW - WALL F  
SCALE: 1" = 20'

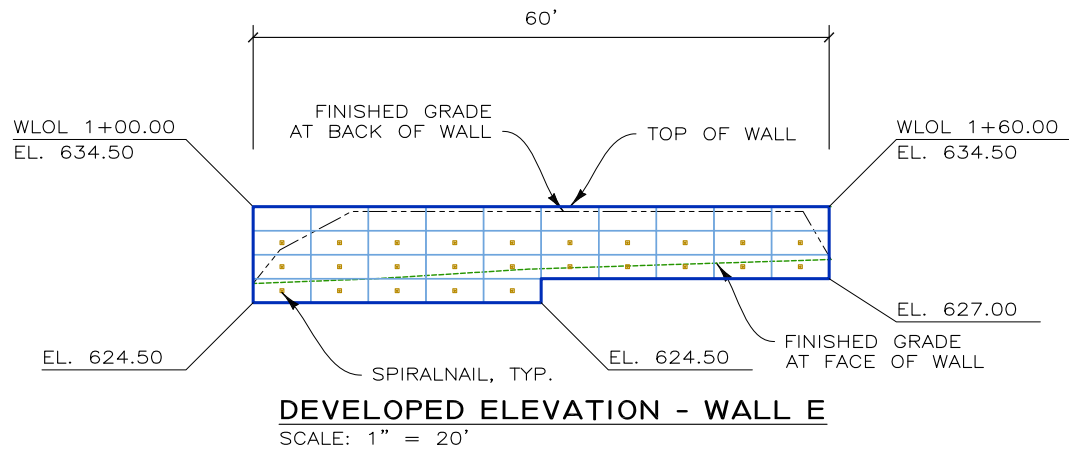

DEVELOPED ELEVATION - WALL E  
SCALE: 1" = 20'

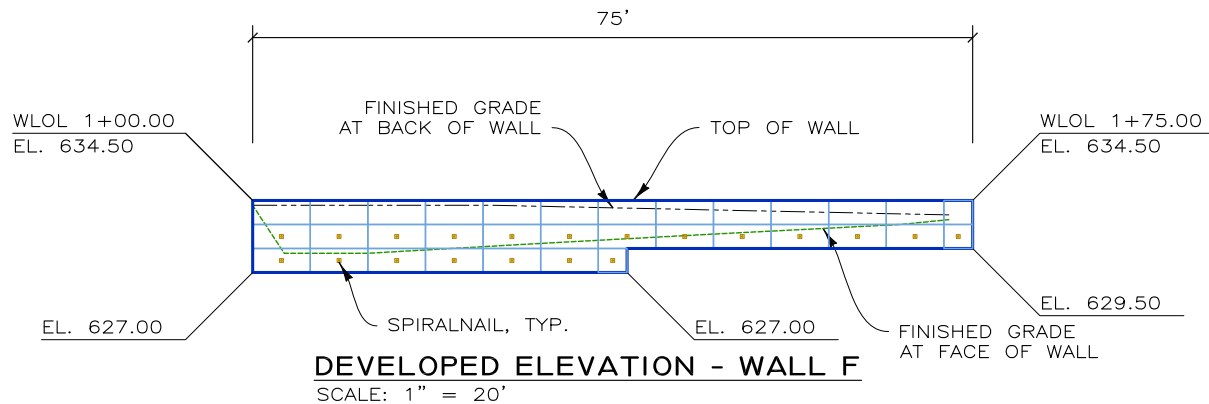

DEVELOPED ELEVATION - WALL F  
SCALE: 1" = 20'

BID DUE: 6 JUN 16

THIS DRAWING IS FURNISHED SOLELY FOR THE USE OF OR IN CONNECTION WITH THIS PROJECT AND THE PROPRIETARY INFORMATION SHOWN HEREON IS NOT TO BE TRANSMITTED TO ANY OTHER ORGANIZATION WITHOUT SPECIFIC AUTHORIZATION BY THE HILFIKER COMPANY. HILFIKER RETAINING WALLS ARE PROTECTED BY ONE OR MORE OF THE FOLLOWING PATENTS: 243,613; 243,697; 288,616; 4,117,686; 4,329,089; 4,324,508; 4,391,557; 4,505,621; 4,343,318; 4,661,023; 4,856,939; 4,929,125; 5,076,735; 5,647,695; 5,722,799; 5,733,072; 6,357,970B1; 6,874,975B2; 7,033,118B2; AND OTHERS. OTHER PATENTS PENDING (2008)

REV.NO.	DATE	BY	DESCRIPTION
1	6 JUN 16	AMJ	BASED ON PHASE 1 PERMIT SET 5-11-16

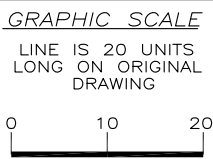

PROJ. MGR.  
BH  
ENGINEER  
CADD BY  
AMJ

**HILFIKER RETAINING WALLS**

1902 Hilfiker Lane  
Eureka, CA 95503-5711  
TOLL-FREE 800.762.8962  
PH 707.443.5093 FAX 707.443.2891  
WEBSITE www.hilfiker.com E-MAIL info@hilfiker.com

DWG DATE  
26 JAN 15  
REVISION DATE  
6 JUN 16  
SCALE  
NOTED

**FOR BIDDING PURPOSES ONLY**  
GABION FACED M.S.E. WITH SPIRALNAILS  
**NBU COMAL SPRINGS CONSERVATION CENTER**  
NEW BRAUNFELS, TEXAS  
BLIEDERS CREEK — WALLS C—F

PROJECT NO.  
150113AF  
SHEET  
**4**  
OF 5

150113AF NBU COMAL SPRINGS CONSERVATION CENTER

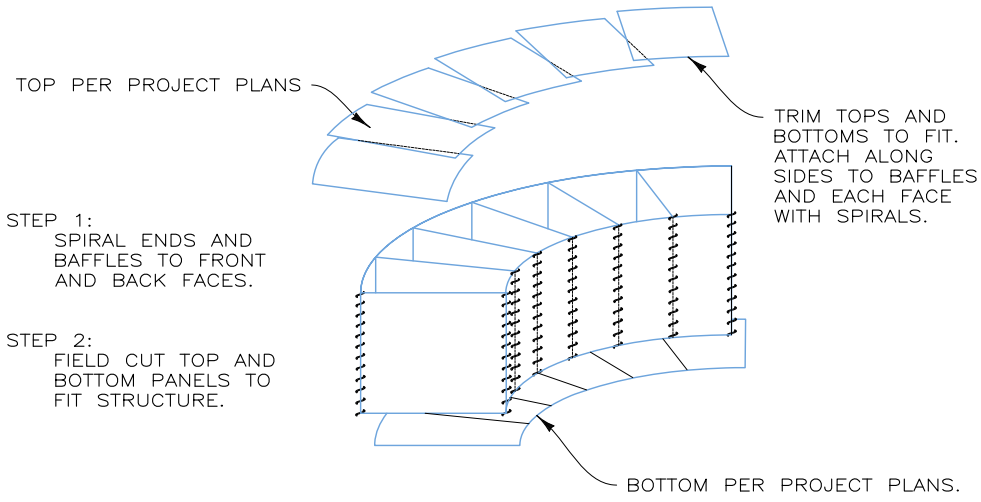

**CURVED GABION ASSEMBLY**  
NOT TO SCALE

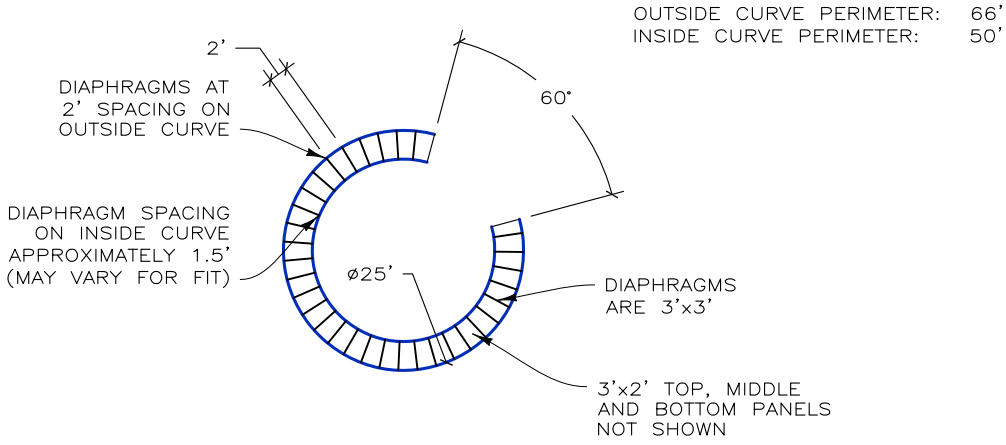
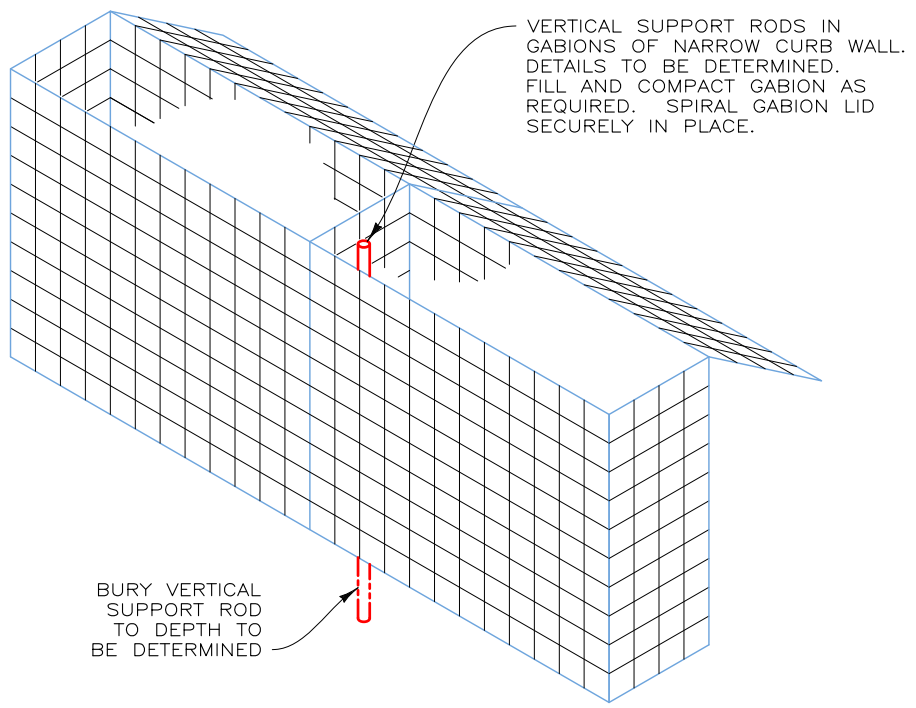

**PLAN VIEW - TANK OVERFLOW DISSIPATION BASIN**  
SCALE: 1" = 20' 6' TALL

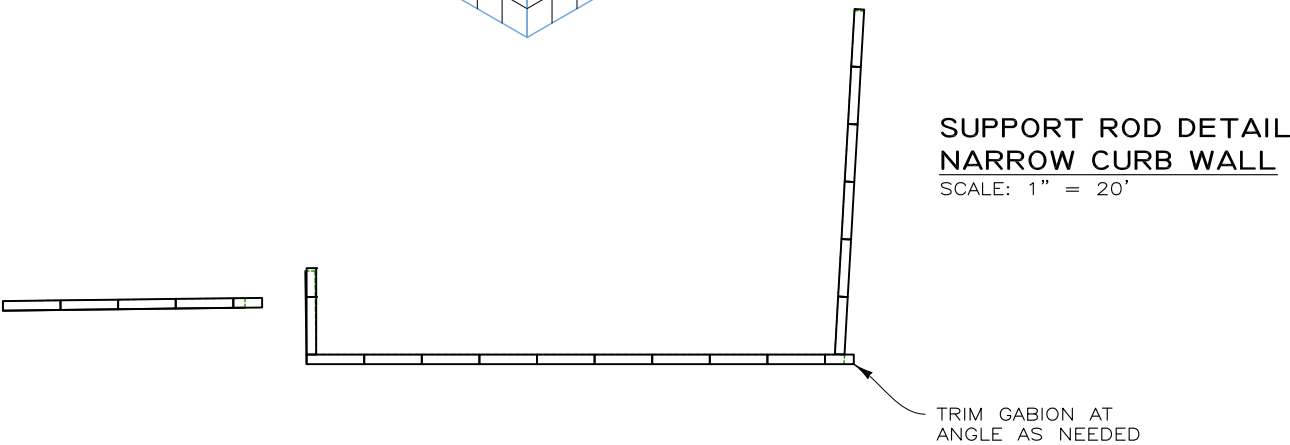

**PLAN VIEW - NARROW CURB WALLS**  
SCALE: 1" = 20'

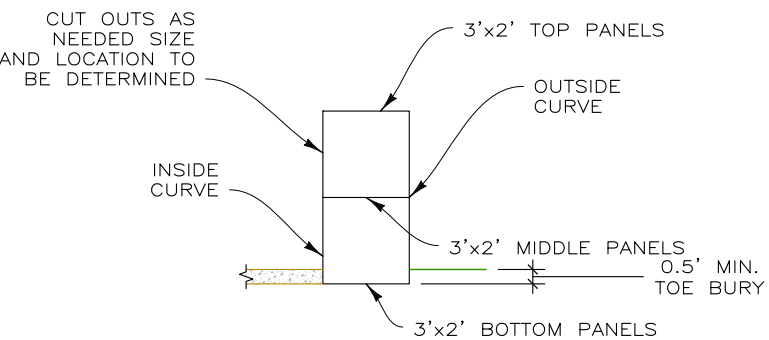

**TYP. SECTION - TANK OVERFLOW DISSIPATION BASIN**  
SCALE: 1" = 20'

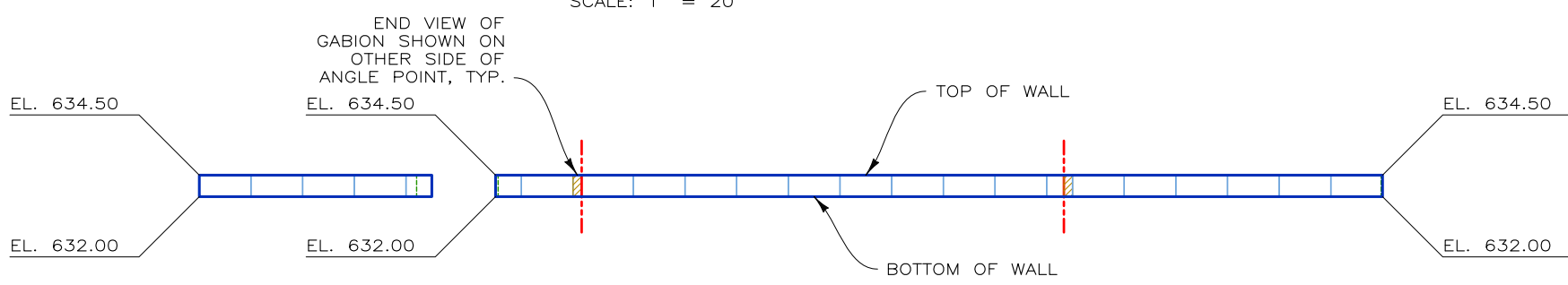

**DEVELOPED ELEVATION - NARROW CURB WALLS**  
SCALE: 1" = 20'

BID DUE: 6 JUN 16

THIS DRAWING IS FURNISHED SOLELY FOR THE USE OF OR IN CONNECTION WITH THIS PROJECT AND THE PROPRIETARY INFORMATION SHOWN HEREON IS NOT TO BE TRANSMITTED TO ANY OTHER ORGANIZATION WITHOUT SPECIFIC AUTHORIZATION BY THE HILFIKER COMPANY. HILFIKER RETAINING WALLS ARE PROTECTED BY ONE OR MORE OF THE FOLLOWING PATENTS: 243,613; 243,697; 288,616; 4,117,686; 4,329,089; 4,324,508; 4,391,557; 4,505,621; 4,343,318; 4,661,023; 4,856,939; 4,929,125; 5,076,735; 5,647,695; 5,722,799; 5,733,072; 6,357,970B1; 6,874,975B2; 7,033,118B2; AND OTHERS. OTHER PATENTS PENDING (2008)

REV.NO.	DATE	BY	DESCRIPTION
1	6 JUN 16	AMJ	BASED ON PHASE 1 PERMIT SET 5-11-16

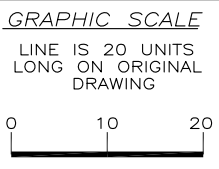

PROJ. MGR.  
BH  
ENGINEER  
CADD BY  
AMJ

**HILFIKER RETAINING WALLS**  
  
1902 Hilfiker Lane  
Eureka, CA 95503-5711  
TOLL-FREE 800.762.8962  
PH 707.443.5093 FAX 707.443.2891  
WEBSITE www.hilfiker.com E-MAIL info@hilfiker.com



DWG DATE  
26 JAN 15  
REVISION DATE  
6 JUN 16  
SCALE  
NOTED

**FOR BIDDING PURPOSES ONLY**  
GABION FACED M.S.E. WITH SPIRALNAILS  
**NBU COMAL SPRINGS CONSERVATION CENTER**  
NEW BRAUNFELS, TEXAS  
TANK DISSIPATOR & NARROW CURB WALL

PROJECT NO.  
150113AF  
SHEET  
**5**  
OF 5