

WLOL -0+02.23
EL. 2521.56

EL. 2517.57

WLOL 2+57.52
EL. 2510.20

EL. 2506.20

EL. 2467.94

EL. 2464.79

DEVELOPED ELEVATION - STA. 2013+57 TO 2015+97.62
SCALE: 1" = 20'

ESTIMATED QUANTITIES

WALL NO.	FACE AREA
SCHEDULE A	
STA. 2013+57 TO 2015+97.62	8,064 SQ. FT.
TOTAL	8,064 SQ. FT.
OPTION X	
STA. 2060+42 TO 2065+28.63	7,000 SQ. FT.
STA. 2069+12 TO 2079+50.04	13,208 SQ. FT.
TOTAL	20,208 SQ. FT.

BID DUE: 25 APR 17

THIS DRAWING IS FURNISHED SOLELY FOR THE USE OF OR IN CONNECTION WITH THIS PROJECT AND THE PROPRIETARY INFORMATION SHOWN HEREON IS NOT TO BE TRANSMITTED TO ANY OTHER ORGANIZATION WITHOUT SPECIFIC AUTHORIZATION BY THE HILFIKER COMPANY. HILFIKER RETAINING WALLS ARE PROTECTED BY ONE OR MORE OF THE FOLLOWING PATENTS: 243,613; 243,697; 288,616; 4,117,686; 4,329,089; 4,324,508; 4,391,557; 4,505,621; 4,343,318; 4,661,023; 4,856,939; 4,929,125; 5,076,735; 5,647,695; 5,722,799; 5,733,072; 6,357,970B1; 6,874,975B2; 7,033,118B2; AND OTHERS. OTHER PATENTS PENDING (2008)

REV. NO.	DATE	BY	DESCRIPTION

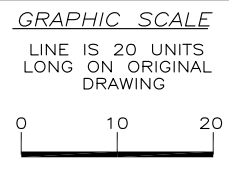

PROJ. MGR.
HKH
ENGINEER
CADD BY
DH

HILFIKER RETAINING WALLS

1902 Hilfiker Lane
Eureka, CA 95503-5711
TOLL-FREE 800.762.8962
PH 707.443.5093 FAX 707.443.2891
WEB SITE www.hilfiker.com E-MAIL info@hilfiker.com

SINCE 1902 QUALITY PRODUCTS

DWG DATE
11 APR 17
REVISION DATE
SCALE
NOTED

FOR BIDDING PURPOSES ONLY

WELDED WIRE WALL
STATE ROUTE 36
FEDERAL HIGHWAY ADMINISTRATION
HUMBOLDT COUNTY, CALIFORNIA
DEVELOPED ELEVATION

PROJECT NO.
170327AW
SHEET
1
OF 6

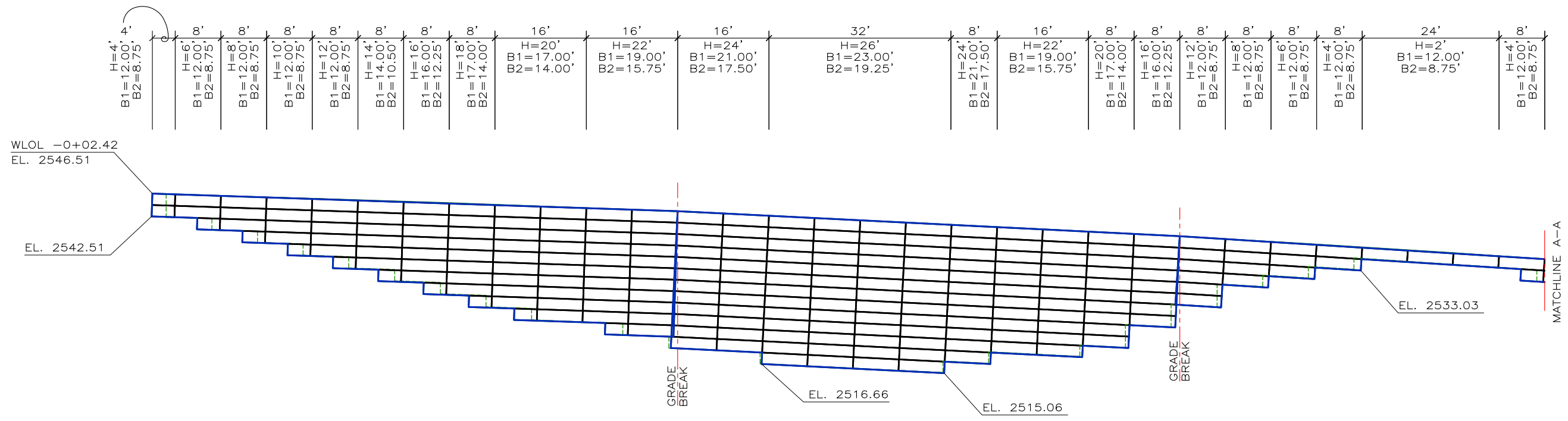

DEVELOPED ELEVATION - STA. 2060+42 TO 2065+28.63
SCALE: 1" = 20'

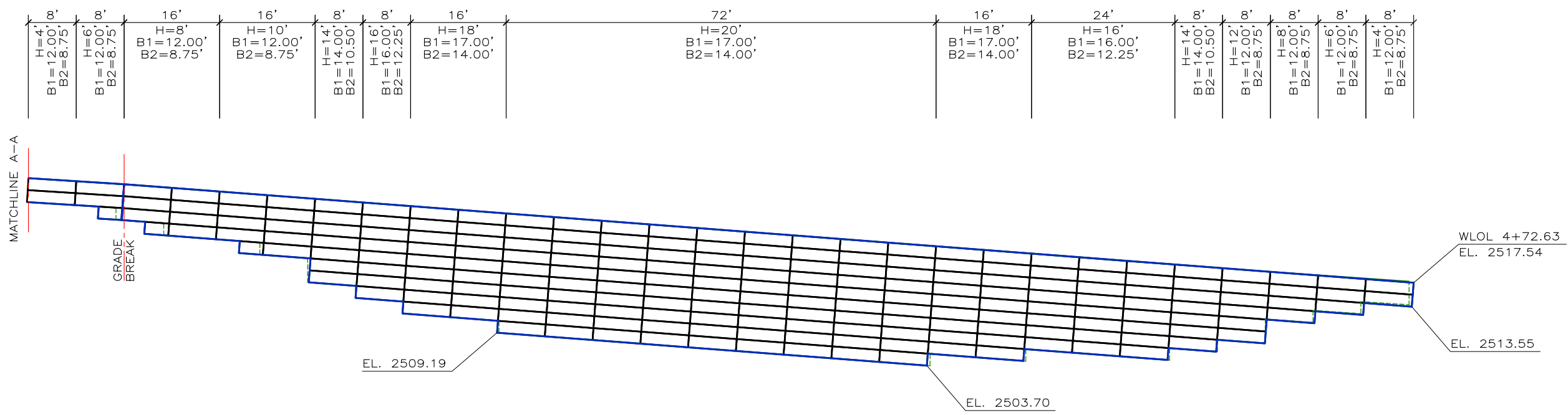

DEVELOPED ELEVATION - STA. 2060+42 TO 2065+28.63 (CONT'D)
SCALE: 1" = 20'

BID DUE: 25 APR 17

THIS DRAWING IS FURNISHED SOLELY FOR THE USE OF OR IN CONNECTION WITH THIS PROJECT AND THE PROPRIETARY INFORMATION SHOWN HEREON IS NOT TO BE TRANSMITTED TO ANY OTHER ORGANIZATION WITHOUT SPECIFIC AUTHORIZATION BY THE HILFIKER COMPANY. HILFIKER RETAINING WALLS ARE PROTECTED BY ONE OR MORE OF THE FOLLOWING PATENTS: 243,613; 243,697; 288,616; 4,117,686; 4,329,089; 4,324,508; 4,391,557; 4,505,621; 4,343,318; 4,661,023; 4,856,939; 4,929,125; 5,076,735; 5,647,695; 5,722,799; 5,733,072; 6,357,970B1; 6,874,975B2; 7,033,118B2; AND OTHERS. OTHER PATENTS PENDING (2008)

REV. NO.	DATE	BY	DESCRIPTION

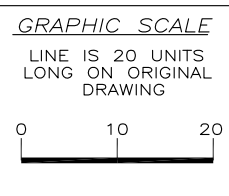

PROJ. MGR.
HKH
ENGINEER
CADD BY
DH

HILFIKER RETAINING WALLS

1902 Eureka, CA 95503-5711
TOLL-FREE 800.762.8962
PH 707.443.5093 FAX 707.443.2891
WEBSITE www.hilfiker.com E-MAIL info@hilfiker.com

DWG DATE
11 APR 17
REVISION DATE
SCALE
NOTED

FOR BIDDING PURPOSES ONLY

WELDED WIRE WALL
STATE ROUTE 36
FEDERAL HIGHWAY ADMINISTRATION
HUMBOLDT COUNTY, CALIFORNIA
DEVELOPED ELEVATION

PROJECT NO.
170327AW
SHEET
2
OF 6

WLOL -0+01.68
EL. 2491.50

EL. 2485.52

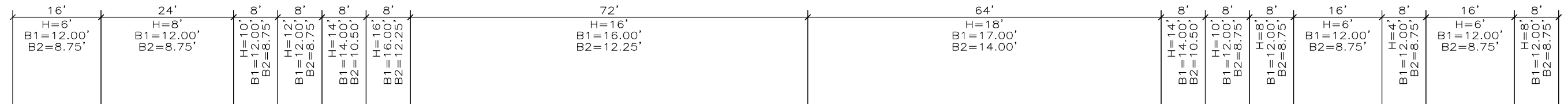

GRADE BREAK

EL. 2461.53

EL. 2456.83

GRADE BREAK

MATCHLINE B-B

DEVELOPED ELEVATION - STA. 2069+12 TO 2079+50.04
SCALE: 1" = 20'

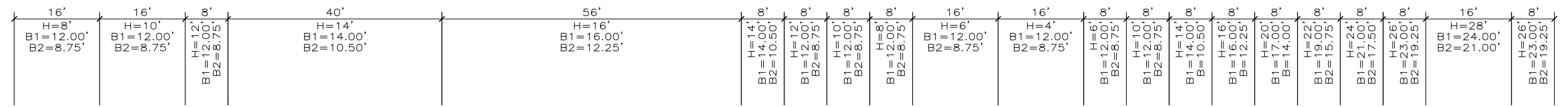

MATCHLINE B-B

EL. 2446.38

EL. 2442.80

MATCHLINE C-C

DEVELOPED ELEVATION - STA. 2069+12 TO 2079+50.04 (CONT'D)
SCALE: 1" = 20'

EL. 2420.68

BID DUE: 25 APR 17

THIS DRAWING IS FURNISHED SOLELY FOR THE USE OF OR IN CONNECTION WITH THIS PROJECT AND THE PROPRIETARY INFORMATION SHOWN HEREON IS NOT TO BE TRANSMITTED TO ANY OTHER ORGANIZATION WITHOUT SPECIFIC AUTHORIZATION BY THE HILFIKER COMPANY. HILFIKER RETAINING WALLS ARE PROTECTED BY ONE OR MORE OF THE FOLLOWING PATENTS: 243,613; 243,697; 288,616; 4,117,686; 4,329,089; 4,324,508; 4,391,557; 4,505,821; 4,343,318; 4,661,023; 4,856,939; 4,929,125; 5,076,735; 5,647,695; 5,722,799; 5,733,072; 6,357,970B1; 6,874,975B2; 7,033,118B2; AND OTHERS. OTHER PATENTS PENDING (2008)

REV.NO.	DATE	BY	DESCRIPTION

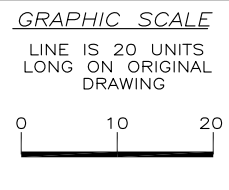

PROJ. MGR.
HKH
ENGINEER
CADD BY
DH

HILFIKER RETAINING WALLS

1902 Hilfiker Lane
Eureka, CA 95503-5711
TOLL-FREE 800.762.8962
PH 707.443.5093 FAX 707.443.2891
WEB SITE www.hilfiker.com E-MAIL info@hilfiker.com

SINCE 1902 QUALITY PRODUCTS

DWG DATE
11 APR 17
REVISION DATE
SCALE
NOTED

FOR BIDDING PURPOSES ONLY

WELDED WIRE WALL
STATE ROUTE 36
FEDERAL HIGHWAY ADMINISTRATION
HUMBOLDT COUNTY, CALIFORNIA
DEVELOPED ELEVATION

PROJECT NO.
170327AW
SHEET
3
OF 6

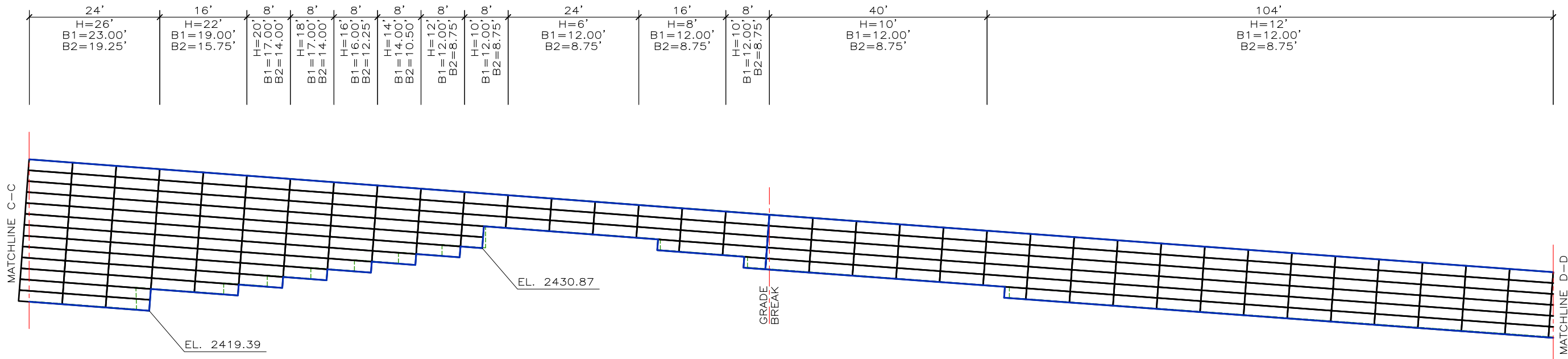

DEVELOPED ELEVATION - STA. 2069+12 TO 2079+50.04 (CONT'D)
SCALE: 1" = 20'

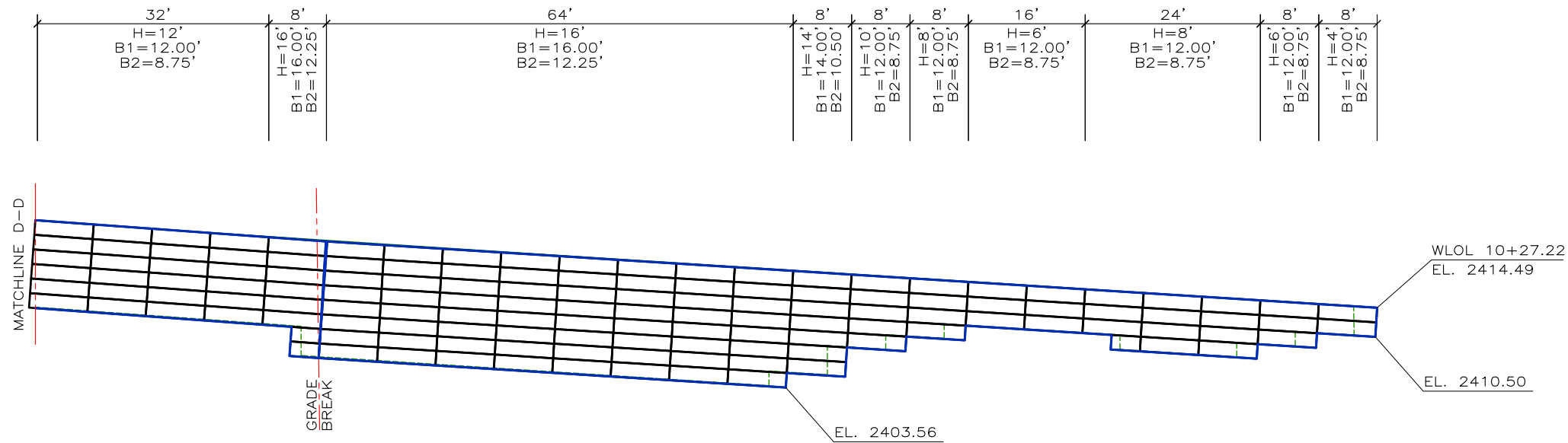

DEVELOPED ELEVATION - STA. 2069+12 TO 2079+50.04 (CONT'D)
SCALE: 1" = 20'

THIS DRAWING IS FURNISHED SOLELY FOR THE USE OF OR IN CONNECTION WITH THIS PROJECT AND THE PROPRIETARY INFORMATION SHOWN HEREON IS NOT TO BE TRANSMITTED TO ANY OTHER ORGANIZATION WITHOUT SPECIFIC AUTHORIZATION BY THE HILFIKER COMPANY. HILFIKER RETAINING WALLS ARE PROTECTED BY ONE OR MORE OF THE FOLLOWING PATENTS: 243,613; 243,697; 288,616; 4,117,686; 4,329,089; 4,324,508; 4,391,557; 4,505,621; 4,343,318; 4,661,023; 4,856,939; 4,929,125; 5,076,735; 5,647,695; 5,722,799; 5,733,072; 6,357,970B1; 6,874,975B2; 7,033,118B2; AND OTHERS. OTHER PATENTS PENDING (2008)

REV.NO.	DATE	BY	DESCRIPTION

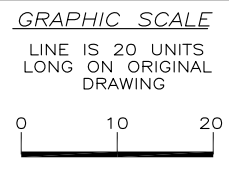

PROJ. MGR.
HKH
ENGINEER
CADD BY
DH

HILFIKER RETAINING WALLS

1902 HilfiKER Lane
Eureka, CA 95503-5711
TOLL-FREE 800.762.8962
PH 707.443.5093 FAX 707.443.2891
WEB SITE www.hilfiKER.com E-MAIL info@hilfiKER.com

SINCE 1902
QUALITY PRODUCTS

DWG DATE
11 APR 17
REVISION DATE
SCALE
NOTED

BID DUE: 25 APR 17

FOR BIDDING PURPOSES ONLY

WELDED WIRE WALL
STATE ROUTE 36
FEDERAL HIGHWAY ADMINISTRATION
HUMBOLDT COUNTY, CALIFORNIA
DEVELOPED ELEVATION

PROJECT NO.
170327AW
SHEET
4
OF 6

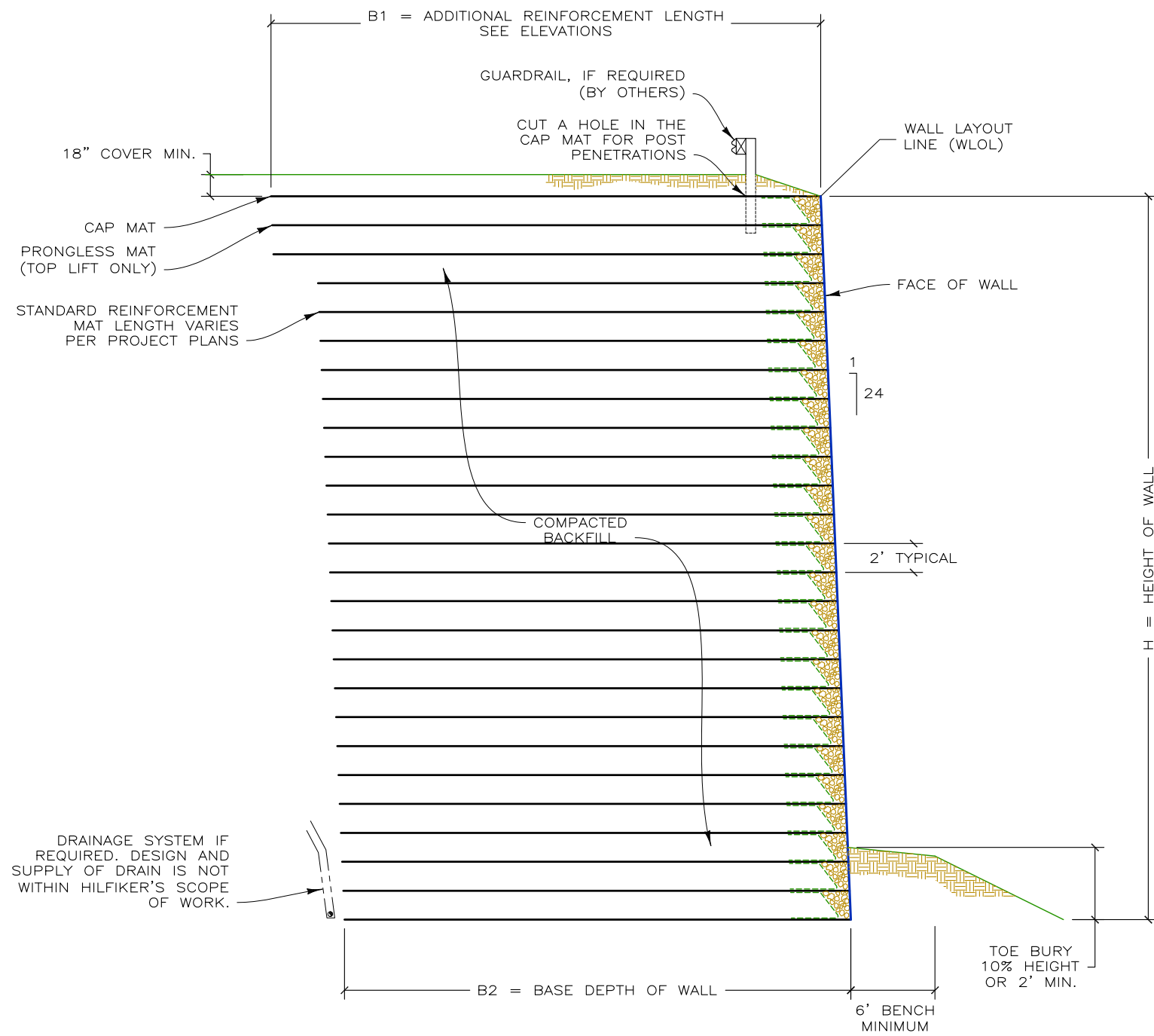

TYPICAL SECTION
SCALE: 2" = 20'

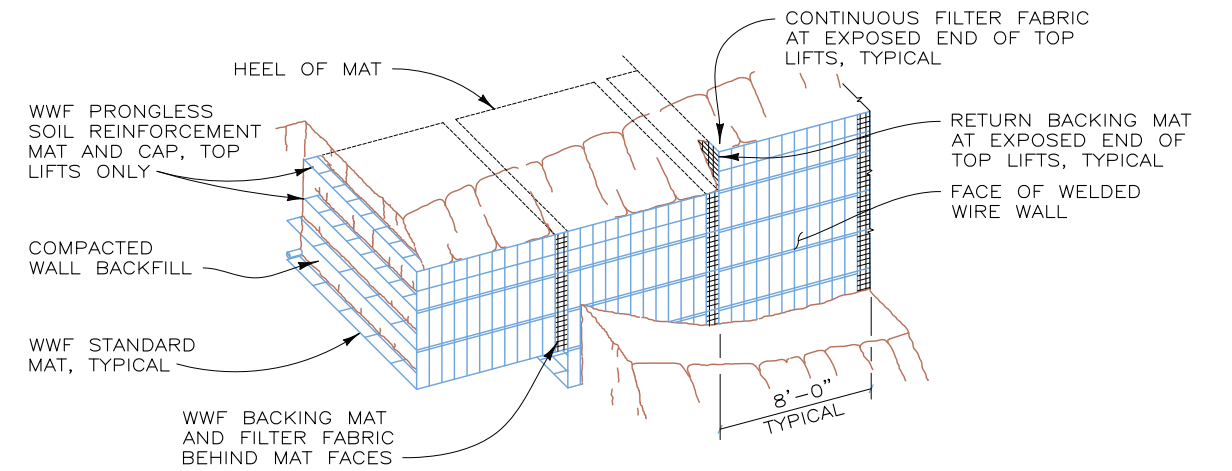

PICTORIAL ELEVATION
NOT TO SCALE

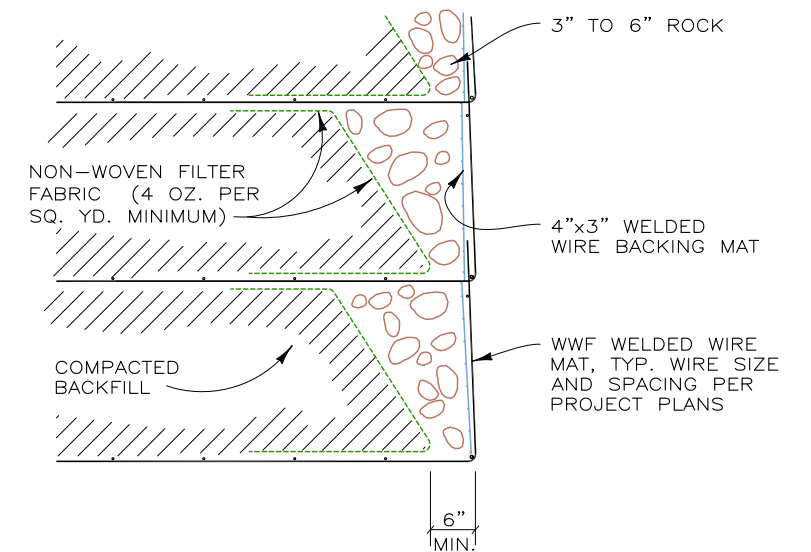

ROCK-FACE DETAIL
NOT TO SCALE

THIS DRAWING IS FURNISHED SOLELY FOR THE USE OF OR IN CONNECTION WITH THIS PROJECT AND THE PROPRIETARY INFORMATION SHOWN HEREON IS NOT TO BE TRANSMITTED TO ANY OTHER ORGANIZATION WITHOUT SPECIFIC AUTHORIZATION BY THE HILFIKER COMPANY. HILFIKER RETAINING WALLS ARE PROTECTED BY ONE OR MORE OF THE FOLLOWING PATENTS: 243,613; 243,697; 288,616; 4,117,686; 4,329,089; 4,324,508; 4,391,557; 4,505,621; 4,343,318; 4,661,023; 4,856,939; 4,929,125; 5,076,735; 5,647,695; 5,722,799; 5,733,072; 6,357,970B1; 6,874,975B2; 7,033,118B2; AND OTHERS. OTHER PATENTS PENDING (2008)

REV.NO.	DATE	BY	DESCRIPTION

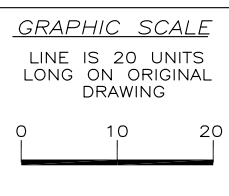

PROJ. MGR.
HKH
ENGINEER
CADD BY
DH

HILFIKER RETAINING WALLS

1902 Hilfiker Lane
Eureka, CA 95503-5711
TOLL-FREE 800.762.8962
PH 707.443.5093 FAX 707.443.2891
WEB SITE www.hilfiker.com E-MAIL info@hilfiker.com

DWG DATE
11 APR 17
REVISION DATE
SCALE
NOTED

BID DUE: 25 APR 17

FOR BIDDING PURPOSES ONLY

WELDED WIRE WALL
STATE ROUTE 36
FEDERAL HIGHWAY ADMINISTRATION
HUMBOLDT COUNTY, CALIFORNIA

TYPICAL SECTION AND DETAILS

PROJECT NO.
170327AW
SHEET
5
OF 6

STEP 1

PLACE THE FIRST COURSE OF SOIL REINFORCEMENT MATS ON PREPARED FOUNDATION

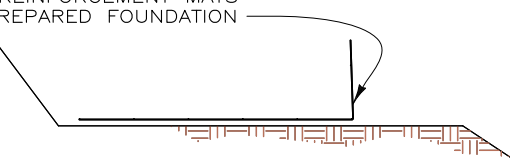

STEP 2

PLACE THE BACKING MAT AGAINST THE INSIDE FACE OF THE SOIL REINFORCEMENT MAT. CLIP THE SECOND-TO-TOP TRANSVERSE WIRE ON THE BACKING MAT TO THE TOP TRANSVERSE WIRE ON THE SOIL REINFORCEMENT MAT.

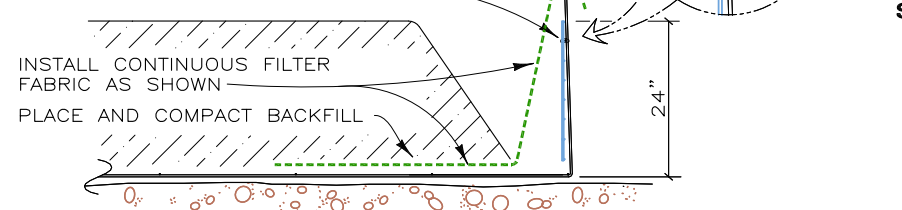

STEP 3

BRING THE FILTER FABRIC OVER THE FRONT AND TOP OF THE BACKFILL AS SHOWN. PLACE THE ROCK IN THE VOID AS SHOWN.

PLACE THE SECOND COURSE OF SOIL REINFORCEMENT MATS WITH THE BASE LONGITUDINAL WIRES RESTING ON THE TOP TRANSVERSE WIRE OF THE BACKING MAT BELOW. SLIDE THE SOIL REINFORCEMENT MAT INTO ALIGNMENT.

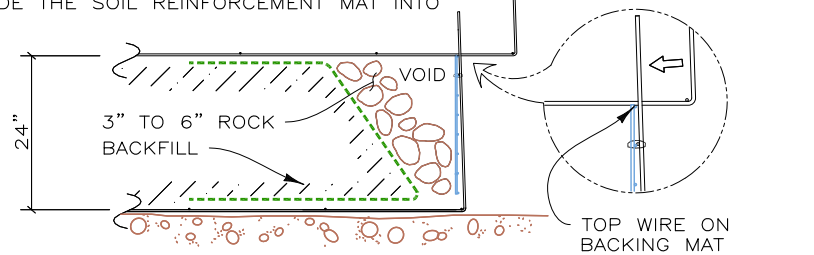

STEP 4

HOOK THE BOTTOM TRANSVERSE WIRE OF THE BACKING MAT OVER THE VERTICAL PRONGS ON THE LOWER MAT. ROTATE THE BACKING MAT TO VERTICAL AND CLIP THE SECOND-TO-TOP TRANSVERSE WIRE ON THE BACKING MAT TO THE TOP WIRE ON THE SOIL REINFORCEMENT MAT.

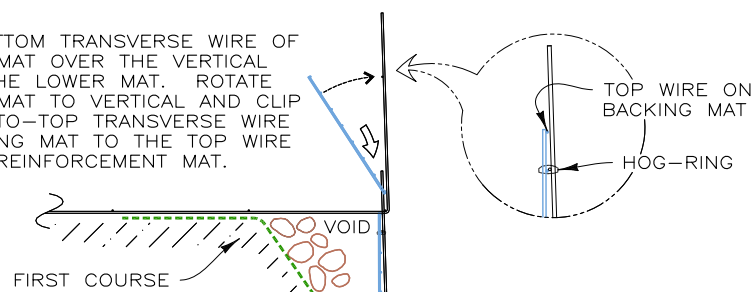

STEP 5

INSTALL THE FILTER FABRIC AS IN STEPS 2 AND 3. PLACE AND COMPACT THE BACKFILL AND ROCK TO THE BASE ELEVATION OF THE NEXT MAT. REPEAT STEPS 2 THROUGH 5 TO THE TOP LIFT.

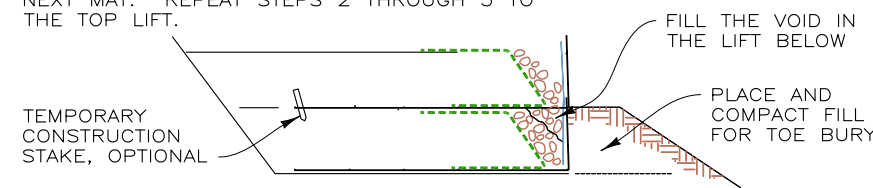

STEP 6: TOP LIFT

PLACE THE TOP LIFT PRONGLESS MAT, BACKING MAT AND FILTER FABRIC. PLACE AND COMPACT BACKFILL AND ROCK IN THE TOP LIFT. HOOK THE CAP OVER THE MIDDLE TRANSVERSE WIRE ON THE PRONGLESS MAT, AND ROTATE INTO PLACE. PLACE AND COMPACT COVER OVER TOP MAT TO 1'-6" MINIMUM DEPTH.

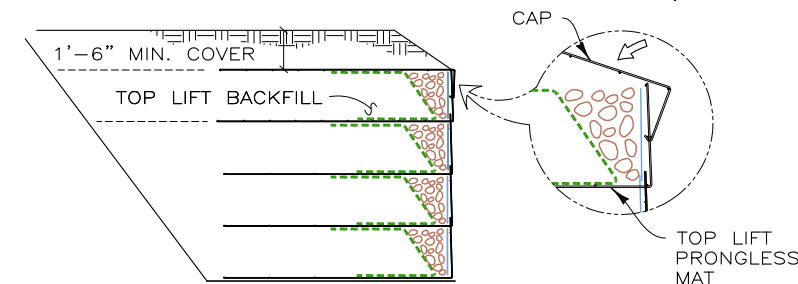

CONSTRUCTION SEQUENCE

NOT TO SCALE

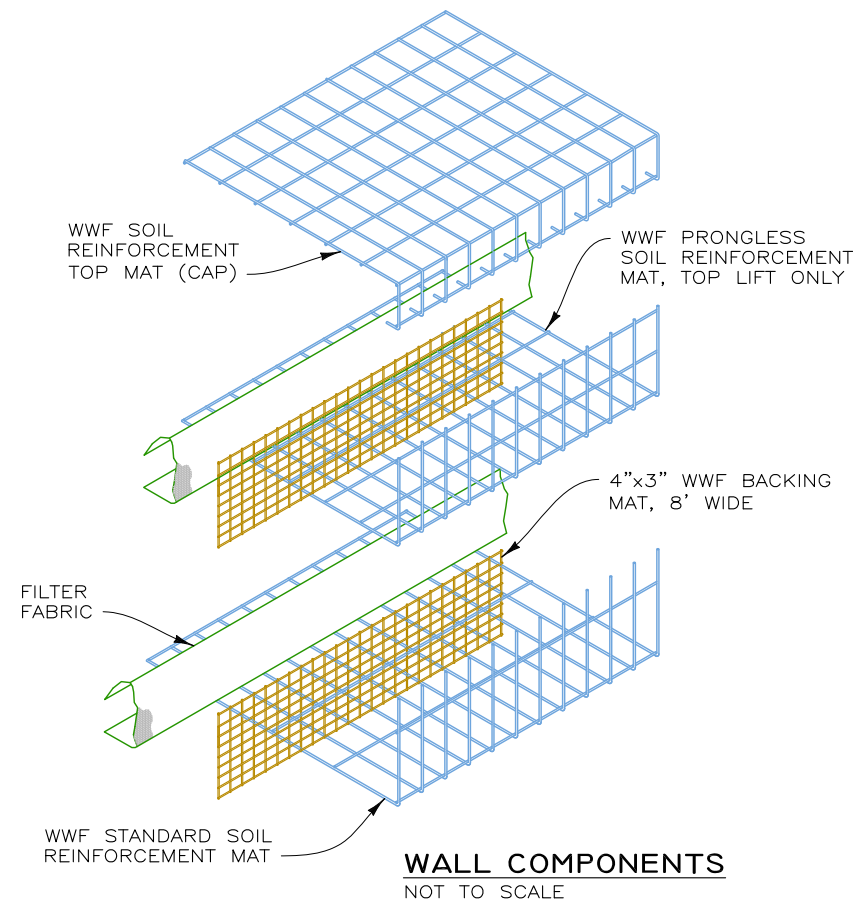

WALL COMPONENTS
NOT TO SCALE

PROJECT-SPECIFIC NOTES:

1. REFERENCE DRAWINGS: BASED ON PROJECT PLANS FROM U.S. DEPARTMENT OF TRANSPORTATION FEDERAL HIGHWAY ADMINISTRATION APPROVED MARCH 9, 2017. SHEETS B2, B6, B27, G5 - G10 AND T28.
2. BLACK AND WHITE REPRODUCTION OF THIS COLOR ORIGINAL MAY REDUCE ITS EFFECTIVENESS AND LEAD TO INCORRECT INTERPRETATION.
3. IT IS ASSUMED THAT ALL MATERIALS, BACKFILL AND CONSTRUCTION METHODS FOR HILFIKER M.S.E. WALLS WILL CONFORM TO HILFIKER'S SPECIFICATIONS AND/OR THOSE OF THE HILFIKER ENGINEERING CONSULTANT.
4. THIS IS NOT AN ENGINEERED SUBMITTAL. ALL INFORMATION HEREON IS DERIVED FROM THE REFERENCE DRAWINGS, AND IS SUBJECT TO GEOMETRIC AND GEOTECHNICAL CONFIRMATION. THE APPLICABLE HILFIKER CONSTRUCTION GUIDE AND SPECIFICATIONS ARE AN INTEGRAL PART OF THIS SUBMITTAL.
5. UPON ENGINEERED DESIGN, HILFIKER RETAINING WALLS SHALL BE RESPONSIBLE ONLY FOR THE INTERNAL STABILITY OF THE RETAINING WALL, AND NOT FOR GLOBAL STABILITY OR FOUNDATION BEARING CAPACITY. THE OWNER/CONTRACTOR SHALL BE RESPONSIBLE FOR ALL JOB SITE DRAINAGE, SAFETY AND FALL PROTECTION PROVISIONS FOR WORKERS IN COMPLIANCE WITH OSHA AND ANY OTHER APPLICABLE REQUIREMENTS.
6. WALL DESIGN SHALL REQUIRE A NON-SATURATED BACKFILL. SURFACE AND SUBSURFACE DRAINAGE CONTROL MAY BE REQUIRED TO PREVENT SATURATION OF THE BACKFILL OR TO RELIEVE HYDROSTATIC PRESSURES. DRAINAGE CONTROL SHALL BE AS SPECIFIED IN THE OWNER'S PROJECT PLANS AND SPECIFICATIONS, OR AS DIRECTED BY THE OWNER'S ENGINEER.

BID DUE: 25 APR 17

170327AW - STATE ROUTE 36

THIS DRAWING IS FURNISHED SOLELY FOR THE USE OF OR IN CONNECTION WITH THIS PROJECT AND THE PROPRIETARY INFORMATION SHOWN HEREON IS NOT TO BE TRANSMITTED TO ANY OTHER ORGANIZATION WITHOUT SPECIFIC AUTHORIZATION BY THE HILFIKER COMPANY. HILFIKER RETAINING WALLS ARE PROTECTED BY ONE OR MORE OF THE FOLLOWING PATENTS: 2,433,613; 2,433,697; 2,886,616; 4,117,686; 4,329,089; 4,324,508; 4,391,557; 4,505,621; 4,343,318; 4,661,023; 4,856,939; 4,929,125; 5,076,735; 5,647,695; 5,722,799; 5,733,072; 6,357,970B1; 6,874,975B2; 7,033,118B2; AND OTHERS. OTHER PATENTS PENDING (2008)

REV.NO.	DATE	BY	DESCRIPTION

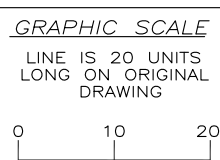

PROJ. MGR.
HKH
ENGINEER
CADD BY
DH

HILFIKER RETAINING WALLS

1902 Hilfiker Lane
Eureka, CA 95503-5711
TOLL-FREE 800.762.8962
PH 707.443.5093 FAX 707.443.2891
WEBSITE www.hilfiker.com E-MAIL info@hilfiker.com

DWG DATE
11 APR 17
REVISION DATE
SCALE
NOTED

FOR BIDDING PURPOSES ONLY

WELDED WIRE WALL
STATE ROUTE 36
FEDERAL HIGHWAY ADMINISTRATION
HUMBOLDT COUNTY, CALIFORNIA

CONSTRUCTION SEQUENCE AND NOTES

PROJECT NO.
170327AW
SHEET
6
OF 6