

171214AW—STARKES GRADE ROAD SLIPOUT PROJECT

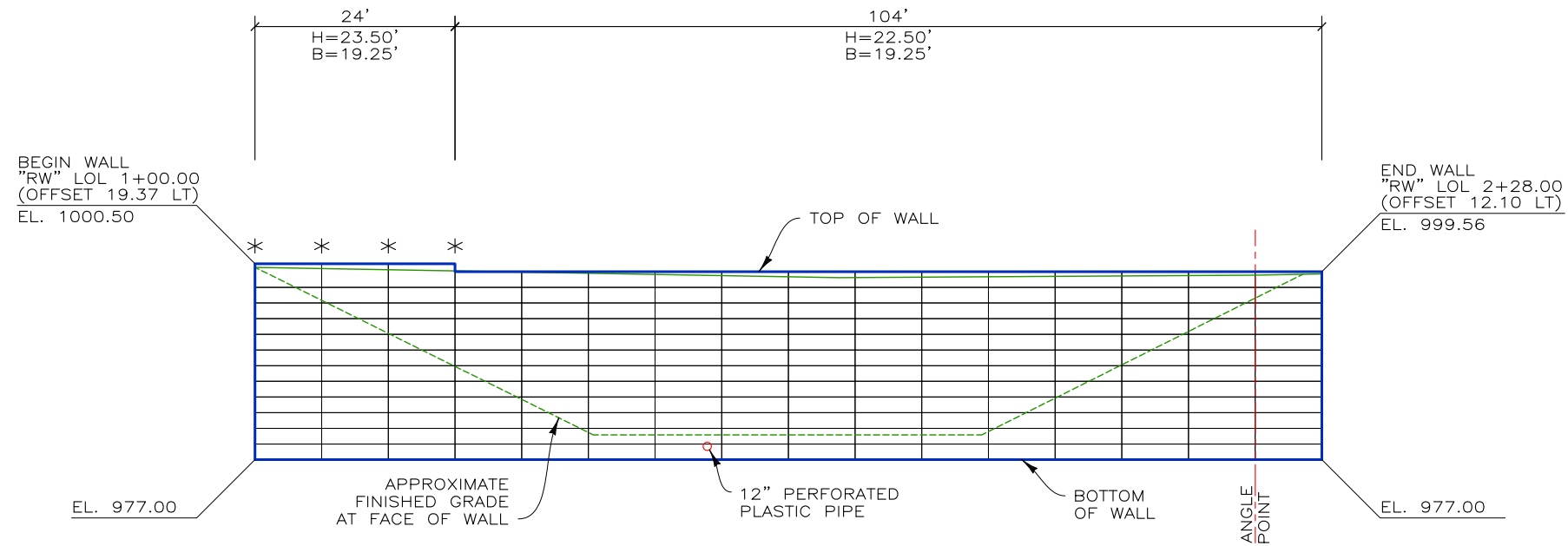
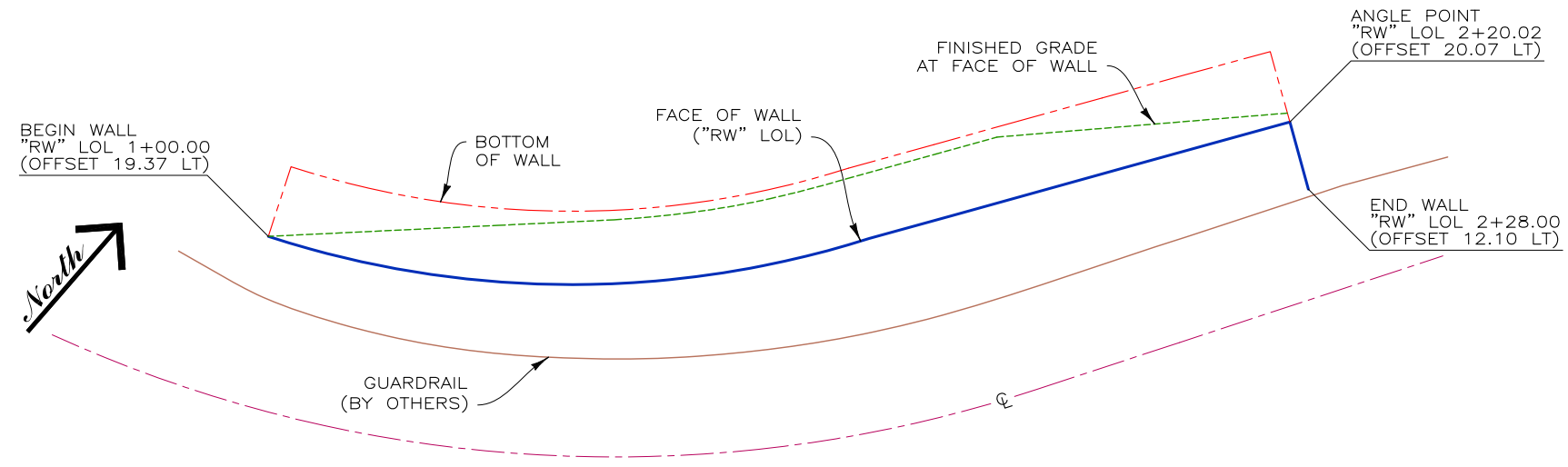

NOTE: \* INDICATES THE APPROXIMATE LOCATION OF THE MIDDLE OF EACH 3' BACKING MAT

**ESTIMATED QUANTITIES:**

TOTAL FACE AREA: 3,104 SQ. FT.

BID DUE: 4 JAN 18

THIS DRAWING IS FURNISHED SOLELY FOR THE USE OF OR IN CONNECTION WITH THIS PROJECT AND THE PROPRIETARY INFORMATION SHOWN HEREON IS NOT TO BE TRANSMITTED TO ANY OTHER ORGANIZATION WITHOUT SPECIFIC AUTHORIZATION BY THE HILFIKER COMPANY. HILFIKER RETAINING WALLS ARE PROTECTED BY ONE OR MORE OF THE FOLLOWING PATENTS: 243,613; 243,697; 288,616; 4,117,686; 4,329,089; 4,324,508; 4,391,557; 4,505,621; 4,343,318; 4,661,023; 4,856,939; 4,929,125; 5,076,735; 5,647,695; 5,722,799; 5,733,072; 6,357,970B1; 6,874,975B2; 7,033,118B2; AND OTHERS. OTHER PATENTS PENDING (2008)

REV.NO.	DATE	BY	DESCRIPTION

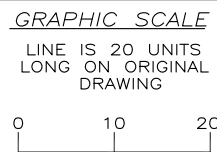

PROJ. MGR.  
BH  
ENGINEER  
CADD BY  
DH

**HILFIKER RETAINING WALLS**

1902 Hilfiker Lane  
Eureka, CA 95503-5711  
TOLL-FREE 800.762.8962  
PH 707.443.5093 FAX 707.443.2891  
WEBSITE www.hilfiker.com E-MAIL info@hilfiker.com

SINCE 1902 QUALITY PRODUCTS

DWG DATE  
15 DEC 17  
REVISION DATE  
SCALE  
NOTED

**FOR BIDDING PURPOSES ONLY**  
WELDED WIRE WALL  
**STARKES GRADE ROAD SLIPOUT PROJECT**  
EL DORADO COUNTY, CALIFORNIA  
PLAN VIEW AND DEVELOPED ELEVATION

PROJECT NO.  
171214AW  
SHEET  
**1**  
OF 3

171214AW - STARKES GRADE ROAD SLIPOUT PROJECT

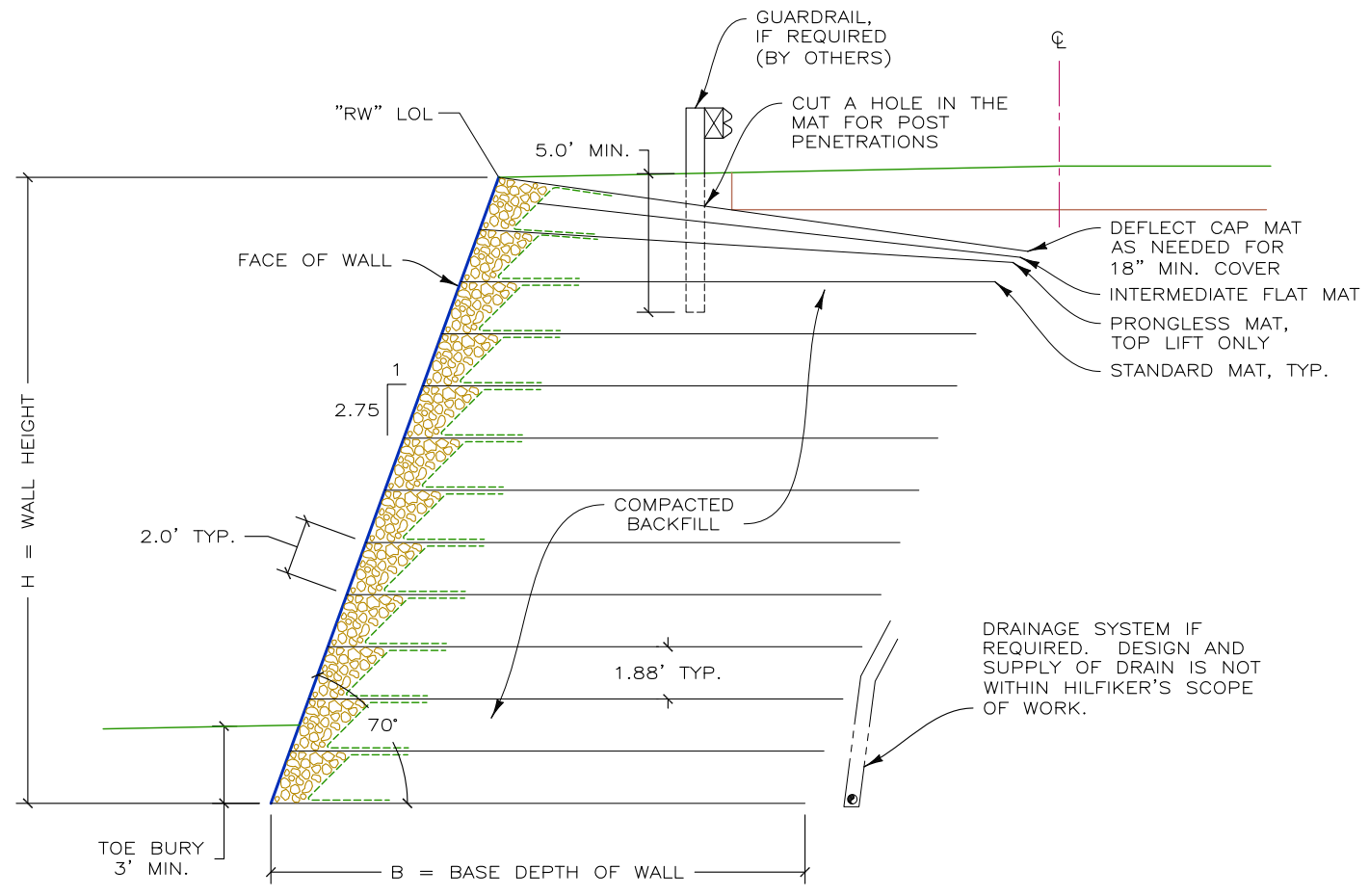

**TYPICAL SECTION**  
SCALE: 3" = 20'

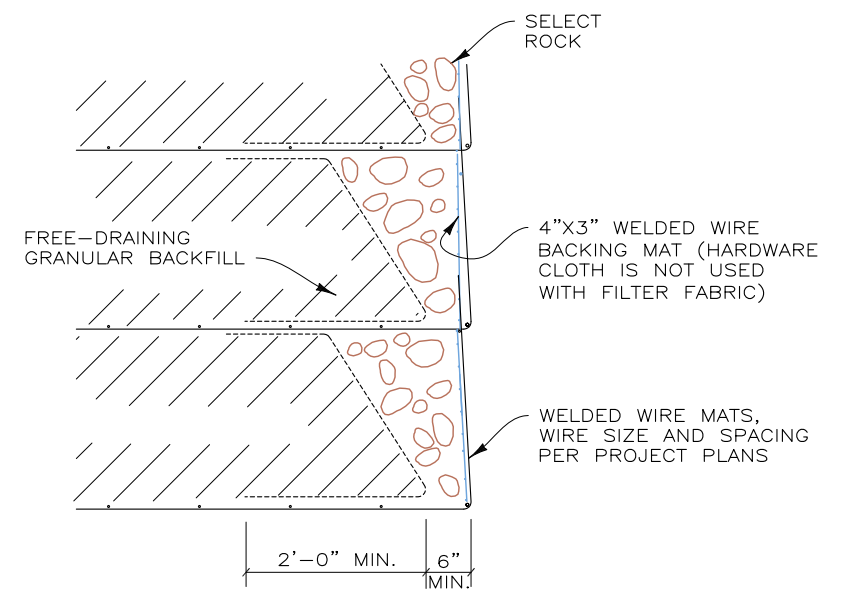

**SECTION**  
**ROCK FACING DETAIL**  
NOT TO SCALE

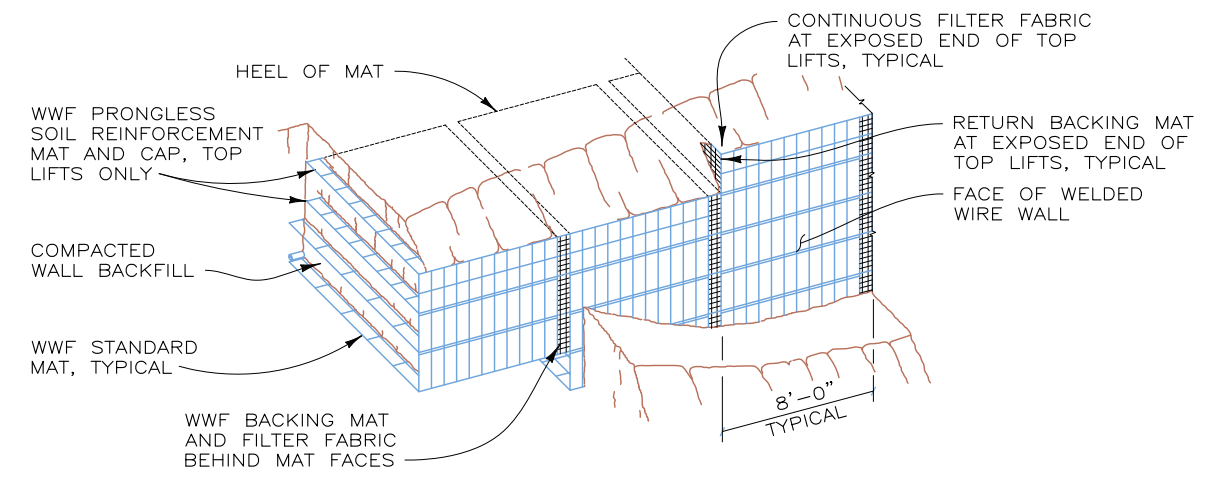

**PICTORIAL ELEVATION**  
NOT TO SCALE

BID DUE: 4 JAN 18

THIS DRAWING IS FURNISHED SOLELY FOR THE USE OF OR IN CONNECTION WITH THIS PROJECT AND THE PROPRIETARY INFORMATION SHOWN HEREON IS NOT TO BE TRANSMITTED TO ANY OTHER ORGANIZATION WITHOUT SPECIFIC AUTHORIZATION BY THE HILFIKER COMPANY. HILFIKER RETAINING WALLS ARE PROTECTED BY ONE OR MORE OF THE FOLLOWING PATENTS: 243,613; 243,697; 288,616; 4,117,686; 4,329,089; 4,324,508; 4,391,557; 4,505,821; 4,343,318; 4,661,023; 4,856,939; 4,929,125; 5,076,735; 5,647,695; 5,722,799; 5,733,072; 6,357,970B1; 6,874,975B2; 7,033,118B2; AND OTHERS. OTHER PATENTS PENDING (2008)

REV.NO.	DATE	BY	DESCRIPTION

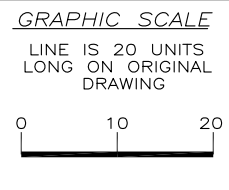

PROJ. MGR.  
BH  
ENGINEER  
CADD BY  
DH

**HILFIKER RETAINING WALLS**

1902 Hilfiker Lane  
Eureka, CA 95503-5711  
TOLL-FREE 800.762.8962  
PH 707.443.5093 FAX 707.443.2891  
WEBSITE www.hilfiker.com E-MAIL info@hilfiker.com

**SINCE 1902**  
QUALITY PRODUCTS

DWG DATE  
15 DEC 17  
REVISION DATE  
SCALE  
NOTED

**FOR BIDDING PURPOSES ONLY**

WELDED WIRE WALL  
**STARKES GRADE ROAD SLIPOUT PROJECT**  
EL DORADO COUNTY, CALIFORNIA

TYPICAL SECTION AND DETAILS

PROJECT NO.  
171214AW  
SHEET  
**2**  
OF 3

171214AW - STARKES GRADE ROAD SLIPOUT PROJECT

**STEP 1**

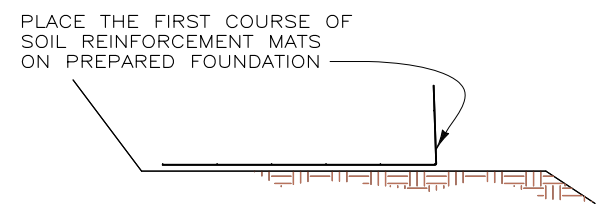

**STEP 2**

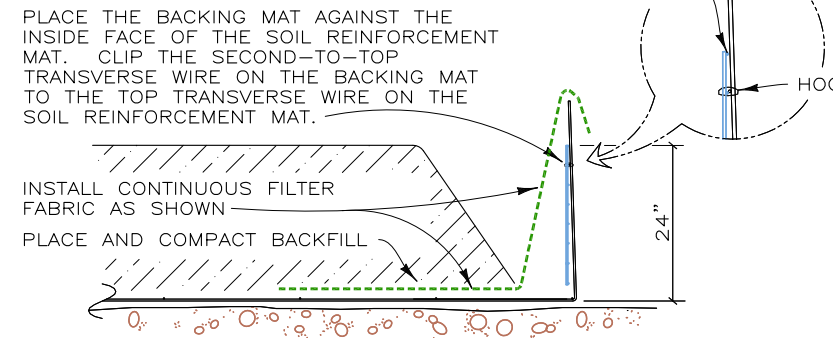

**STEP 3**

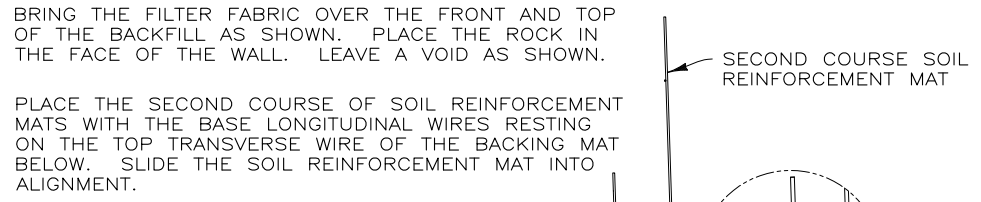

**STEP 4**

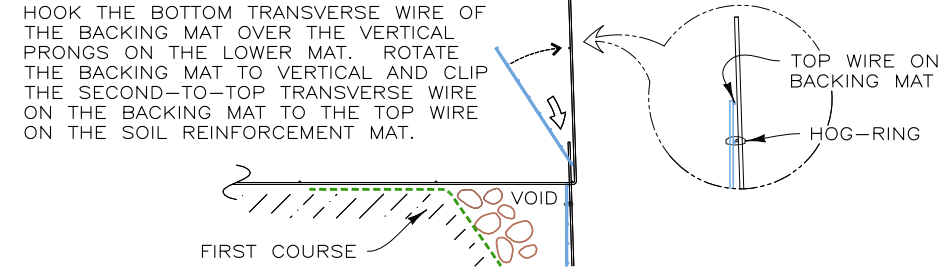

**STEP 5**

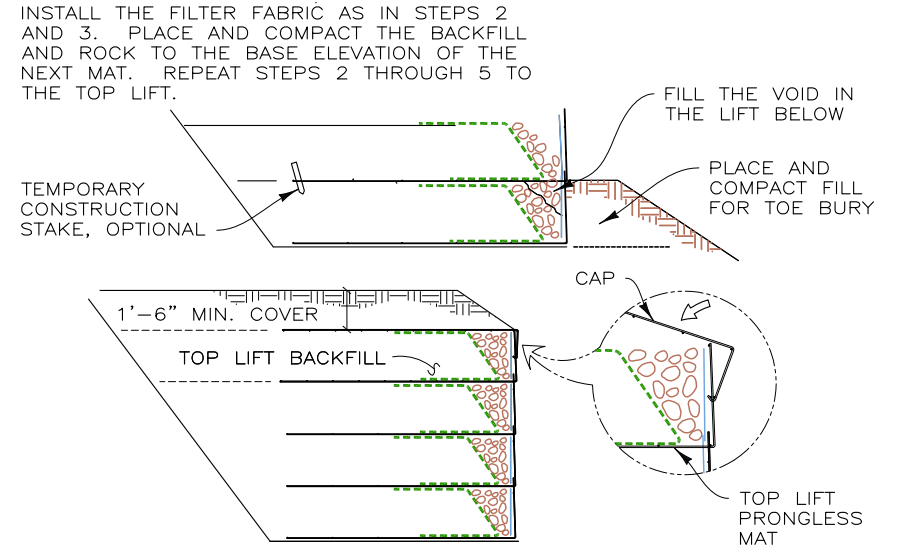

**STEP 6: TOP LIFT**

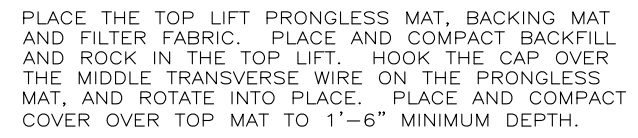

**CONSTRUCTION SEQUENCE**

NOT TO SCALE

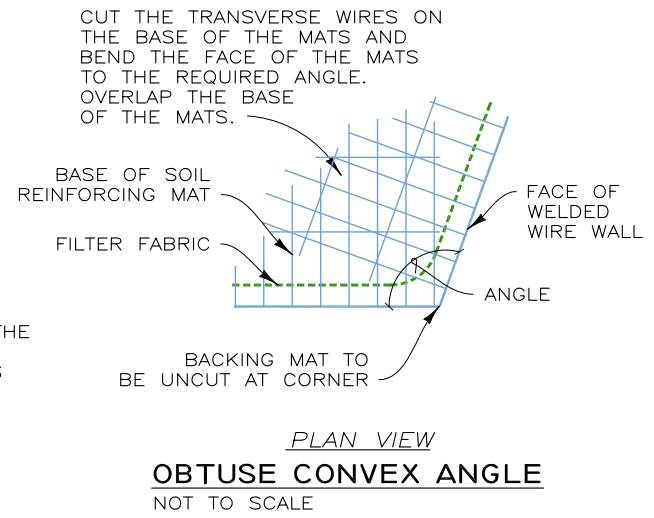
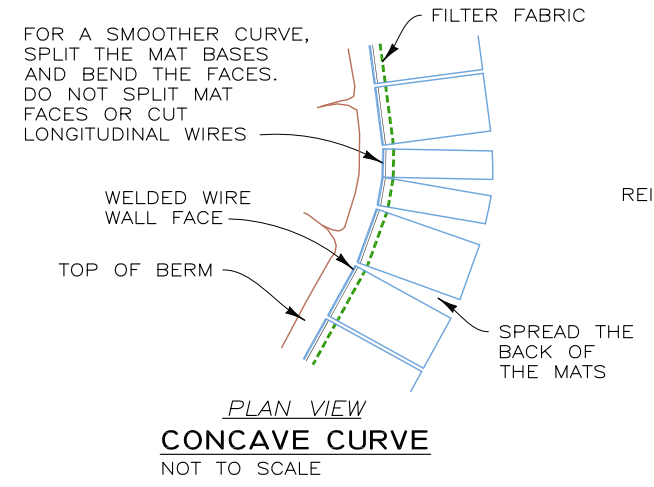
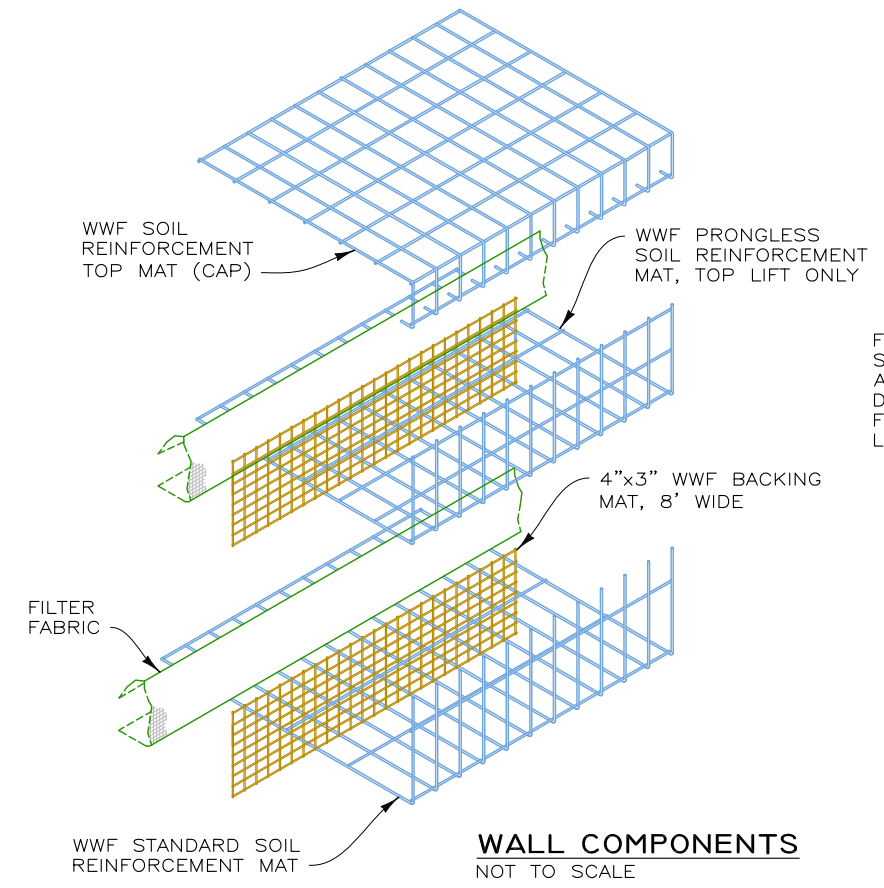

**PROJECT-SPECIFIC NOTES:**

1. REFERENCE DRAWINGS: BASED ON PROJECT PLANS FROM THE COUNTY OF EL DORADO, CALIFORNIA DEPARTMENT OF TRANSPORTATION APPROVED DECEMBER 6, 2017. SHEETS 13-16 OF 16.
2. BLACK AND WHITE REPRODUCTION OF THIS COLOR ORIGINAL MAY REDUCE ITS EFFECTIVENESS AND LEAD TO INCORRECT INTERPRETATION.
3. IT IS ASSUMED THAT ALL MATERIALS, BACKFILL AND CONSTRUCTION METHODS FOR HILFIKER M.S.E. WALLS WILL CONFORM TO HILFIKER'S SPECIFICATIONS AND/OR THOSE OF THE HILFIKER ENGINEERING CONSULTANT.
4. THIS IS NOT AN ENGINEERED SUBMITTAL. ALL INFORMATION HEREON IS DERIVED FROM THE REFERENCE DRAWINGS, AND IS SUBJECT TO GEOMETRIC AND GEOTECHNICAL CONFIRMATION. THE APPLICABLE HILFIKER CONSTRUCTION GUIDE AND SPECIFICATIONS ARE AN INTEGRAL PART OF THIS SUBMITTAL.
5. UPON ENGINEERED DESIGN, HILFIKER RETAINING WALLS SHALL BE RESPONSIBLE ONLY FOR THE INTERNAL STABILITY OF THE RETAINING WALL, AND NOT FOR GLOBAL STABILITY OR FOUNDATION BEARING CAPACITY. THE OWNER/CONTRACTOR SHALL BE RESPONSIBLE FOR ALL JOB SITE DRAINAGE, SAFETY AND FALL PROTECTION PROVISIONS FOR WORKERS IN COMPLIANCE WITH OSHA AND ANY OTHER APPLICABLE REQUIREMENTS.
6. WALL DESIGN SHALL REQUIRE A NON-SATURATED BACKFILL. SURFACE AND SUBSURFACE DRAINAGE CONTROL MAY BE REQUIRED TO PREVENT SATURATION OF THE BACKFILL OR TO RELIEVE HYDROSTATIC PRESSURES. DRAINAGE CONTROL SHALL BE AS SPECIFIED IN THE OWNER'S PROJECT PLANS AND SPECIFICATIONS, OR AS DIRECTED BY THE OWNER'S ENGINEER.

BID DUE: 4 JAN 18

THIS DRAWING IS FURNISHED SOLELY FOR THE USE OF OR IN CONNECTION WITH THIS PROJECT AND THE PROPRIETARY INFORMATION SHOWN HEREON IS NOT TO BE TRANSMITTED TO ANY OTHER ORGANIZATION WITHOUT SPECIFIC AUTHORIZATION BY THE HILFIKER COMPANY. HILFIKER RETAINING WALLS ARE PROTECTED BY ONE OR MORE OF THE FOLLOWING PATENTS: 2,433,613; 2,433,697; 2,888,616; 4,117,686; 4,329,089; 4,324,508; 4,391,557; 4,505,621; 4,343,318; 4,661,023; 4,856,939; 4,929,125; 5,076,735; 5,647,695; 5,722,799; 5,733,072; 6,357,970B1; 6,874,975B2; 7,033,118B2; AND OTHERS. OTHER PATENTS PENDING (2008)

REV.NO.	DATE	BY	DESCRIPTION

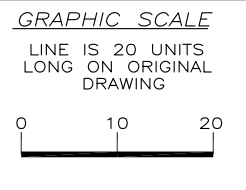

PROJ. MGR.  
BH  
ENGINEER  
CADD BY  
DH

**HILFIKER RETAINING WALLS**

1902 HilfiKER Lane  
Eureka, CA 95503-5711  
TOLL-FREE 800.762.8962  
PH 707.443.5093 FAX 707.443.2891  
WEBSITE www.hilfiKER.com E-MAIL info@hilfiKER.com

SINCE 1902  
QUALITY PRODUCTS

DWG DATE  
15 DEC 17  
REVISION DATE  
SCALE  
NOTED

**FOR BIDDING PURPOSES ONLY**

WELDED WIRE WALL  
**STARKES GRADE ROAD SLIPOUT PROJECT**  
EL DORADO COUNTY, CALIFORNIA

CONSTRUCTION SEQUENCE AND NOTES

PROJECT NO.  
171214AW  
SHEET  
**3**  
OF 3