

HILFIKER RETAINING WALLS

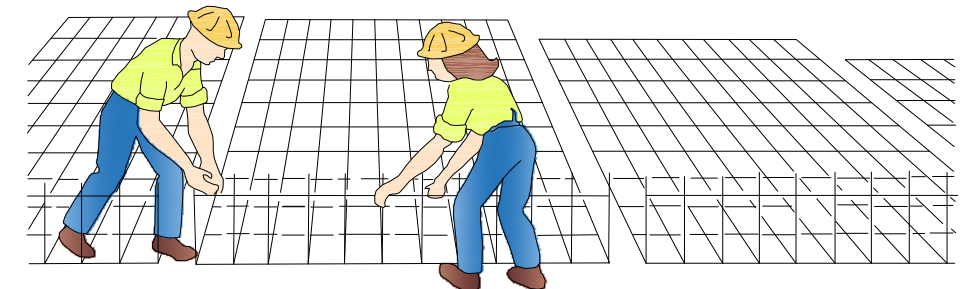

Shop Drawings

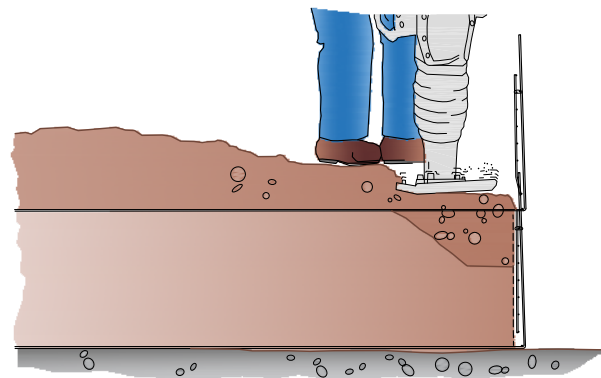
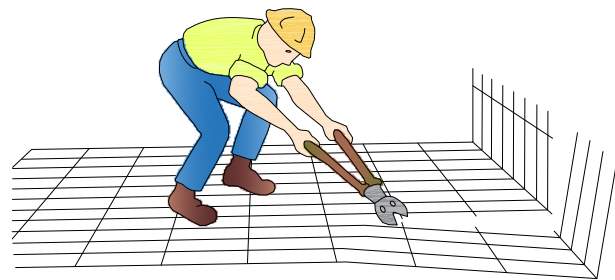
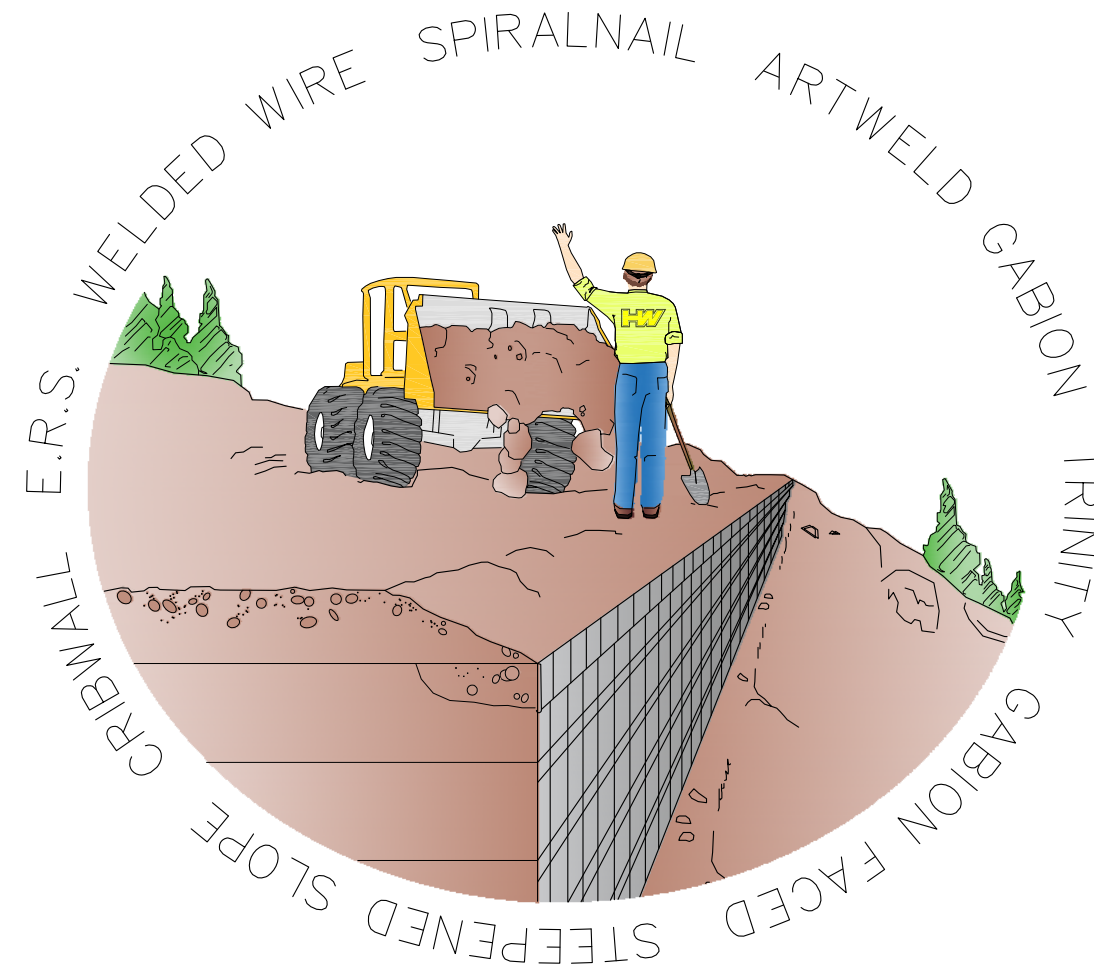

WELDED WIRE WALL
ARTWELD GABION

BASE TO BASE GONDOLA, KT-22
(HRW 210322BW)

210322BW BASE TP BASE GONDOLA, KT-22

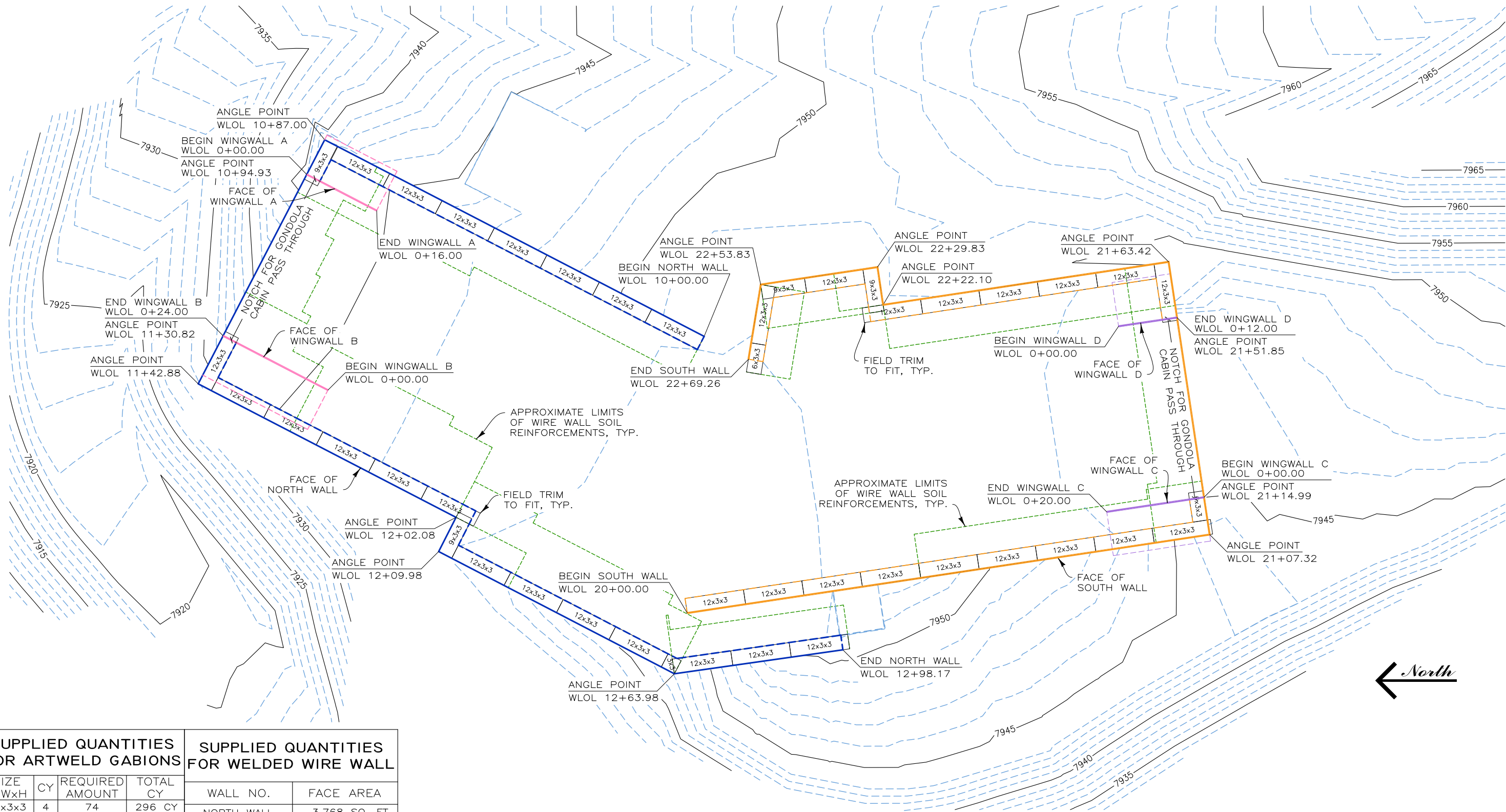

PLAN VIEW
SCALE: 1" = 20'

SUPPLIED QUANTITIES FOR ARTWELD GABIONS				SUPPLIED QUANTITIES FOR WELDED WIRE WALL	
SIZE LxWxH	CY	REQUIRED AMOUNT	TOTAL CY	WALL NO.	FACE AREA
12x3x3	4	74	296 CY	NORTH WALL	3,768 SQ. FT.
9x3x3	3	8	24 CY	SOUTH WALL	872 SQ. FT.
6x3x3	2	4	8 CY		
3x3x3	1	2	2 CY		
TOTALS			330 CY	TOTALS	4,640 SQ. FT.

THIS DRAWING IS FURNISHED SOLELY FOR THE USE OF OR IN CONNECTION WITH THIS PROJECT AND THE PROPRIETARY INFORMATION SHOWN HEREON IS NOT TO BE TRANSMITTED TO ANY OTHER ORGANIZATION WITHOUT SPECIFIC AUTHORIZATION BY THE HILFIKER COMPANY. HILFIKER RETAINING WALLS ARE PROTECTED BY ONE OR MORE OF THE FOLLOWING PATENTS: 243,613; 243,697; 288,616; 4,117,686; 4,329,089; 4,324,508; 4,391,557; 4,505,621; 4,343,318; 4,661,023; 4,856,939; 4,929,125; 5,076,735; 5,647,695; 5,722,799; 5,733,072; 6,357,970B1; 6,874,975B2; 7,033,118B2; AND OTHERS. OTHER PATENTS PENDING (2008)

REV. NO.	DATE	BY	DESCRIPTION
1	20 AUG 21	AH	UPDATED WALL LAYOUT PER NV5

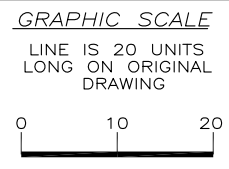

PROJ. MGR.
HKH
ENGINEER
CADD BY
AH

HILFIKER RETAINING WALLS

1902 Hilfiker Lane
Eureka, CA 95503-5711
TOLL-FREE 800.762.8962
PH 707.443.5093 FAX 707.443.2891
WEBSITE www.hilfiker.com E-MAIL info@hilfiker.com

DWG DATE
2 JUN 21
REVISION DATE
20 AUG 21
SCALE
NOTED

SHOP DRAWINGS
WELDED WIRE WALL WITH ARTWELD GABIONS
BASE TO BASE GONDOLA, KT-22
SIERRA NEVADA CONSTRUCTION INC.
LAKE TAHOE, CALIFORNIA
PLAN VIEW

PROJECT NO.
210322BW
SHEET
1
OF 6

8'	24'	16'	16'	24'	8'	8'	8'	8'	8'	8'	16'	8'	16'	16'	32'	16'	16'	8'	8'	8'	8'	8'
H=10' B1=9.00' B2=8.75'	H=10' B1=9.00' B2=8.75'	H=12' B1=9.00' B2=8.75'	H=14' B1=11.00' B2=10.50'	H=16' B1=12.00' B2=12.25'	H=18' B1=14.00' B2=14.00'	H=11' B1=9.00' B2=8.75'	H=13' B1=11.00' B2=10.50'	H=15' B1=12.00' B2=12.25'	H=19' B1=14.00' B2=14.00'	H=28' B1=21.00' B2=21.00' B3=12.25'	H=30' B1=21.00' B2=21.00' B3=14.00'	H=20' B1=21.00' B2=21.00' B3=12.25'	H=26' B1=19.00' B2=19.25' B3=12.25'	H=24' B1=18.00' B2=17.50' B3=10.50'	H=22' B1=16.00' B2=15.75' B3=10.50'	H=20' B1=14.00' B2=14.00' B3=10.50'	H=18' B1=14.00' B2=14.00'	H=16' B1=12.00' B2=12.25'	H=14' B1=9.00' B2=8.75'	H=12' B1=9.00' B2=8.75'	H=10' B1=9.00' B2=8.75'	H=8' B1=9.00' B2=8.75'

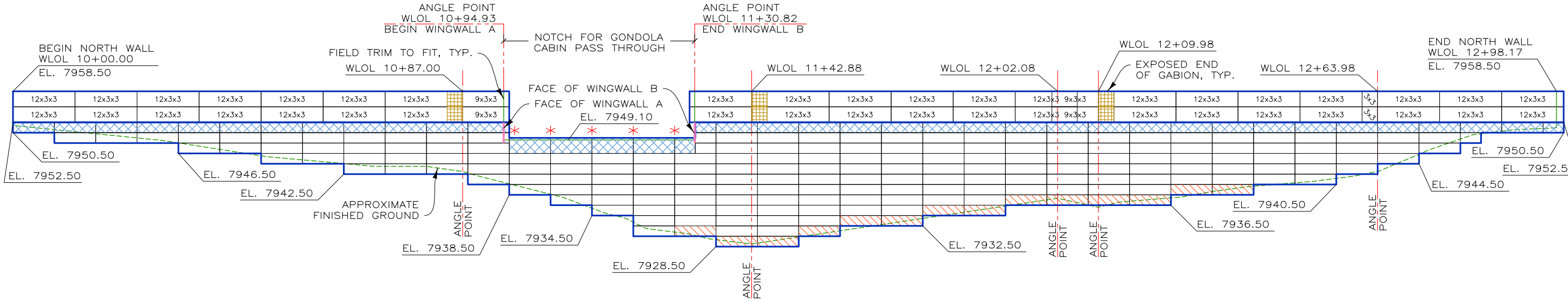

DEVELOPED ELEVATION - NORTH WALL
SCALE: 1" = 20'

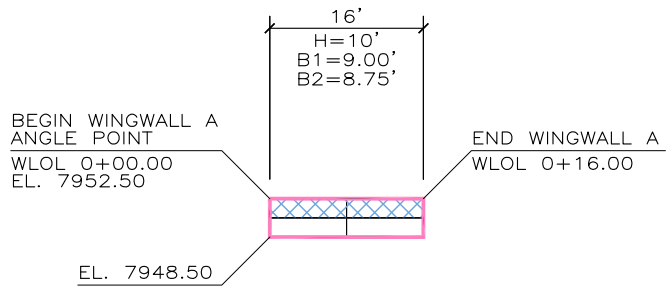

DEVELOPED ELEVATION - WINGWALL A
SCALE: 1" = 20'

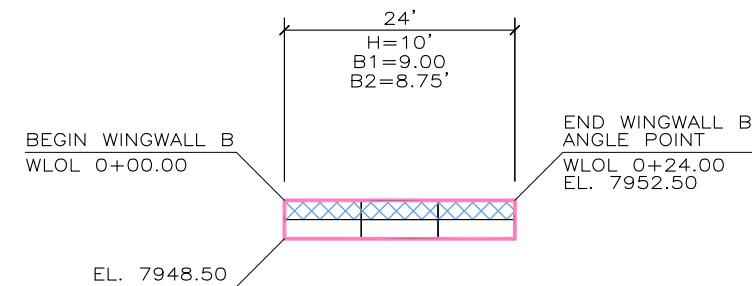

DEVELOPED ELEVATION - WINGWALL B
SCALE: 1" = 20'

NOTE: * INDICATES THE APPROXIMATE LOCATION OF THE MIDDLE OF EACH 3' BACKING MAT

MAT LEGEND:

- B1 8"x12" W7.0xW3.5 PRONGLESS AND CAP MATS
- B2 8"x21" W9.5xW4.0 STANDARD MATS
- B3 8"x21" W9.5xW4.0 STANDARD MATS

210322BW BASE TP BASE GONDOLA, KT-22

THIS DRAWING IS FURNISHED SOLELY FOR THE USE OF OR IN CONNECTION WITH THIS PROJECT AND THE PROPRIETARY INFORMATION SHOWN HEREON IS NOT TO BE TRANSMITTED TO ANY OTHER ORGANIZATION WITHOUT SPECIFIC AUTHORIZATION BY THE HILFIKER COMPANY. HILFIKER RETAINING WALLS ARE PROTECTED BY ONE OR MORE OF THE FOLLOWING PATENTS: 243,613; 243,697; 288,616; 4,117,686; 4,329,089; 4,324,508; 4,391,557; 4,505,621; 4,343,318; 4,661,023; 4,856,939; 4,929,125; 5,076,735; 5,647,695; 5,722,799; 5,733,072; 6,357,970B1; 6,874,975B2; 7,033,118B2; AND OTHERS. OTHER PATENTS PENDING (2008)

REV. NO.	DATE	BY	DESCRIPTION
1	20 AUG 21	AH	UPDATED WALL LAYOUT PER NV5

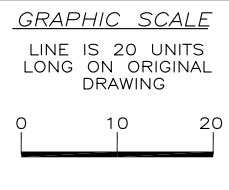

PROJ. MGR.
HKH
ENGINEER
CADD BY
AH

HILFIKER RETAINING WALLS

1902 Hilfiker Lane
Eureka, CA 95503-5711
TOLL-FREE 800.762.8962
PH 707.443.5093 FAX 707.443.2891
WEBSITE www.hilfiker.com E-MAIL info@hilfiker.com

SINCE 1902
QUALITY PRODUCTS

DWG DATE
2 JUN 21
REVISION DATE
20 AUG 21
SCALE
NOTED

SHOP DRAWINGS
WELDED WIRE WALL WITH ARTWELD GABIONS
BASE TO BASE GONDOLA, KT-22
SIERRA NEVADA CONSTRUCTION INC.
LAKE TAHOE, CALIFORNIA
ELEVATION VIEW

PROJECT NO.
210322BW
SHEET
2
OF 6

210322BW BASE TP BASE GONDOLA, KT-22

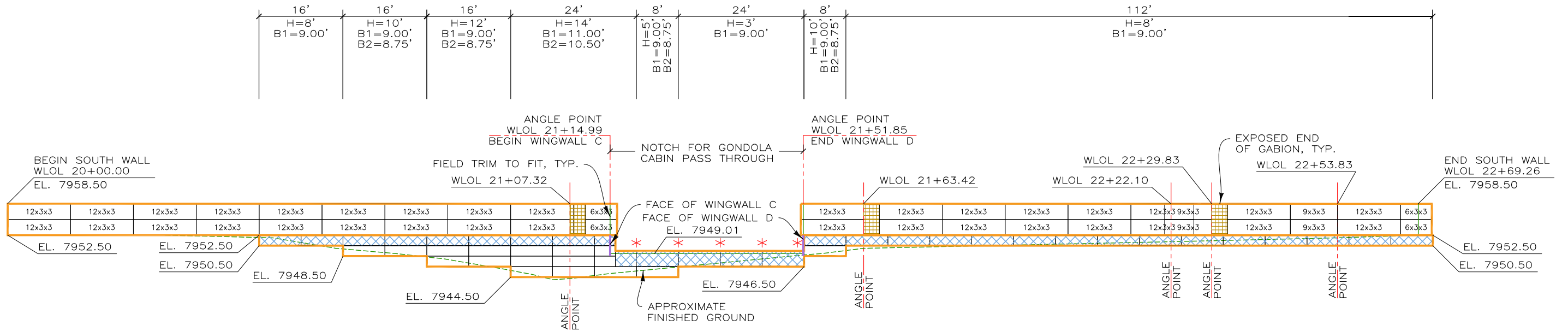

DEVELOPED ELEVATION - SOUTH WALL
SCALE: 1" = 20'

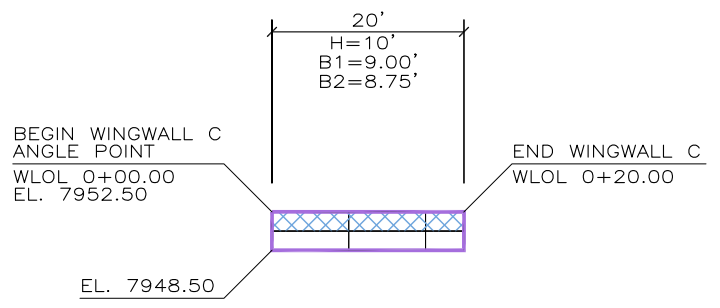

DEVELOPED ELEVATION - WINGWALL C
SCALE: 1" = 20'

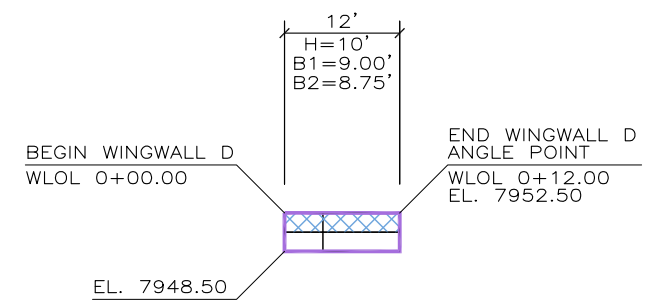

DEVELOPED ELEVATION - WINGWALL D
SCALE: 1" = 20'

NOTE: * INDICATES THE APPROXIMATE LOCATION OF THE MIDDLE OF EACH 3' BACKING MAT

MAT LEGEND:

- B1 8"x12" W7.0xW3.5 PRONGLESS AND CAP MATS
- B2 8"x21" W9.5xW4.0 STANDARD MATS
- B3 8"x21" W9.5xW4.0 STANDARD MATS

THIS DRAWING IS FURNISHED SOLELY FOR THE USE OF OR IN CONNECTION WITH THIS PROJECT AND THE PROPRIETARY INFORMATION SHOWN HEREON IS NOT TO BE TRANSMITTED TO ANY OTHER ORGANIZATION WITHOUT SPECIFIC AUTHORIZATION BY THE HILFIKER COMPANY. HILFIKER RETAINING WALLS ARE PROTECTED BY ONE OR MORE OF THE FOLLOWING PATENTS: 243,613; 243,697; 288,616; 4,117,686; 4,329,089; 4,324,508; 4,391,557; 4,505,621; 4,343,318; 4,661,023; 4,856,939; 4,929,125; 5,076,735; 5,647,695; 5,722,799; 5,733,072; 6,357,970B1; 6,874,975B2; 7,033,118B2; AND OTHERS. OTHER PATENTS PENDING (2008)

REV. NO.	DATE	BY	DESCRIPTION
1	20 AUG 21	AH	UPDATED WALL LAYOUT PER NV5

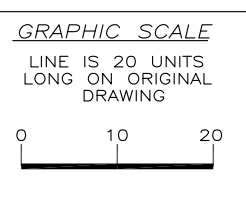

PROJ. MGR.
HKH
ENGINEER
CADD BY
AH

HILFIKER RETAINING WALLS

1902 Hilfiker Lane
Eureka, CA 95503-5711
TOLL-FREE 800.762.8962
PH 707.443.5093 FAX 707.443.2891
WEBSITE www.hilfiker.com E-MAIL info@hilfiker.com

DWG DATE
2 JUN 21
REVISION DATE
20 AUG 21
SCALE
NOTED

SHOP DRAWINGS
WELDED WIRE WALL WITH ARTWELD GABIONS
BASE TO BASE GONDOLA, KT-22
SIERRA NEVADA CONSTRUCTION INC.
LAKE TAHOE, CALIFORNIA
ELEVATION VIEW

PROJECT NO.
210322BW
SHEET
3
OF 6

210322BW | BASE TP BASE GONDOLA, KT-22

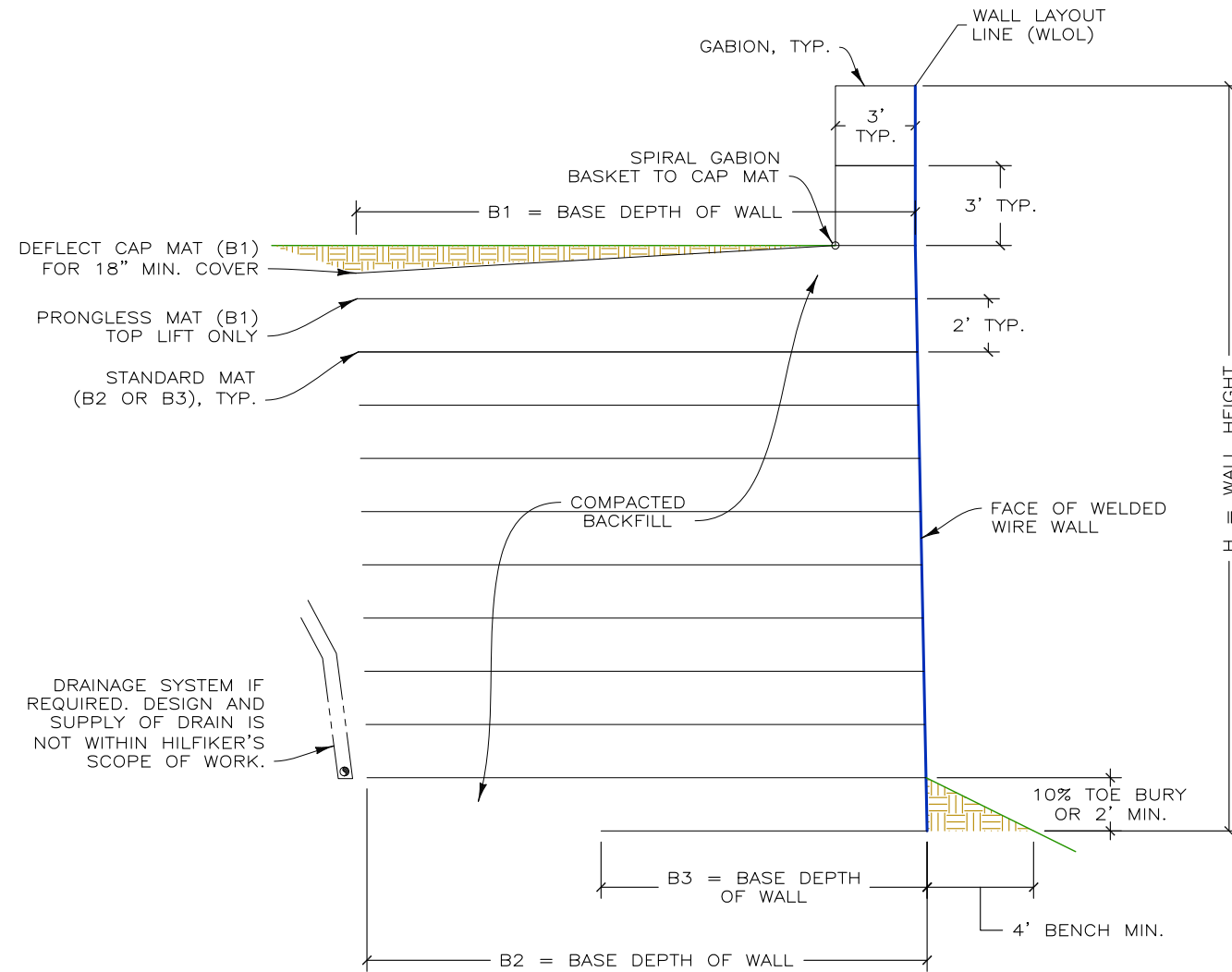

TYPICAL WELDED WIRE WALL WITH ARTWELD GABION SECTION
SCALE: 3" = 20'

PROJECT-SPECIFIC NOTES:

1. REFERENCE DRAWINGS: BASED OFF DRAWINGS FROM SQUAW VALLEY/ ALPINE MEADOWS BY PSOMAS. SHEETS CS502 & CG101 USED. DATED 05/21/2021.
2. BLACK AND WHITE REPRODUCTION OF THIS COLOR ORIGINAL MAY REDUCE ITS EFFECTIVENESS AND LEAD TO INCORRECT INTERPRETATION.
3. IT IS ASSUMED THAT ALL MATERIALS, BACKFILL AND CONSTRUCTION METHODS FOR HILFIKER M.S.E. WALLS AND GABION WALLS WILL CONFORM TO HILFIKER'S SPECIFICATIONS AND/OR THOSE OF THE HILFIKER ENGINEERING CONSULTANT.
4. THIS IS NOT AN ENGINEERED SUBMITTAL. ALL INFORMATION HEREON IS DERIVED FROM THE REFERENCE DRAWINGS, AND IS SUBJECT TO GEOMETRIC AND GEOTECHNICAL CONFIRMATION. THE APPLICABLE HILFIKER CONSTRUCTION GUIDE AND SPECIFICATIONS ARE AN INTEGRAL PART OF THIS SUBMITTAL.
5. HILFIKER RETAINING WALLS IS NOT RESPONSIBLE FOR THE INTERNAL STABILITY OF THE RETAINING WALL, OR FOR GLOBAL STABILITY OR FOUNDATION BEARING CAPACITY. THE OWNER/CONTRACTOR SHALL BE RESPONSIBLE FOR ALL JOB SITE DRAINAGE, SAFETY AND FALL PROTECTION PROVISIONS FOR WORKERS IN COMPLIANCE WITH OSHA AND ANY OTHER APPLICABLE REQUIREMENTS.
6. WALL DESIGN SHALL REQUIRE A NON-SATURATED BACKFILL. SURFACE AND SUBSURFACE DRAINAGE CONTROL MAY BE REQUIRED TO PREVENT SATURATION OF THE BACKFILL OR TO RELIEVE HYDROSTATIC PRESSURES. DRAINAGE CONTROL SHALL BE AS SPECIFIED IN THE OWNER'S PROJECT PLANS AND SPECIFICATIONS, OR AS DIRECTED BY THE OWNER'S ENGINEER.

THIS DRAWING IS FURNISHED SOLELY FOR THE USE OF OR IN CONNECTION WITH THIS PROJECT AND THE PROPRIETARY INFORMATION SHOWN HEREON IS NOT TO BE TRANSMITTED TO ANY OTHER ORGANIZATION WITHOUT SPECIFIC AUTHORIZATION BY THE HILFIKER COMPANY. HILFIKER RETAINING WALLS ARE PROTECTED BY ONE OR MORE OF THE FOLLOWING PATENTS: 243,613; 243,697; 288,616; 4,117,686; 4,329,089; 4,324,508; 4,391,557; 4,505,621; 4,343,318; 4,661,023; 4,856,939; 4,929,125; 5,076,735; 5,647,695; 5,722,799; 5,733,072; 6,357,970B1; 6,874,975B2; 7,033,118B2; AND OTHERS. OTHER PATENTS PENDING (2008)

REV.NO.	DATE	BY	DESCRIPTION
1	20 AUG 21	AH	UPDATED WALL LAYOUT PER NV5

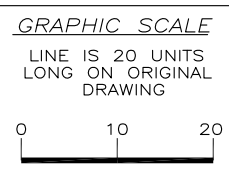

PROJ. MGR.
HKH
ENGINEER
CADD BY
AH

HILFIKER RETAINING WALLS

1902 Hilfiker Lane
Eureka, CA 95503-5711
TOLL-FREE 800.762.8962
PH 707.443.5093 FAX 707.443.2891
WEBSITE www.hilfiker.com E-MAIL info@hilfiker.com

DWG DATE
2 JUN 21
REVISION DATE
20 AUG 21
SCALE
NOTED

SHOP DRAWINGS
WELDED WIRE WALL WITH ARTWELD GABIONS
BASE TO BASE GONDOLA, KT-22
SIERRA NEVADA CONSTRUCTION INC.
LAKE TAHOE, CALIFORNIA
TYPICAL SECTION AND NOTES

PROJECT NO.
210322BW
SHEET
4
OF 6

STEP 1
PLACE THE FIRST COURSE OF SOIL REINFORCEMENT MATS ON PREPARED FOUNDATION

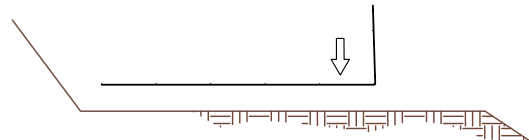

STEP 2
PLACE THE BACKING MAT AGAINST THE INSIDE FACE OF THE SOIL REINFORCEMENT MAT. CLIP THE SECOND-TO-TOP TRANSVERSE WIRE ON THE BACKING MAT TO THE TOP TRANSVERSE WIRE ON THE SOIL REINFORCEMENT MAT.

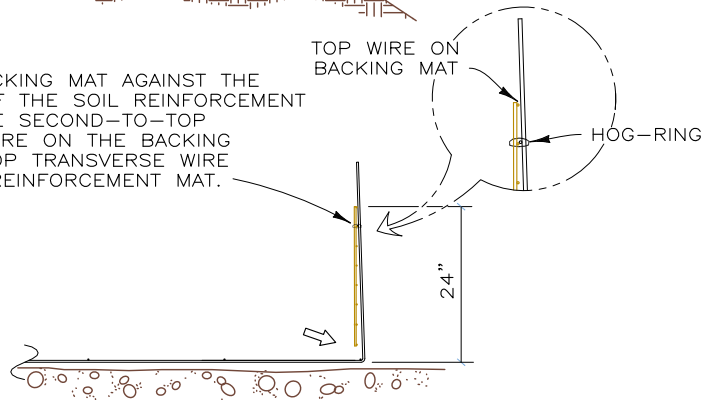

STEP 3
PLACE AND COMPACT THE BACKFILL IN LAYERS AND DENSITIES AS SPECIFIED IN THE PROJECT PLANS. LEAVE A VOID AT THE FACE AS SHOWN.

PLACE THE SECOND COURSE OF SOIL REINFORCEMENT MATS WITH THE BASE LONGITUDINAL WIRES RESTING ON THE TOP TRANSVERSE WIRE OF THE BACKING MAT BELOW. SLIDE THE SOIL REINFORCEMENT MAT INTO ALIGNMENT.

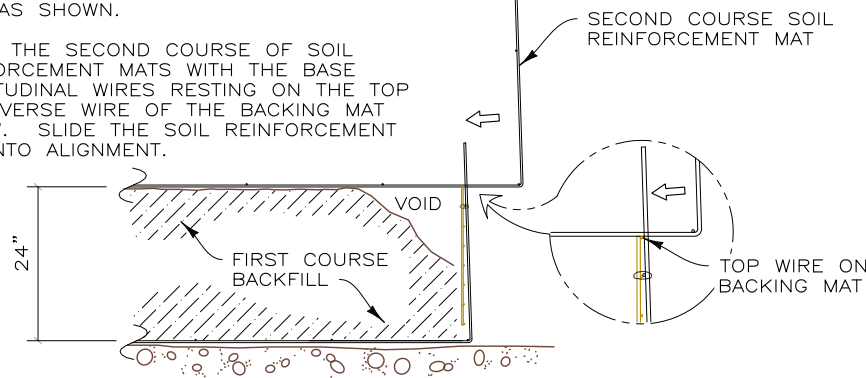

CONSTRUCTION SEQUENCE
NOT TO SCALE

STEP 4
HOOK THE BOTTOM TRANSVERSE WIRE OF THE BACKING MAT OVER THE VERTICAL PRONGS ON THE LOWER MAT. ROTATE THE BACKING MAT TO VERTICAL AND CLIP THE SECOND-TO-TOP TRANSVERSE WIRE ON THE BACKING MAT TO THE TOP WIRE ON THE SOIL REINFORCEMENT MAT.

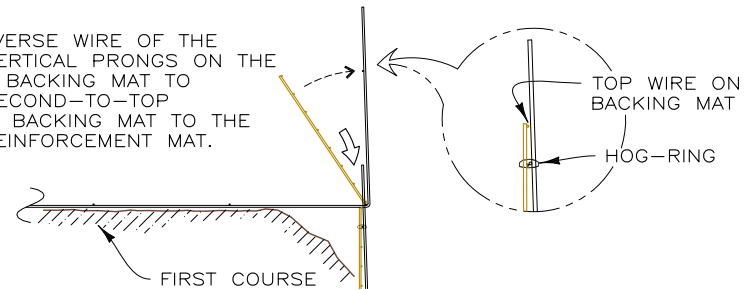

STEP 5
PLACE AND COMPACT THE BACKFILL TO THE BASE ELEVATION OF THE NEXT MAT. REPEAT STEPS 3 THROUGH 5 TO THE TOP LIFT.

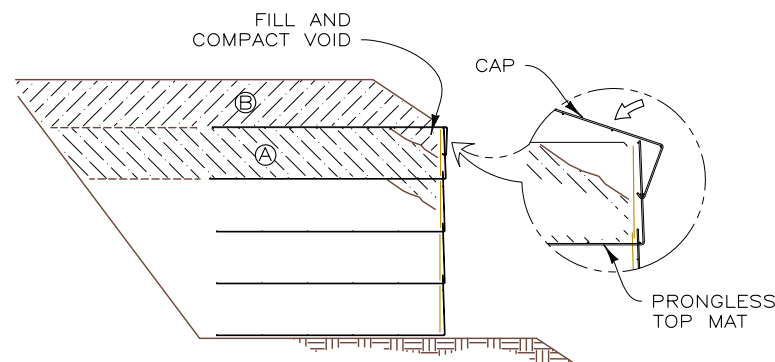
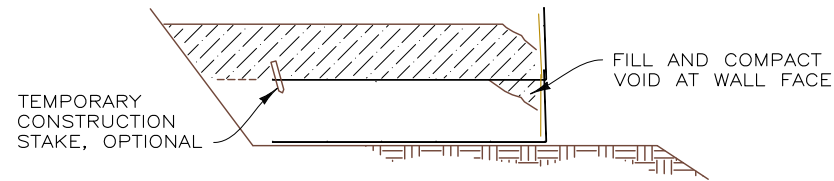

STEP 6: TOP LIFT
PLACE THE TOP LIFT PRONGLESS MAT AND BACKING MAT. PLACE AND COMPACT BACKFILL IN AREA "A". HOOK THE CAP OVER THE MIDDLE TRANSVERSE WIRE ON THE PRONGLESS MAT, AND ROTATE INTO PLACE. BACKFILL "B" TO 1'-6" MIN. COVER OVER THE CAP.

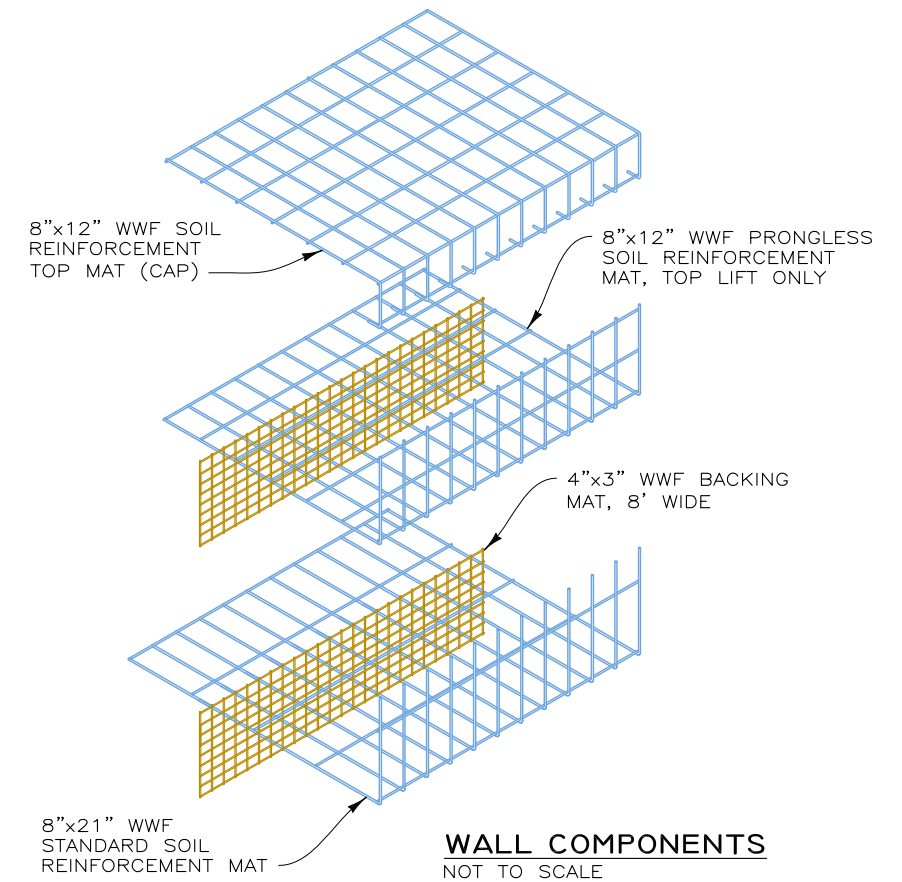

CUT THE TRANSVERSE WIRES ON THE BASE OF THE MATS AND BEND THE FACE OF THE MATS TO THE REQUIRED ANGLE. OVERLAP THE BASE OF THE MATS.

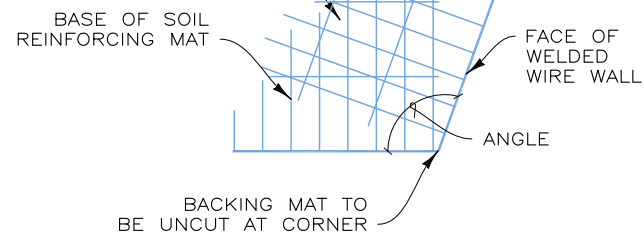

PLAN VIEW
OBTUSE CONVEX ANGLE
NOT TO SCALE

CUT THE TRANSVERSE WIRES BEHIND FACE AND BEND THE FACING WIRES TO FORM THE REQUIRED ANGLE. BACKING MAT TO BE UN CUT AT CORNER

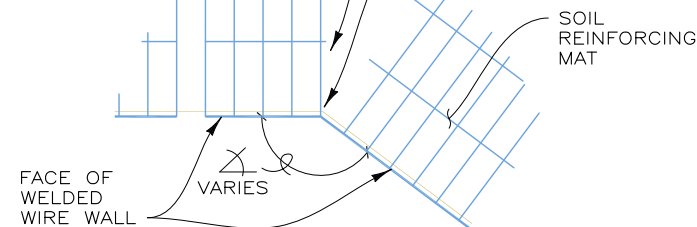

PLAN VIEW
CONCAVE ANGLE DETAIL
NOT TO SCALE

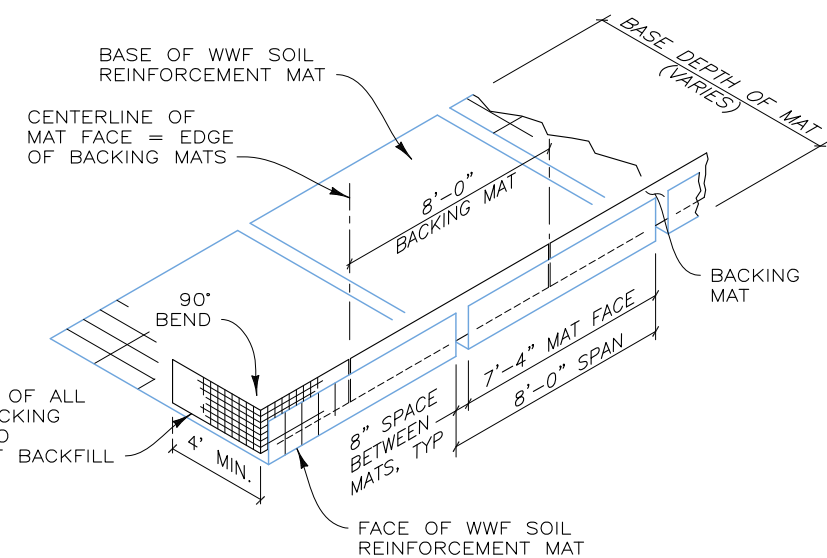

ISOMETRIC VIEW
WELDED WIRE WALL COMPONENTS WITH RETURN MAT
NOT TO SCALE

210322BW BASE TP BASE GONDOLA, KT-22

THIS DRAWING IS FURNISHED SOLELY FOR THE USE OF OR IN CONNECTION WITH THIS PROJECT AND THE PROPRIETARY INFORMATION SHOWN HEREON IS NOT TO BE TRANSMITTED TO ANY OTHER ORGANIZATION WITHOUT SPECIFIC AUTHORIZATION BY THE HILFIKER COMPANY. HILFIKER RETAINING WALLS ARE PROTECTED BY ONE OR MORE OF THE FOLLOWING PATENTS: 243,613; 243,697; 288,616; 4,117,686; 4,329,089; 4,324,508; 4,391,557; 4,505,621; 4,343,318; 4,661,023; 4,856,939; 4,929,125; 5,076,735; 5,647,695; 5,722,799; 5,733,072; 6,357,970B1; 6,874,975B2; 7,033,118B2; AND OTHERS. OTHER PATENTS PENDING (2008)

REV.NO.	DATE	BY	DESCRIPTION
1	20 AUG 21	AH	UPDATED WALL LAYOUT PER NV5

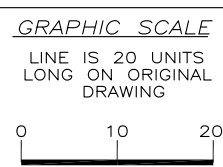

PROJ. MGR.
HKH
ENGINEER
CADD BY
AH

HILFIKER RETAINING WALLS

1902 Hilfiker Lane
Eureka, CA 95503-5711
TOLL-FREE 800.762.8962
PH 707.443.5093 FAX 707.443.2891
WEBSITE www.hilfiker.com E-MAIL info@hilfiker.com

SINCE 1902
QUALITY PRODUCTS

DWG DATE
2 JUN 21
REVISION DATE
20 AUG 21
SCALE
NOTED

SHOP DRAWINGS
WELDED WIRE WALL WITH ARTWELD GABIONS
BASE TO BASE GONDOLA, KT-22
SIERRA NEVADA CONSTRUCTION INC.
LAKE TAHOE, CALIFORNIA
WELDED WIRE WALL DETAILS

PROJECT NO.
210322BW
SHEET
5
OF 6

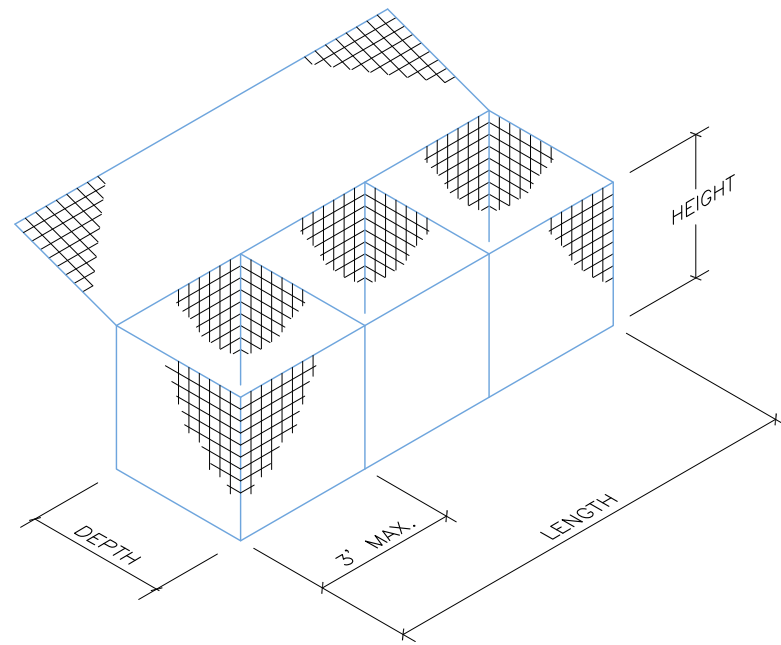

TYPICAL GABION
NOT TO SCALE

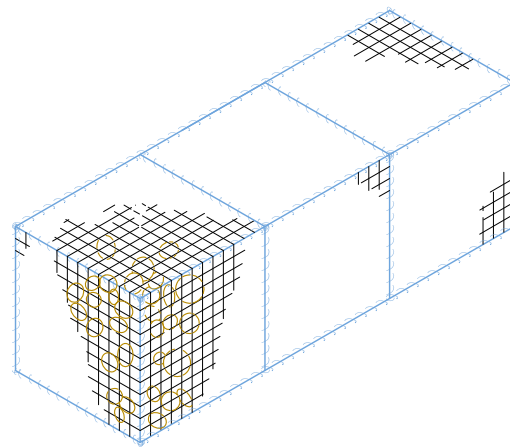

TYPICAL ASSEMBLED GABION
NOT TO SCALE

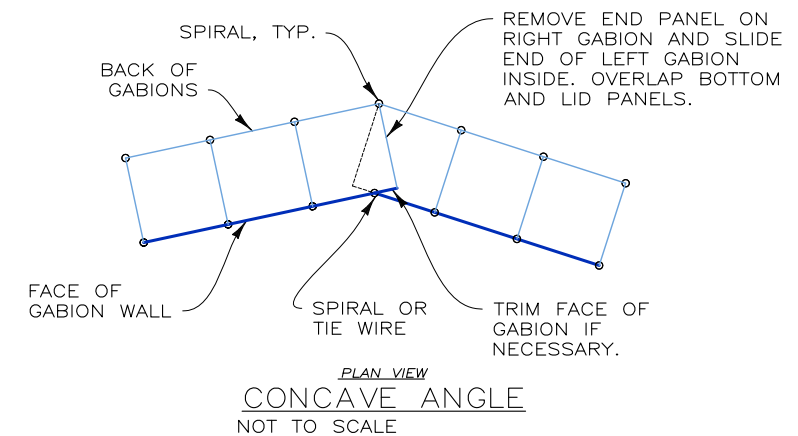

PLAN VIEW
CONCAVE ANGLE
NOT TO SCALE

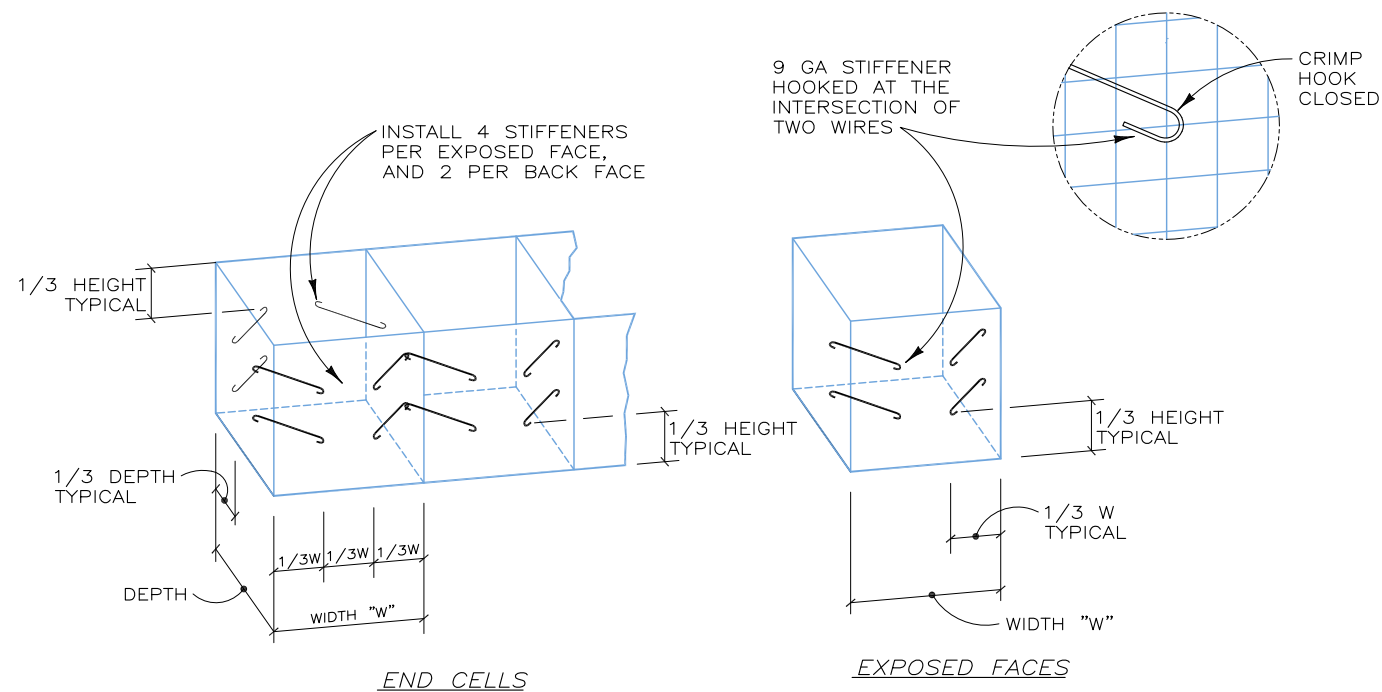

STIFFENER DETAILS
NOT TO SCALE

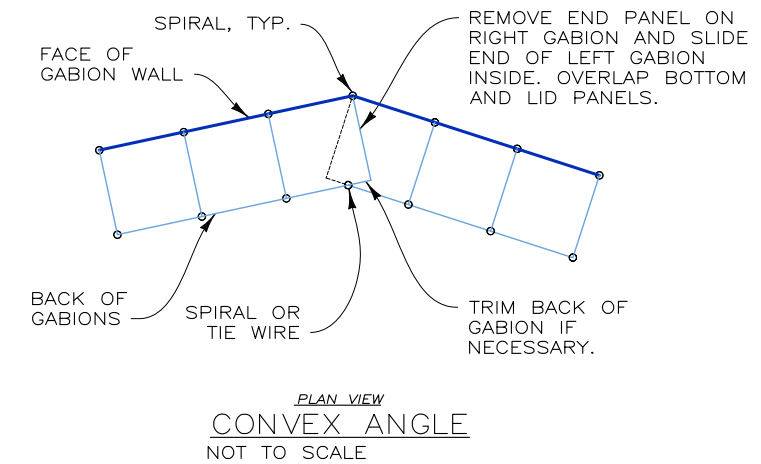

PLAN VIEW
CONVEX ANGLE
NOT TO SCALE

WHERE HEIGHT OF GABION IS 2' OR LESS, INSTALL 2 STIFFENERS PER FACE
WHERE HEIGHT IS 12", NO STIFFENERS REQUIRED

210322BW BASE TP BASE GONDOLA, KT-22

THIS DRAWING IS FURNISHED SOLELY FOR THE USE OF OR IN CONNECTION WITH THIS PROJECT AND THE PROPRIETARY INFORMATION SHOWN HEREON IS NOT TO BE TRANSMITTED TO ANY OTHER ORGANIZATION WITHOUT SPECIFIC AUTHORIZATION BY THE HILFIKER COMPANY. HILFIKER RETAINING WALLS ARE PROTECTED BY ONE OR MORE OF THE FOLLOWING PATENTS: 243,613; 243,697; 288,616; 4,117,686; 4,329,089; 4,324,508; 4,391,557; 4,505,821; 4,343,318; 4,661,023; 4,856,939; 4,929,125; 5,076,735; 5,647,695; 5,722,799; 5,733,072; 6,357,970B1; 6,874,975B2; 7,033,118B2; AND OTHERS. OTHER PATENTS PENDING (2008)

REV.NO.	DATE	BY	DESCRIPTION
1	20 AUG 21	AH	UPDATED WALL LAYOUT PER NV5

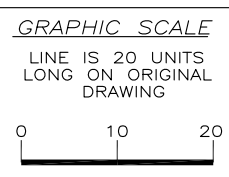

PROJ. MGR.
HKH
ENGINEER
CADD BY
AH

HILFIKER RETAINING WALLS

1902 Hilfiker Lane
Eureka, CA 95503-5711
TOLL-FREE 800.762.8962
PH 707.443.5093 FAX 707.443.2891
WEBSITE www.hilfiker.com E-MAIL Info@hilfiker.com

DWG DATE	2 JUN 21
REVISION DATE	20 AUG 21
SCALE	NOTED

SHOP DRAWINGS
WELDED WIRE WALL WITH ARTWELD GABIONS
BASE TO BASE GONDOLA, KT-22
SIERRA NEVADA CONSTRUCTION INC.
LAKE TAHOE, CALIFORNIA
ARTWELD GABION DETAILS

PROJECT NO.
210322BW
SHEET
6
OF 6