

STEP 1

INSTALL STANDARD
MATS AS DETAILED IN HRW
CONSTRUCTION SEQUENCE

STEP 2

INSTALL SPECIAL
ANGLED MAT

WALL LAYOUT
LINE

STEP 5

INSTALL BACKING MATS
AND FILTER FABRIC

STEP 3

INSTALL SPECIAL
ANGLED MAT

STEP 4

CONTINUE INSTALLING
STANDARD MATS

STEP 6

INSTALL BACKING MAT
BAFFLES WITH SPIRALS TO FACE
OF THE SPECIAL ANGLED MATS AT
2 FOOT SPACING FROM ANGLE POINT

*NOTE: SEE BACKING MAT BAFFLE
DETAIL FOR MORE INFORMATION

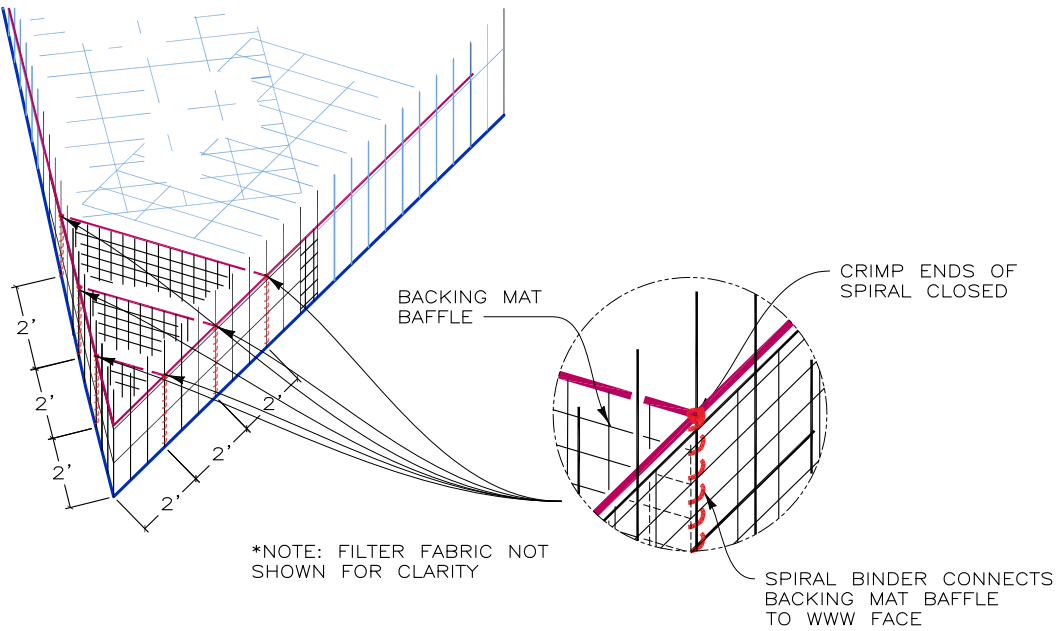

PICTORIAL
BACKING MAT BAFFLE DETAIL
NOT TO SCALE

THIS DRAWING IS FURNISHED SOLELY FOR THE USE OF OR IN CONNECTION WITH THIS PROJECT AND THE PROPRIETARY INFORMATION SHOWN HEREON IS NOT TO BE TRANSMITTED TO ANY OTHER ORGANIZATION WITHOUT SPECIFIC AUTHORIZATION BY THE HILFIKER COMPANY. HILFIKER RETAINING WALLS ARE PROTECTED BY ONE OR MORE OF THE FOLLOWING PATENTS: 243,613; 243,697; 288,616; 4,117,686; 4,329,089; 4,324,508; 4,391,557; 4,505,621; 4,343,318; 4,661,023; 4,856,939; 4,929,125; 5,076,735; 5,647,695; 5,722,799; 5,733,072; 6,357,970B1; 6,874,975B2; 7,033,118B2; AND OTHERS. OTHER PATENTS PENDING (2008)

REV.NO.	DATE	BY	DESCRIPTION
1	4/15/02	DR	REVISED BORDER
2	10/25/06	KJ	REV. COIL ROD
3	20 OCT 08	AMJ	UPDATED BORDER, MINOR REVISIONS
4	26 FEB 21	AH	ADDED ACUTE ANGLE MAT DETAILS

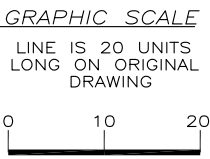

PROJ.MGR.

ENGINEER

CADD BY
HRW

HILFIKER RETAINING WALLS

1902 Hilfiker Lane
Eureka, CA 95503-5711
TOLL-FREE 800.762.8962
PH 707.443.5093 FAX 707.443.2891
WEBSITE www.hilfiker.com E-MAIL info@hilfiker.com

DWG DATE
31 AUG 00

REVISION DATE
20 OCT 08

SCALE
NOTED

STANDARD DRAWING	PROJECT NO.
EUREKA REINFORCED SOIL EMBANKMENT WITH C.I.P. FACE	SHEET 2
DETAILS	OF 3

ERS CIP 8x21 STANDARD DETAILS

STEP 7

INSTALL STANDARD MAT
FOR BULL NOSE 2' FROM
BACKING MAT BAFFLE

BACKING MAT BAFFLE

2'

STEP 8

INSTALL BACKING MATS
AND FILTER FABRIC

2'

STEP 9

PLACE AND COMPACT THE
BACKFILL IN LAYERS AND
DENSITIES AS SPECIFIED IN
THE PROJECT PLANS.
LEAVE A VOID AT THE FACE
AS SHOWN IN HRW STANDARD
CONSTRUCTION SEQUENCE

STEP 10

PLACE FILL IN BULL NOSE AREA
WITH SELF CONSOLIDATING BACKFILL

STEP 11

ONCE BACKFILL HAS BEEN PLACED
REPEAT STEPS 1-10 TO TOP OF WALL.
REFER TO HILFIKER STANDARD CONSTRUCTION SEQUENCE
FOR DETAILS ON INTERLOCKING BACKING MATS AND
INSTALLING PRONGLESS MATS.

THIS DRAWING IS FURNISHED SOLELY FOR
THE USE OF OR IN CONNECTION WITH THIS
PROJECT AND THE PROPRIETARY INFORMATION
SHOWN HEREON IS NOT TO BE TRANSMITTED
TO ANY OTHER ORGANIZATION WITHOUT
SPECIFIC AUTHORIZATION BY THE HILFIKER
COMPANY. HILFIKER RETAINING WALLS ARE
PROTECTED BY ONE OR MORE OF THE FOLLOWING
PATENTS: 243,613; 243,697; 288,616; 4,117,686;
4,329,089; 4,324,508; 4,391,557; 4,505,621;
4,343,318; 4,661,023; 4,856,939; 4,929,125;
5,076,735; 5,647,695; 5,722,799; 5,733,072;
6,357,970B1; 6,874,975B2; 7,033,118B2;
AND OTHERS. OTHER PATENTS PENDING (2008)

REV.NO.	DATE	BY	DESCRIPTION
1	4/15/02	DR	REVISED BORDER
2	10/25/06	KJ	REV. COIL ROD
3	20 OCT 08	AMJ	UPDATED BORDER, MINOR REVISIONS
4	26 FEB 21	AH	ADDED ACUTE ANGLE MAT DETAILS

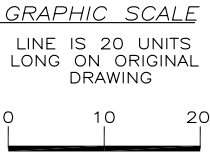

PROJ.MGR.

ENGINEER

CADD BY
HRW

HILFIKER RETAINING WALLS

1902 Hilfiker Lane
Eureka, CA 95503-5711
TOLL-FREE 800.762.8962
PH 707.443.5093 FAX 707.443.2891
WEBSITE www.hilfiker.com E-MAIL info@hilfiker.com

DWG DATE 31 AUG 00
REVISION DATE 20 OCT 08
SCALE NOTED

STANDARD DRAWING	PROJECT NO.
EUREKA REINFORCED SOIL EMBANKMENT WITH C.I.P. FACE	SHEET 3
DETAILS	OF 3