

CURTIS ROAD

KEY PLAN

GRAPHIC SCALE

DESIGN NOTES

- DESIGN IS BASED ON THE ASSUMPTION THAT BACKFILL WITHIN THE REINFORCED SOIL MASS, METHODS OF CONSTRUCTION AND THE QUALITY OF MATERIALS CONFORM TO THE REQUIREMENTS OF HILFIKER RETAINING WALLS.
- ASSUMED SOIL CHARACTERISTICS:
 WALL BACKFILL (CONTRACTOR TO VERIFY BY TEST):
 TOTAL UNIT WEIGHT: 130 PCF
 INTERNAL FRICTION ANGLE: 34° (ASTM D3080)
 COHESION: 0 PSF
 RETAINED BACKFILL:
 TOTAL UNIT WEIGHT: 125 PCF
 INTERNAL FRICTION ANGLE: 36°
 COHESION: 0 PSF
 FOUNDATION SOILS:
 TOTAL UNIT WEIGHT: 110 PCF
 INTERNAL FRICTION ANGLE: 33°
 COHESION: 0 PSF
 SEISMIC ACCELERATION: 0.085g PGA
 IF ACTUAL CHARACTERISTICS, GRADES OR DIMENSIONS OF SOIL MATERIALS DIFFER FROM THOSE LISTED ABOVE OR SHOWN ON THE PLANS, HILFIKER RETAINING WALLS SHALL BE NOTIFIED TO EVALUATE THE NEED TO REDESIGN.
- THE SOLE VERTICAL SCENARIOS CONSIDERED IN THIS SUBMITTAL ARE THE FOLLOWING:
 A. PUBLIC VEHICULAR TRAFFIC OR LIGHT CONSTRUCTION EQUIPMENT, SUCH AS A SMALL BACKHOE.
 B. NO TEMPORARY EARTHWORK SURCHARGE IS ALLOWED WITHIN A SETBACK DISTANCE FROM FACE OF RSE WALL EQUAL TO 1.5 TIMES THE HEIGHT OF THE WALL.
 C. CONCRETE SIDEWALK AND RAILING.
- THE MAXIMUM RSE WALL FOUNDATION CONTACT STRESS FOR THIS SUBMITTAL IS 2848 LB/FT² FOR A RSE WALL HEIGHT OF 10 FT.
- THE DESIGN REQUIRES A NON-SATURATED BACKFILL. SURFACE AND SUB-SURFACE DRAINAGE CONTROL MAY BE REQUIRED TO PREVENT SATURATION OF THE BACKFILL OR RELIEVE HYDROSTATIC PRESSURES.
 DRAINAGE CONTROL SHALL BE AS SPECIFIED IN THE PROJECT PLANS AND SPECIFICATIONS OR AS DIRECTED BY THE OWNER'S ENGINEER. PAYMENT FOR DRAINAGE SHALL BE AS SPECIFIED IN THE PROJECT SPECIFICATIONS.
- SOIL REINFORCEMENTS SHALL BE FABRICATED OF WELDED WIRE FABRIC CONFORMING TO AASHTO M-32 AND M-55 AND SHALL BE GALVANIZED IN ACCORDANCE WITH AASHTO M-111 FOLLOWING FABRICATION.
- THIS DESIGN SUBMITTAL IS BASED ON ASTM A1115 - STANDARD PRACTICE FOR CONSTRUCTION OF MECHANICALLY STABILIZED EARTH WALLS WITH INEXTENSIBLE SOIL REINFORCEMENT (LATEST APPROVAL).
- THIS IS A PERMANENT RSE WALL DESIGNED FOR 75 YEARS OF SERVICE. THE OWNER IS ACHD. THE CONTRACTOR IS COMPLIANCE SOLUTIONS AND CONTRACTING.
- THE CONTRACTOR IS RESPONSIBLE FOR ESTABLISHING THE RSE WALL LAYOUT LINE (LOL) FROM THE REFERENCE LINES AND LOCATIONS PROVIDED IN THE OWNER'S PLANS.
- THE CONTRACTOR ARRANGES FOR ON-SITE TECHNICAL ASSISTANCE FROM THE WALL SUPPLIER FOR THE FIRST SEVERAL DAYS OF WALL ERECTION AND IMPLEMENTS THE WALL SUPPLIER'S INSTALLATION GUIDE.
- AMERICAN GEOTECHNICS IS NOT THE OWNER'S "ENGINEER OF RECORD" OR THE OWNER'S "GEOTECHNICAL ENGINEER" OR THE OWNER'S "HYDRAULIC ENGINEER," AS DESCRIBED IN ASTM A1115. THE OWNER IS RESPONSIBLE FOR THE FOLLOWING:
 A. EVALUATING GLOBAL STABILITY
 B. ESTABLISHING FOUNDATION BEARING RESISTANCE DESIGN CRITERIA
 C. IMPLEMENTING AN ADEQUATE QUALITY CONTROL PROGRAM
- HILFIKER RETAINING WALLS, INC (800-762-8962) IS THE "WALL SUPPLIER" WHOSE SYSTEM AND COMPONENTS ARE THE SOLE BASIS OF THIS SUBMITTAL.
- AMERICAN GEOTECHNICS (208-658-8700) IS THE "WALL DESIGN ENGINEER," AS DESCRIBED IN ASTM A1115. AMERICAN GEOTECHNICS HAS SPECIFIED THE TYPE(S), SIZES, AND LOCATIONS OF BURIED REINFORCEMENTS FOR THIS SUBMITTAL.
- THE ENGINEER OF RECORD ADMINISTERS THE OWNER'S REQUIREMENTS FOR THE LONG-TERM STABILITY OF THE RSE WALL (RSEW), INCLUDING:
 A. FOUNDATION PREPARATION REQUIREMENTS OF THE GEOTECHNICAL ENGINEER
 B. INTERNAL DRAINAGE FEATURES ALONG TEMPORARY CUT SLOPES
 C. SCOUR COUNTERMEASURES ALONG THE TOE
 D. EROSION COUNTERMEASURES AT THE ENDS
 E. SURFACE WATER DRAINAGE CONTROLS ABOVE THE WALL
 F. CONSTRUCTION OF THE SUPPLIED RSEW SYSTEM WILL ALL OF ITS APPURTENANT COMPONENTS
- RSE WALL ERECTION DOES NOT COMMENCE UNTIL THE ENGINEER OF RECORD HAS ACCEPTED THE PREPARED FOUNDATION AND THE AGGREGATE SUBMITTED FOR THE BACKFILL.

| SUPPLIED REINFORCEMENT QUANTITIES | | |
|-----------------------------------|-------------------------------|---------------------------------------|
| BASE DEPTH | STANDARD MAT W9.5XW4 (8"X12") | INTERMEDIATE MAT W4.5XW3.5 (8"X10.5") |
| 14' | - | 5 |
| 13' | 5 | - |
| 12' | 8 | - |
| 11.375' | - | 20 |
| 11' | 29 | - |
| 10.5' | 17 | - |
| 9' | 43 | - |
| 10.5' | - | 9 |

| | |
|--------------------|----------|
| WALL FACE SUPPLIED | 1,223 SF |
| FILTER FABRIC | 330 LF |
| CONNECTION PIN | 102 EA |
| BEARING PAD | 30 EA |

THE DESIGN CONTAINED ON THESE DRAWINGS IS BASED ON INFORMATION PROVIDED BY THE OWNER. ON THE BASIS OF THIS INFORMATION, THE HILFIKER COMPANY HAS DESIGNED, AND IS RESPONSIBLE FOR THE INTERNAL STABILITY OF THE STRUCTURE ONLY. EXTERNAL STABILITY, INCLUDING FOUNDATION AND SLOPE STABILITY, IS THE RESPONSIBILITY OF THE OWNER.

| REV. | DATE | BY | DESCRIPTION |
|------|----------|-----|-------------------|
| 0 | 2/4/2021 | RGV | ISSUED FOR REVIEW |

CADD: RGV
 DESIGNED: RGV
 CHECKED: SGC

HILFIKER RETAINING WALLS

1902 HilfiKER Lane
 Eureka, CA 95603-5711
 TOLL-FREE 800.762.8962
 PH 707.443.3093 FAX 707.443.2891
 WEBSITE www.hilfiKER.com EMAIL info@hilfiKER.com

AMERICAN GEOTECHNICS

American Geotechnics
 5260 Chinden Blvd.
 Boise, ID 83714
 (208) 658-8700
 Fax: (208) 658-8703

KEY PLAN & DESIGN NOTES
 RSE WALL
 US 20/26 (CHINDEN BLVD)
 AND CURTIS RD
 ACHD GARDEN CITY, ID

DWG DATE: 4 FEB 2021
 HRW NO.: 210105AW
 SHEET 1 OF 6



03/03 - Chinden Blvd & Curtis Road Wall - ITPREPREPARED 2-4-2021.dwg

2/4/2021 10:53 AM

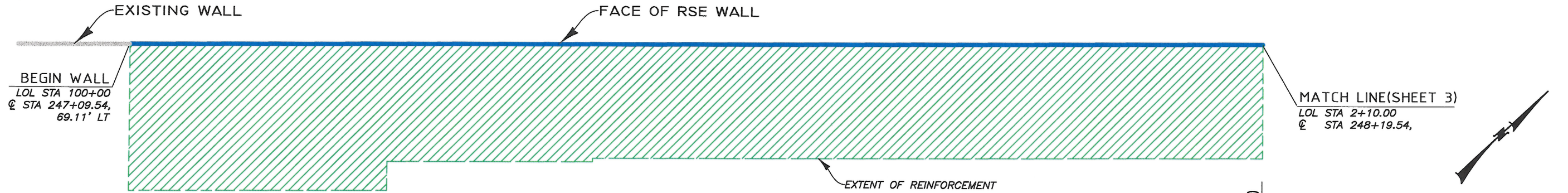

PLAN
GRAPHIC SCALE

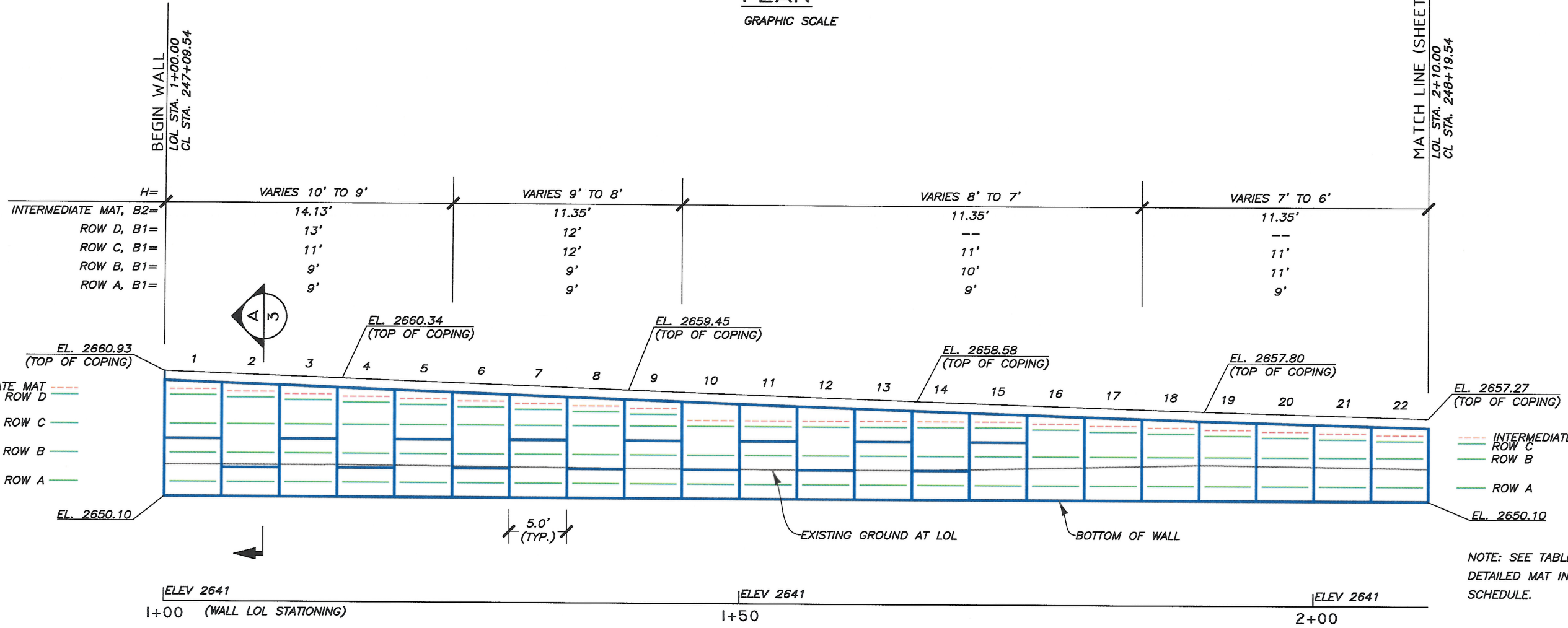
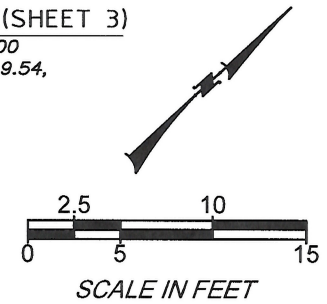

DEVELOPED ELEVATION (BACK FACE)
GRAPHIC SCALE

NOTE: SEE TABLE ON SHEET 6 FOR DETAILED MAT INSTALLATION SCHEDULE.

LEGEND

| | | |
|--|-----|--|
| | B1 | 8"x12", W9.5xW4-HDG (STANDARD MAT) |
| | B2 | 8"x10.5", W4.5xW3.5-HDG (INTERMEDIATE FLAT MAT, NO CONNECTION TO FACE) |
| | LOL | LAYOUT LINE |
| | H | HILFIKER WALL HEIGHT |
| | B | MAT LENGTH |
| | WW | WELDED WIRE |

| REV. | DATE | BY | DESCRIPTION | CADD: |
|------|----------|-----|-------------------|---------------|
| 0 | 2/4/2021 | RGV | ISSUED FOR REVIEW | RGV |
| | | | | DESIGNED: RGV |
| | | | | CHECKED: SGC |

HILFIKER RETAINING WALLS

1902 Hilfiker Lane
Eureka, CA 95503-5711
TOLL-FREE 800.762.8962
PH 707.443.5093 FAX 707.443.2891
WEB SITE www.hilfiker.com E-MAIL info@hilfiker.com

AMERICAN GEO TECHNICS

American Geotechnics
5260 Chinden Blvd.
Boise, ID 83714
(208) 658-8700
Fax: (208) 658-8703

| | |
|---------------------------------------|-----------------|
| PLAN & ELEVATION | |
| RSE WALL | |
| US 20/26 (CHINDEN BLVD) AND CURTIS RD | |
| ACHD | GARDEN CITY, ID |

| | |
|-----------|------------|
| DWG DATE: | 4 FEB 2021 |
| HRW NO.: | 210105AW |
| SHEET | 2 |
| OF | 6 |

PROFESSIONAL ENGINEER

2-4-21

15993

RYAN G. VAN LEUVEN

STATE OF IDAHO

08495 - Chinden Blvd & Curtis Road Wall (1) PREPARED 2-4-2021.dwg
2/4/2021 10:52 AM
R/VanLeuven

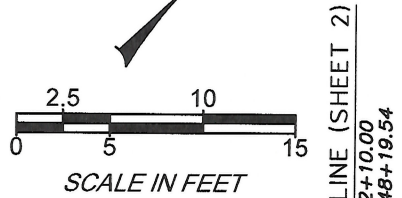
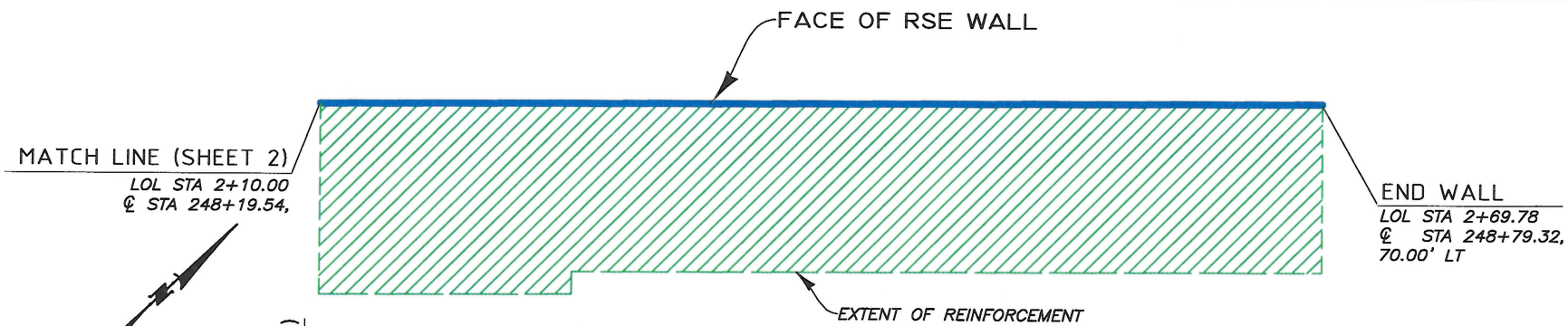

PLAN
GRAPHIC SCALE

| | | |
|-----------------------|-----------------|-----------------|
| H= | VARIES 7' TO 6' | VARIES 6' TO 5' |
| INTERMEDIATE MAT, B2= | 11.35' | 10' |
| ROW D, B1= | --- | --- |
| ROW C, B1= | 11' | --- |
| ROW B, B1= | 11' | 10' |
| ROW A, B1= | 9' | 9' |

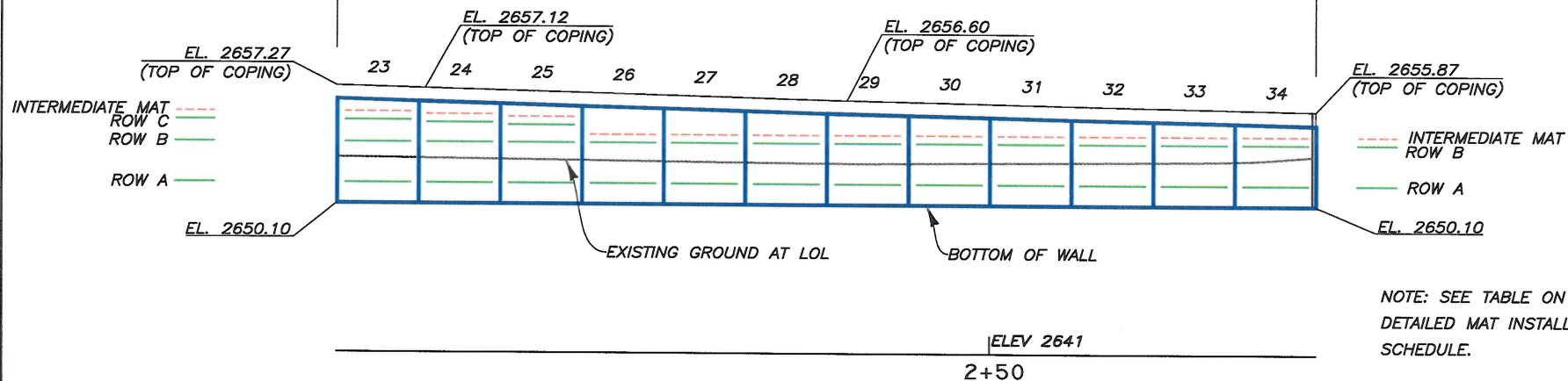

DEVELOPED ELEVATION (BACK FACE)
GRAPHIC SCALE

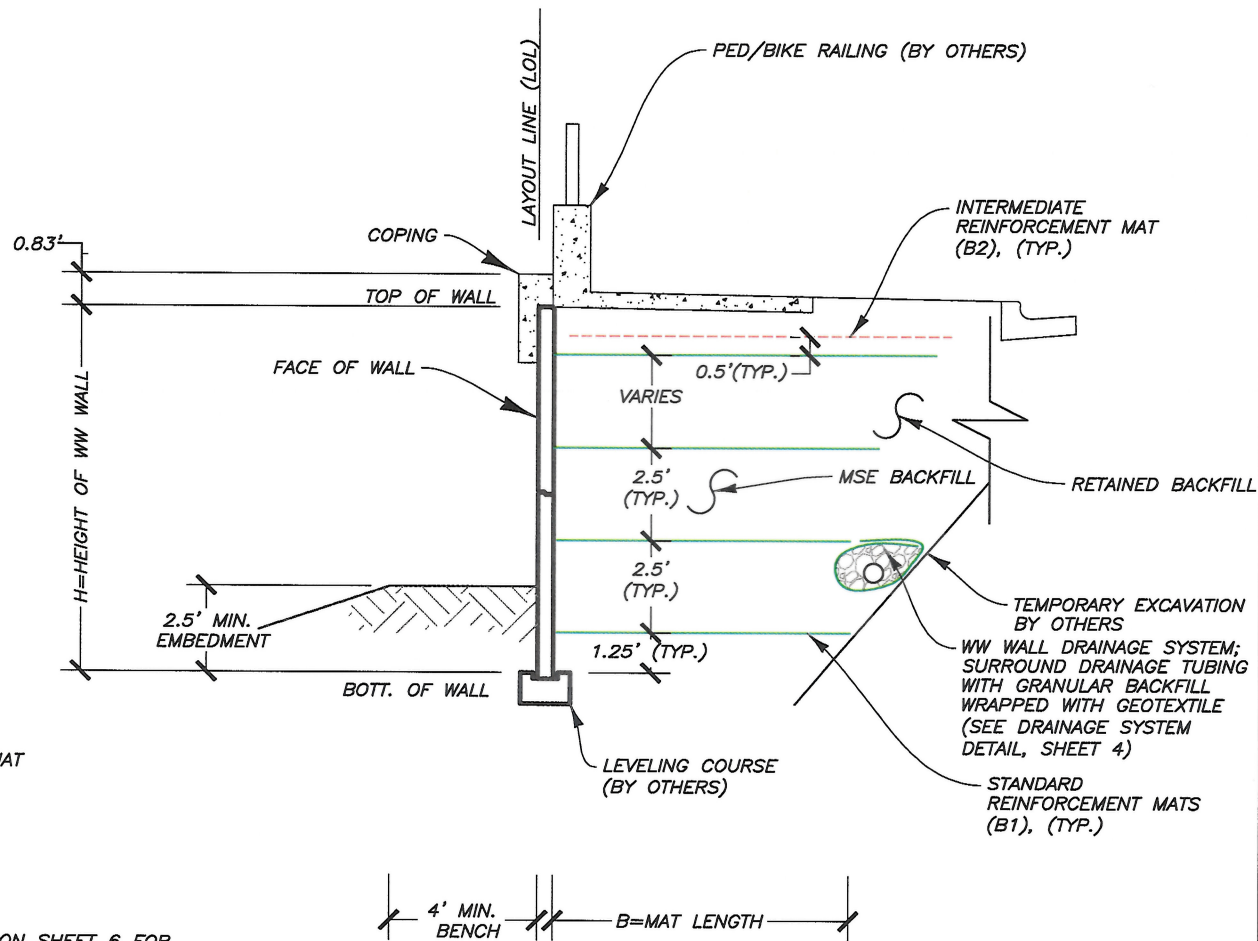

TYPICAL SECTION A-2
NOT TO SCALE

NOTE: SEE TABLE ON SHEET 6 FOR DETAILED MAT INSTALLATION SCHEDULE.

LEGEND

| | | |
|-----|-----|--|
| --- | B1 | 8"x12", W9.5xW4-HDG (STANDARD MAT) |
| --- | B2 | 8"x10.5", W4.5xW3.5-HDG (INTERMEDIATE FLAT MAT, NO CONNECTION TO FACE) |
| --- | LOL | LAYOUT LINE |
| --- | H | HILFIKER WALL HEIGHT |
| --- | B | MAT LENGTH |
| --- | WW | WELDED WIRE |

| REV. | DATE | BY | DESCRIPTION | CADD: |
|------|----------|-----|-------------------|---------------|
| 0 | 2/4/2021 | RGV | ISSUED FOR REVIEW | RGV |
| | | | | DESIGNED: RGV |
| | | | | CHECKED: SGC |

HILFIKER RETAINING WALLS

1902 Hilfiker Lane
Eureka, CA 95603-6711
TOLL-FREE 800.762.8962
PH 707.443.5093 FAX 707.443.2891
WEBSITE www.hilfiker.com E-MAIL info@hilfiker.com

AMERICAN GEO TECHNICS

American Geotechnics
5260 Chinden Blvd.
Boise, ID 83714
(208) 658-8700
Fax: (208) 658-8703

| | |
|--|-------------------------|
| PLAN & ELEVATION | DWG DATE: 4 FEB 2021 |
| RSE WALL | HRW NO.: 210105AW |
| US 20/26 (CHINDEN BLVD) AND CURTIS RD | SHEET 3 OF 6 |
| ACHD | GARDEN CITY, ID |

PROFESSIONAL ENGINEER

2-4-21

15993

P. VAN G. VAN LEUVEN

STATE OF IDAHO

08495 - Chinden Blvd & Curtis Road Wall - ITPREPARED 2-4-2021.dwg

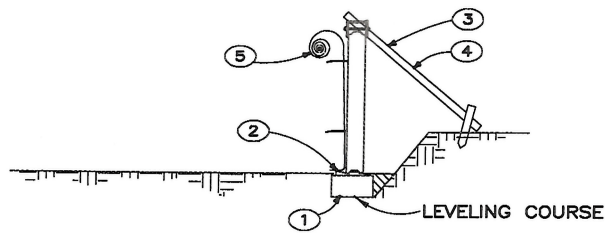

STEP 1

1. CAST THE LEVELING COURSE ON PREPARED FOUNDATION.
2. PLACE THE FIRST LIFT OF PANELS ON THE LEVELING COURSE. PLUMB WITH WOODEN WEDGES.
3. INSTALL TWO-SIDED BRACING BLOCKS ACROSS THE TOPMOST MATING EDGES OF ADJACENT PANELS.
4. INSTALL 2x4 WOOD BRACING TO EACH PANEL THAT IS 5' OR MORE IN HEIGHT.
5. BEGIN UNROLLING THE FILTER FABRIC AGAINST ALL VERTICAL AND HORIZONTAL JOINTS. FILTER FABRIC SHALL MEET THE REQUIREMENTS OF SECTION 02320 IN THE ODOT STANDARD SPECS FOR TYPE I (LEVEL B) DRAINAGE GEOTEXTILE.

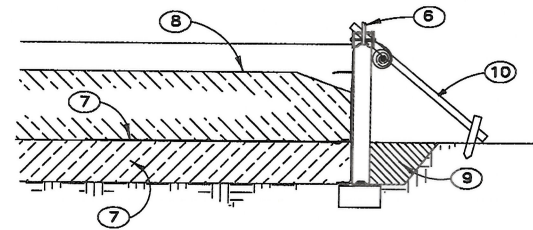

STEP 2

6. INSTALL PANEL ALIGNMENT PINS BEFORE BEGINNING ANY BACKFILL.
7. PLACE AND COMPACT THE BACKFILL TO THE LEVEL OF THE FIRST COURSE OF SOIL REINFORCEMENT MATS. PLACE THE SOIL REINFORCEMENT MATS.
8. PLACE AND COMPACT MORE BACKFILL, TO THE NEXT LEVEL OF THE SOIL REINFORCEMENT MATS.
9. BACKFILL AND COMPACT TOE AT FACE OF WALL.
10. BRACING MAY BE REMOVED ONLY AFTER SUFFICIENT COMPACTED BACKFILL HAS BEEN PLACED OVER THE SOIL REINFORCEMENT MATS TO MAKE THE CONSTRUCTION STABLE.

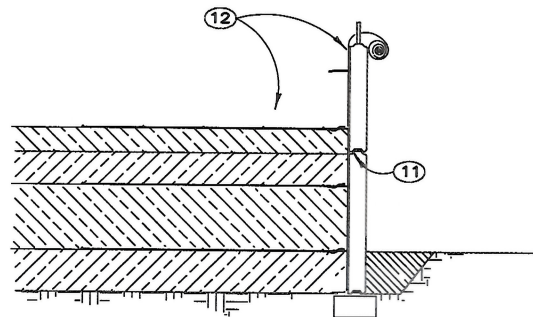

STEP 3

11. PLACE THE EPDM RUBBER OR HDPE BEARING PADS. REMOVE THE BRACING BLOCKS AND INSTALL THE NEXT LEVEL OF PANELS AND SECURE WITH TWO-SIDED BRACING BLOCKS.
12. CONTINUE STEPS 3, 5, 6, 7, 8 AND 10 TO THE TOP OF THE WALL.

CONSTRUCTION SEQUENCE
NOT TO SCALE

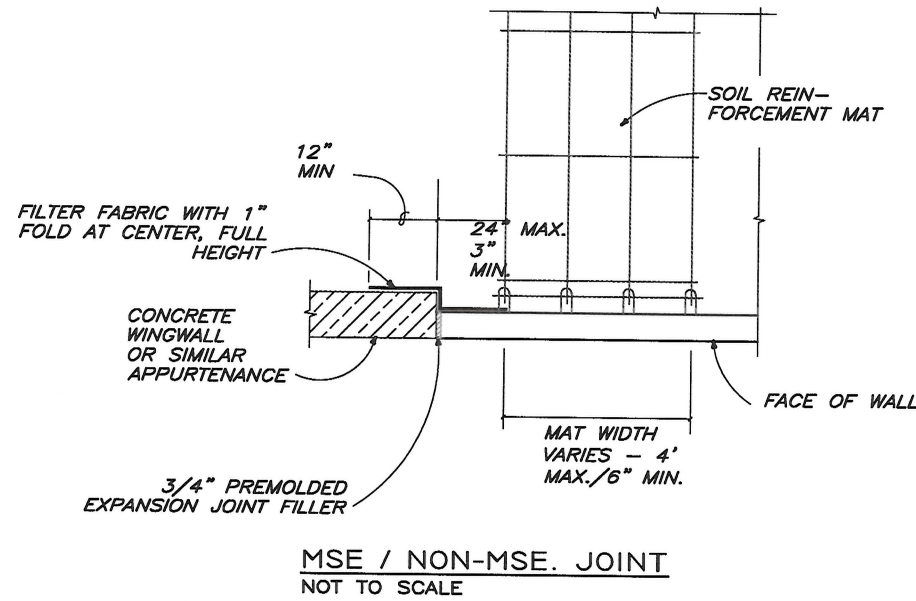

MSE / NON-MSE. JOINT
NOT TO SCALE

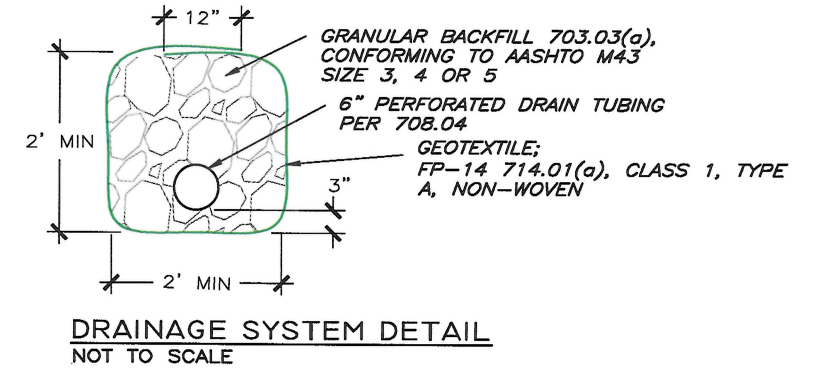

DRAINAGE SYSTEM DETAIL
NOT TO SCALE

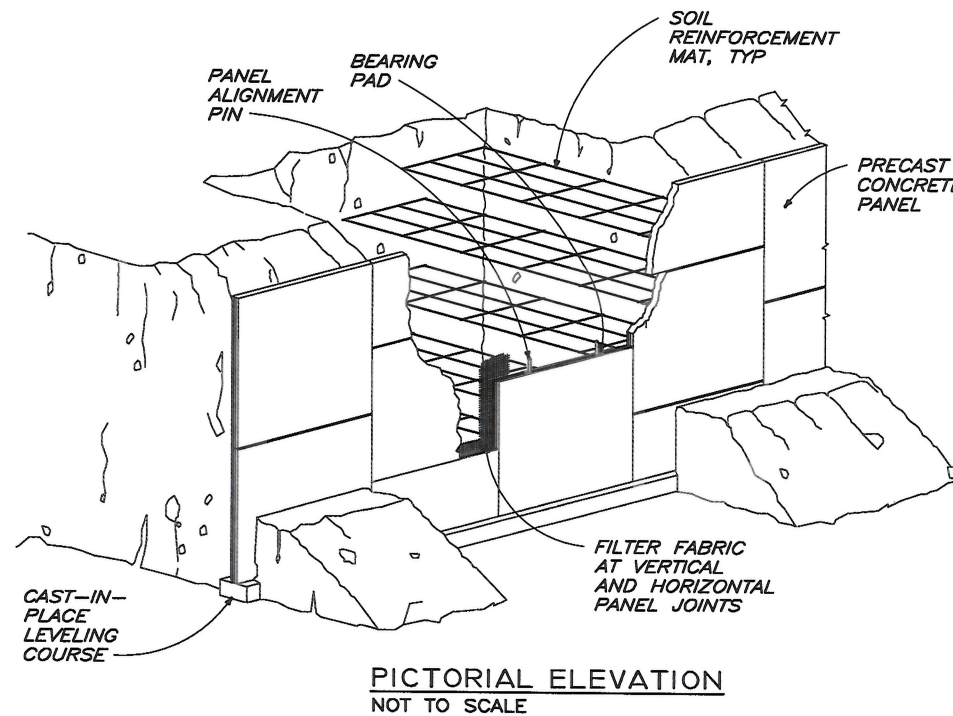

PICTORIAL ELEVATION
NOT TO SCALE

04/03 - Chinden Blvd & Curtis Road Wall - PREPARED 2-4-2021.dwg

RV/Lenven 2/4/2021 10:52:41M

| REV. | DATE | BY | DESCRIPTION | CADD: |
|------|----------|-----|-------------------|---------------|
| 0 | 2/4/2021 | RGV | ISSUED FOR REVIEW | RGV |
| | | | | DESIGNED: RGV |
| | | | | CHECKED: SGC |

HILFIKER RETAINING WALLS

1902 Hilfiker Lane
Eureka, CA 95603-5711
TOLL-FREE 800.762.8962
PH 707.443.3093 FAX 707.443.2891
WEB SITE www.hilfiker.com EMAIL info@hilfiker.com

AMERICAN GEOTECHNICS

American Geotechnics
5260 Chinden Blvd.
Boise, ID 83714
(208) 658-8700
Fax: (208) 658-8703

| SEQUENCE & DETAILS | |
|--------------------|---------------------------------------|
| RSE WALL | US 20/26 (CHINDEN BLVD) AND CURTIS RD |
| ACHD | GARDEN CITY, ID |

| | |
|-----------|------------|
| DWG DATE: | 4 FEB 2021 |
| HRW NO.: | 210105AW |
| SHEET | 4 |
| OF | 6 |

PROFESSIONAL ENGINEER

2-4-21

15993

RYAN G. VAN LEUVEN

STATE OF IDAHO

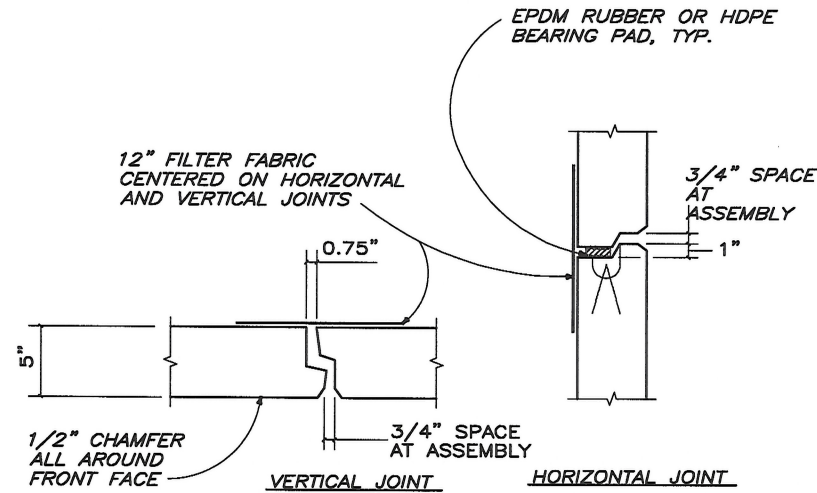
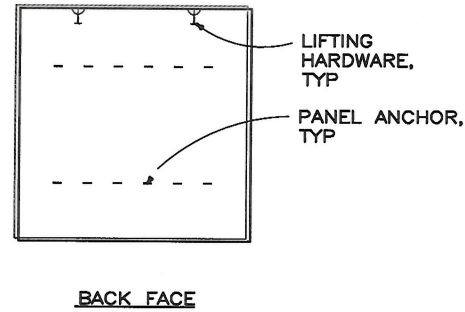
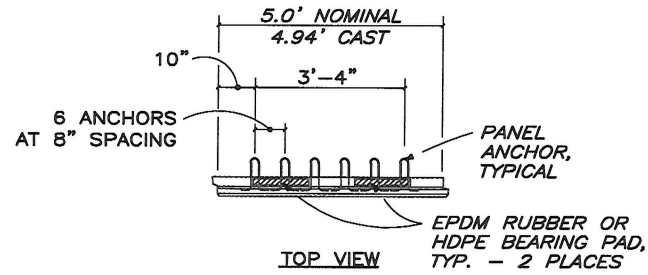

PANEL GROOVE DETAILS
NOT TO SCALE

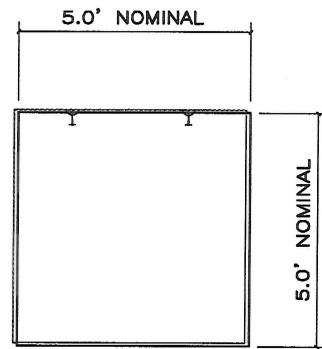
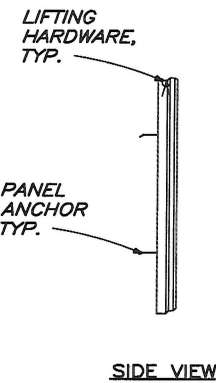

NOTE: STANDARD HEIGHT OF TOP PANELS IS 2.5' OR 5.0'. TOP OF PANEL MAY BE SLOPED IF REQUIRED. STANDARD HEIGHT OF BOTTOM PANELS IS 2.5' OR 5.0'.

STANDARD PANEL DIMENSIONS
NOT TO SCALE

- NOTES:
- STANDARD PRECAST PANEL SHOWN. SIZE MAY VARY AS REQUIRED AND TOP OF PANELS MAY BE CAST SLOPED IF REQUIRED.
 - SOIL REINFORCEMENT MAT WIDTHS AND PANEL ANCHOR SPACING WILL VARY WITH WALL HEIGHTS AND EXTERNAL LOADING CONDITIONS.

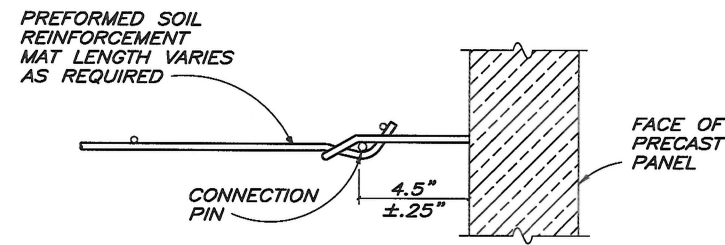

MAT CONNECTION DETAIL
NOT TO SCALE

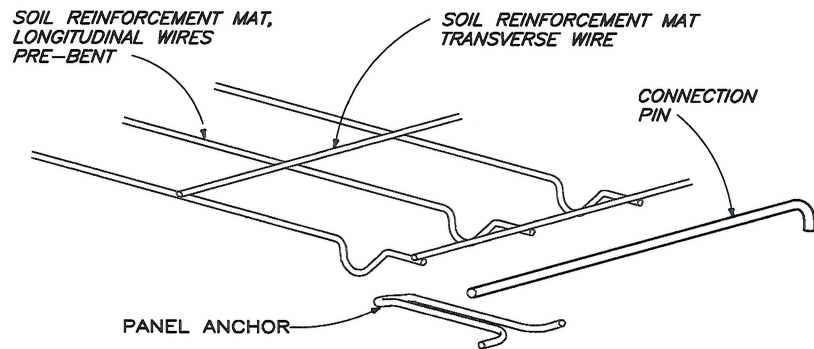

MAT AND CONNECTION COMPONENTS

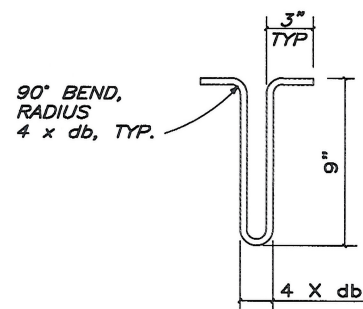

PANEL ANCHOR DETAIL
NOT TO SCALE

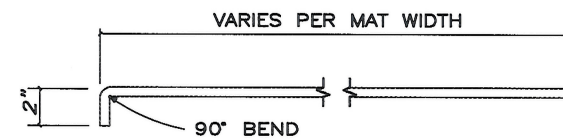

CONNECTION PIN DETAIL
NOT TO SCALE

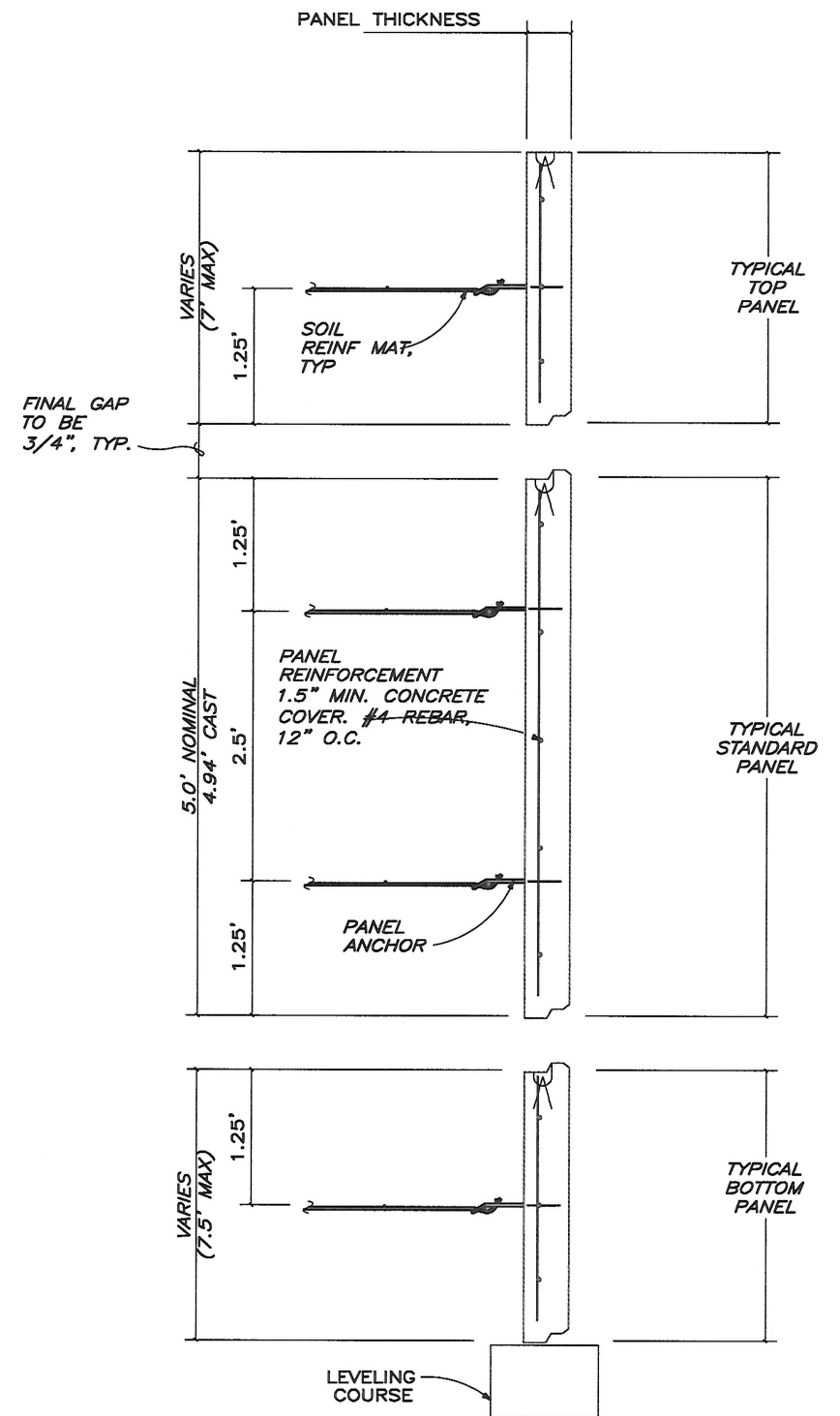

PANEL SECTIONS
NOT TO SCALE

08/03 - Chinden Blvd & Curtis Road Wall, I/PREPARED 2-4-2021.dwg

RVC:lcw

THE DESIGN CONTAINED ON THESE DRAWINGS IS BASED ON INFORMATION PROVIDED BY THE OWNER. ON THE BASIS OF THIS INFORMATION, THE HILFIKER COMPANY HAS DESIGNED, AND IS RESPONSIBLE FOR THE INTERNAL STABILITY OF THE STRUCTURE ONLY. EXTERNAL STABILITY, INCLUDING FOUNDATION AND SLOPE STABILITY, IS THE RESPONSIBILITY OF THE OWNER.

| REV. | DATE | BY | DESCRIPTION |
|------|----------|-----|-------------------|
| 0 | 2/4/2021 | RGV | ISSUED FOR REVIEW |

CADD: RGV
DESIGNED: RGV
CHECKED: SGC

HILFIKER RETAINING WALLS



1902 HilfiKER Lane
Eureka, CA 95603-0711
TOLL-FREE 800.762.8962
PH 707.443.5093 FAX 707.443.2891
WEBSITE www.hilfiKER.com E-MAIL info@hilfiKER.com



American Geotechnics
5260 Chinden Blvd.
Boise, ID 83714
(208) 658-8700
Fax: (208) 658-8703

| DETAILS | |
|---------------------------------------|-----------------|
| RSE WALL | |
| US 20/26 (CHINDEN BLVD) AND CURTIS RD | |
| ACHD | GARDEN CITY, ID |

| | |
|-----------|------------|
| DWG DATE: | 4 FEB 2021 |
| HRW NO.: | 210105AW |
| SHEET | 5 |
| OF | 6 |



REINFORCEMENT INSTALLATION SCHEDULE

| ROWS | COLUMNS (HEIGHT ABOVE BOTTOM OF WALL/LENGTH OF MAT), (FT) | | | | | | | | | | | | | | | | | | |
|--------------|--|---------|-----------|-----------|-----------|-----------|-----------|-----------|------------|------------|------------|------------|------------|------------|------------|-----------|-----------|-----------|-----------|
| | 1 | 2 | 3 | 4 | 5 | 6 | 7 | 8 | 9 | 10 | 11 | 12 | 13 | 14 | 15 | 16 | 17 | 18 | 19 |
| INTERMEDIATE | 9.2/14.13 | 9/14.13 | 8.8/14.13 | 8.7/14.13 | 8.5/14.13 | 8.3/11.35 | 8.1/11.35 | 7.9/11.35 | 7.75/11.35 | 7.75/11.35 | 7.75/11.35 | 7.75/11.35 | 7.75/11.35 | 7.75/11.35 | 6.75/11.35 | 6.6/11.35 | 6.5/11.35 | 6.3/11.35 | 6.1/11.35 |
| ROW D | 8.7/13 | 8.5/13 | 8.3/13 | 8.2/13 | 8/13 | 7.8/12 | 7.6/12 | 7.4/12 | 7.25/12 | -- | -- | -- | -- | -- | -- | -- | -- | -- | -- |
| ROW C | 6.25/11 | 6.25/11 | 6.25/11 | 6.25/11 | 6.25/11 | 6.25/12 | 6.25/12 | 6.25/12 | 6.25/12 | 6.25/11 | 6.25/11 | 6.25/11 | 6.25/11 | 6.25/11 | 6.25/11 | 6.1/11 | 6/11 | 5.8/11 | 5.6/11 |
| ROW B | 3.75/9 | 3.75/9 | 3.75/9 | 3.75/9 | 3.75/9 | 3.75/9 | 3.75/9 | 3.75/9 | 3.75/9 | 3.75/10 | 3.75/10 | 3.75/10 | 3.75/10 | 3.75/10 | 3.75/10 | 3.75/10 | 3.75/10 | 3.75/11 | 3.75/11 |
| ROW A | 1.25/9 | 1.25/9 | 1.25/9 | 1.25/9 | 1.25/9 | 1.25/9 | 1.25/9 | 1.25/9 | 1.25/9 | 1.25/9 | 1.25/9 | 1.25/9 | 1.25/9 | 1.25/9 | 1.25/9 | 1.25/9 | 1.25/9 | 1.25/9 | 1.25/9 |

| ROWS | COLUMNS (HEIGHT ABOVE BOTTOM OF WALL/LENGTH OF MAT), (FT) | | | | | | | | | | | | | | | |
|--------------|--|-----------|-----------|-----------|-----------|-----------|---------|---------|---------|---------|---------|---------|---------|---------|---------|--|
| | 20 | 21 | 22 | 23 | 24 | 25 | 26 | 27 | 28 | 29 | 30 | 31 | 32 | 33 | 34 | |
| INTERMEDIATE | 6/11.35 | 5.8/11.35 | 5.7/11.35 | 5.5/11.35 | 5.4/11.35 | 5.3/11.35 | 4.25/10 | 4.25/10 | 4.25/10 | 4.25/10 | 4.25/10 | 4.25/10 | 4.25/10 | 4.25/10 | 4.25/10 | |
| ROW D | -- | -- | -- | -- | -- | -- | -- | -- | -- | -- | -- | -- | -- | -- | -- | |
| ROW C | 5.5/11 | 5.3/11 | 5.2/11 | 5/11 | 4.9/11 | 4.8/11 | -- | -- | -- | -- | -- | -- | -- | -- | -- | |
| ROW B | 3.75/11 | 3.75/11 | 3.75/11 | 3.75/11 | 3.75/11 | 3.75/11 | 3.75/10 | 3.75/10 | 3.75/10 | 3.75/10 | 3.75/10 | 3.75/10 | 3.75/10 | 3.75/10 | 3.75/10 | |
| ROW A | 1.25/9 | 1.25/9 | 1.25/9 | 1.25/9 | 1.25/9 | 1.25/9 | 1.25/9 | 1.25/9 | 1.25/9 | 1.25/9 | 1.25/9 | 1.25/9 | 1.25/9 | 1.25/9 | 1.25/9 | |

NOTES: HEIGHT OF REINFORCEMENT LOCATION MEASURED FROM BOTTOM OF WALL (APPROXIMATE ELEVATION 2650.10 FT)

08493 - Chinden Blvd & Curtis Road Wall - I/PREPARED 2-4-2021.dwg

2/4/2021 10:52 AM

| REV. | DATE | BY | DESCRIPTION |
|------|----------|-----|-------------------|
| 0 | 2/4/2021 | RGV | ISSUED FOR REVIEW |

CADD: RGV
DESIGNED: RGV
CHECKED: SGC

HILFIKER RETAINING WALLS



1902 Hilfiker Lane
Eureka, CA 95603-6711
TOLL-FREE 800.762.8962
PH 707.443.3093 FAX 707.443.2891
WEBSITE www.hilfiker.com EMAIL info@hilfiker.com

AMERICAN GEO TECHNICS



American Geotechnics
5260 Chinden Blvd.
Boise, ID 83714
(208) 658-8700
Fax: (208) 658-8703

| NOTES |
|--|
| RSE WALL US 20/26 (CHINDEN BLVD) AND CURTIS RD |
| ACHD GARDEN CITY, ID |

| |
|-------------------------|
| DWG DATE: 4 FEB 2021 |
| HRW NO.: 210105AW |
| SHEET 6 OF 6 |

PROFESSIONAL ENGINEER

2-4-21

15993

RYAN G. VAN LEUVEN

STATE OF IDAHO