

SPIRALNAIL PARAMETERS			
SECTION	HEIGHT	HORIZONTAL SPACING	SPIRALNAILS (AT PILASTERS)
1	8'	6'	3 - 20' @ 15°
2	10'	6'	3 - 20' @ 15°
3	12'	6'	4 - 21' @ 15°
4	14'	6'	4 - 27' @ 15°
5	16'	6'	5 - 28' @ 15°

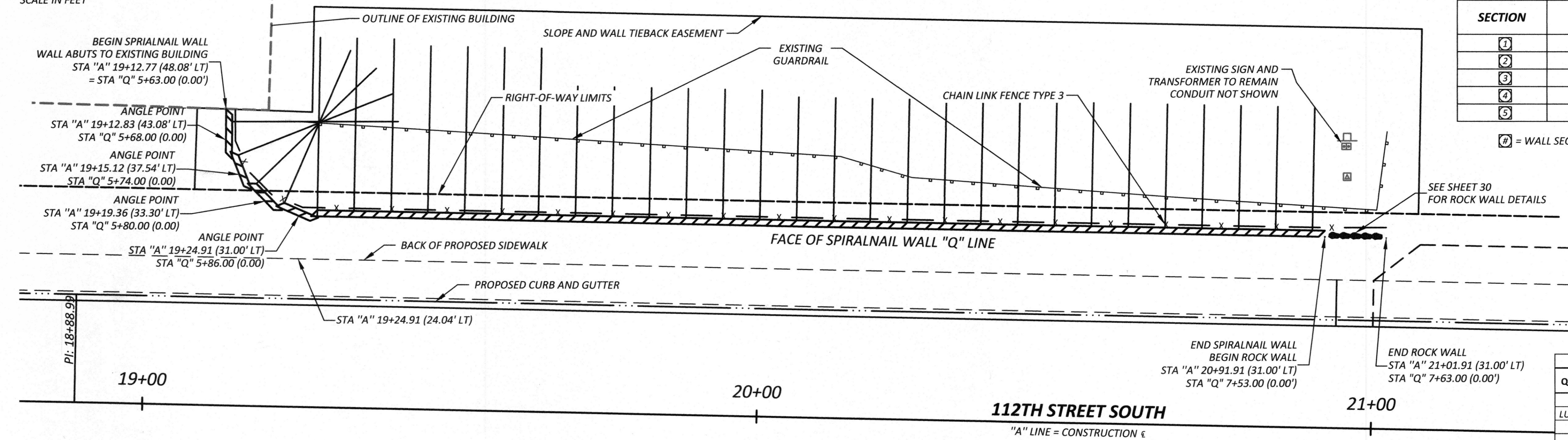

112TH STREET SOUTH SPIRALNAIL WALL AND ROCK WALL PLAN VIEW

SPIRALNAIL WALL QUANTITIES		
QUANTITY	UNITS	ITEM DESCRIPTION
LUMP SUM	L.S.	REMOVING EXISTING ROCK WALL
28	C.Y.	GRAVEL BACKFILL FOR WALL
33	Ton	CRUSHED SURFACING BASE COURSE
170	S.Y.	BARK OR WOOD CHIP
2,195	S.F.	SPIRALNAIL WALL
116	EACH	SPIRALNAIL
198	L.F.	CHAIN LINK FENCE TYPE 3

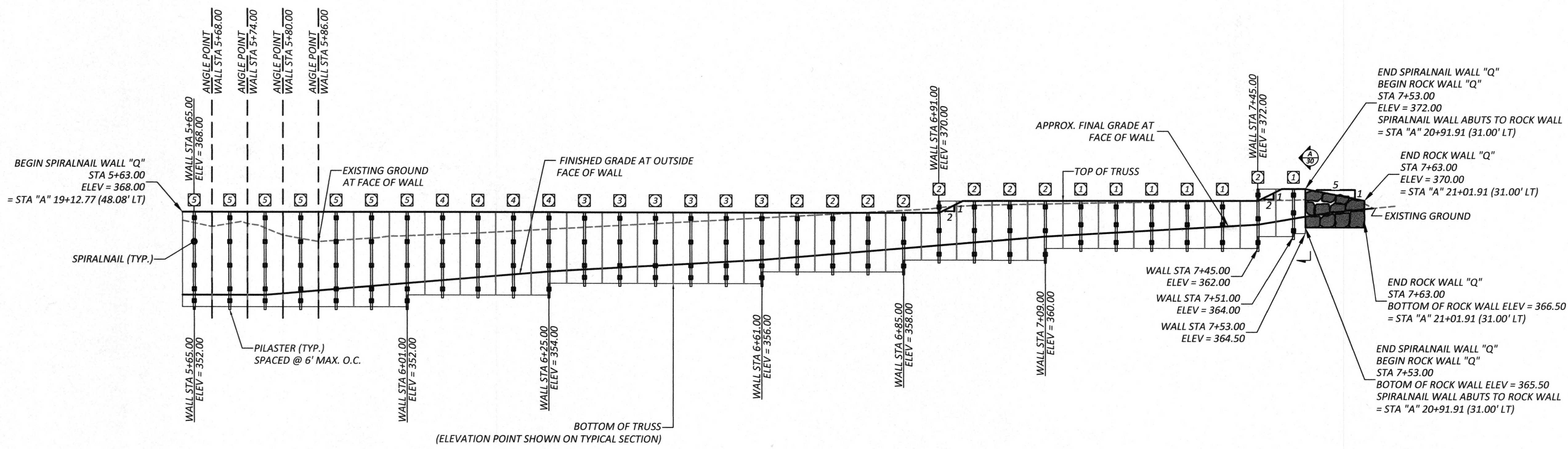

112TH STREET SOUTH SPIRALNAIL WALL AND ROCK WALL PROFILE VIEW

LENGTH ALONG FACE OF WALL

Drawing: P:\5853-112ST\112ST\BRIDGE\DRAWINGS\CONSTRUCTION\PLANSHEETS\5853_SPIRALNAILWALL_PLANPROF Xrefs: 5853_PROPOSEDROW_INDEX.DWG Date: 03/07/2023 Time: 10:00:29 AM Plotted by: AKINGTA

DRAWN BY: R. RUSSOM, P.E.	BOOK NO.:
DESIGNED BY: R. RUSSOM, P.E.	SURVEYED BY: S. COOK / R. CROSBY
CHECKED BY: G. AMUNDSEN, P.E.	DATE SURVEYED: JUNE 2017
REVIEWED BY: G. AMUNDSEN, P.E.	DATE PLOTTED: March 7, 2023

NO.	DATE	REVISION	BY	APPROVED

Pierce County
Planning & Public Works
 Office of the County Engineer
 2702 South 42nd Street, Suite 109
 Tacoma, Washington 98409
 An APWA Accredited Agency

Office of the County Engineer
 APPROVED BY:

 MELISSA C. McFADDEN, P.E. DATE: 3-8-2023
 CRAIG W. SHANER, P.E. FIELD ENGINEERING SECTION MANAGER

112TH STREET SOUTH
C STREET SOUTH TO A STREET SOUTH
SPIRALNAIL WALL PLAN AND PROFILE
CRP 5853

SHEET
23
 OF
53

Drawing: P:\5853-1125\1125\1125\BRIDGE\DRAWINGS\CONSTRUCTION\PLANSHEETS\5853_SPIRALNAILWALL_DETAILS01
 Xrefs: 5853_PROPOSEDROW_INDEX.DWG
 Date: 03/07/2023 Time: 10:08:09 AM Plotted by: AKINGTA

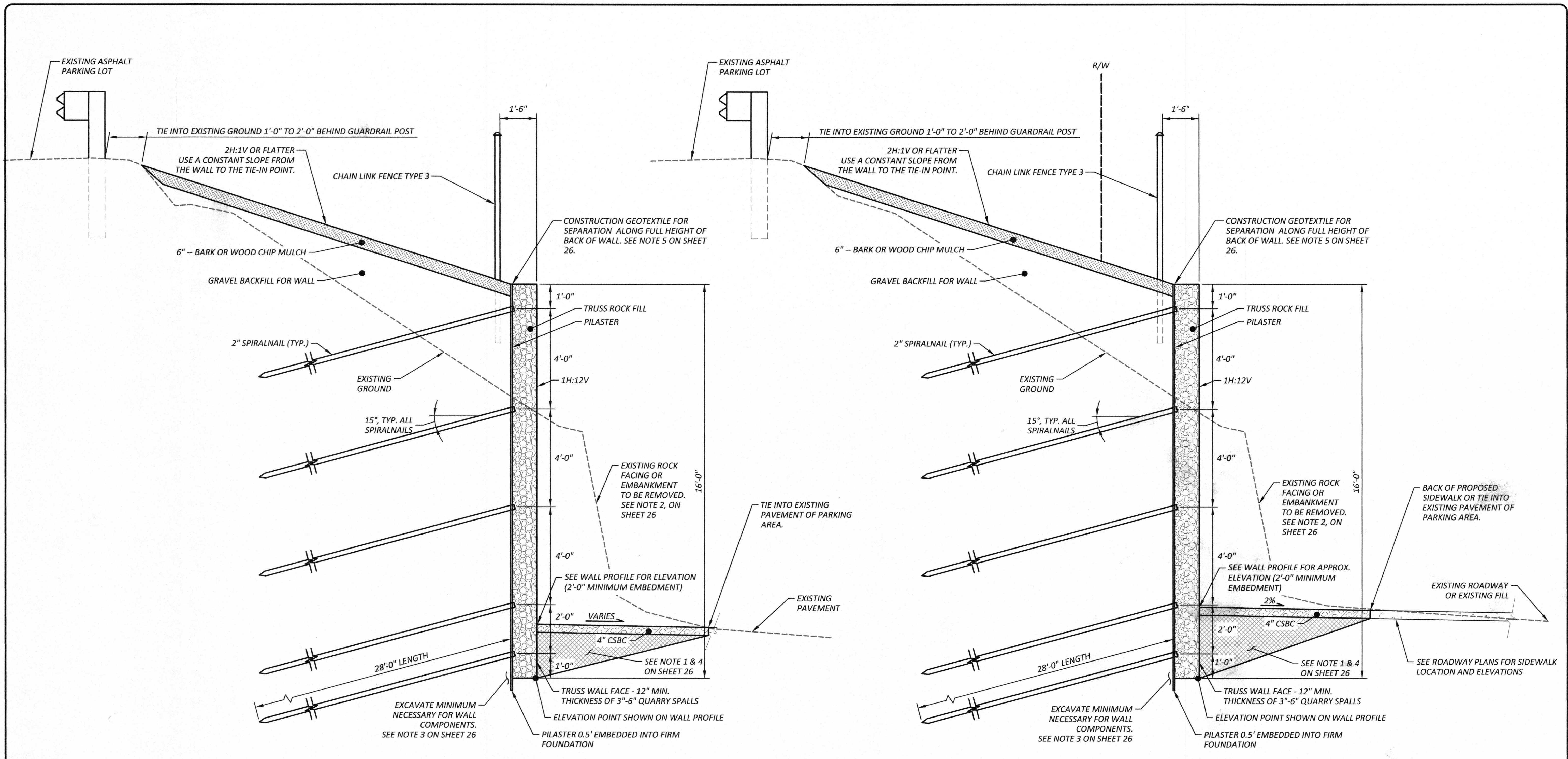



TYPICAL SPIRALNAIL WALL SECTION
 STA "Q" 5+65 TO ~5+80 112TH STREET SOUTH
 CURVED (CORDED) SECTION OF WALL

TYPICAL SPIRALNAIL WALL SECTION
 STA "Q" ~5+80 TO 6+01 112TH STREET SOUTH

DRAWN BY: R. RUSSOM, P.E.	BOOK NO.: ---
DESIGNED BY: R. RUSSOM, P.E.	SURVEYED BY: S. COOK / R. CROSBY
CHECKED BY: G. AMUNDSEN, P.E.	DATE SURVEYED: JUNE 2017
REVIEWED BY: G. AMUNDSEN, P.E.	DATE PLOTTED: March 7, 2023

NO.	DATE	REVISION	BY	APPROVED

Pierce County
 Planning & Public Works
 Office of the County Engineer
 2702 South 42nd Street, Suite 109
 Tacoma, Washington 98409
 An APWA Accredited Agency

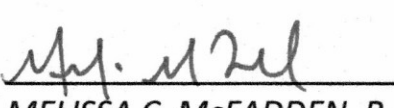

 3-7-2023

Office of the County Engineer
 APPROVED BY:

 MELISSA C. MCFADDEN, P.E. DATE

112TH STREET SOUTH
C STREET SOUTH TO A STREET SOUTH
SPIRALNAIL WALL SECTIONS 1 OF 3
CRP 5853

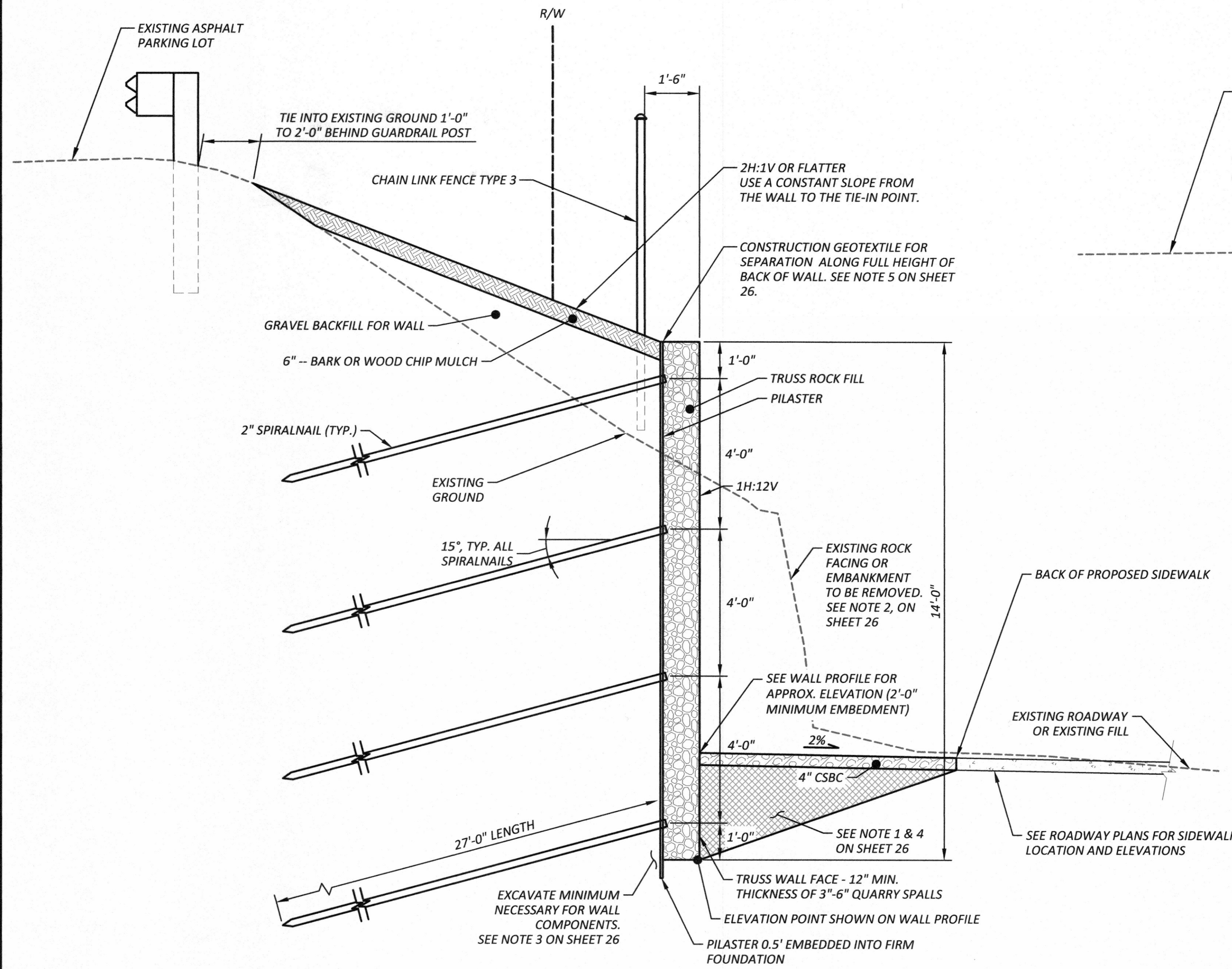
SHEET
24
 OF
53

Drawing: P:\5853-1125TH STREET BRIDGE\DRAWINGS\CONSTRUCTION\PLANS\5853_SPIRALNAILWALL_DETAILS02
 Xrefs: 5853_PROPOSEDROW_INDEX.DWG
 Date: 03/07/2023 Time: 10:08:41 AM Plotted by: AKINGTA



TYPICAL SPIRALNAIL WALL SECTION
STA "Q" 6+07 TO 6+25 STREET SOUTH

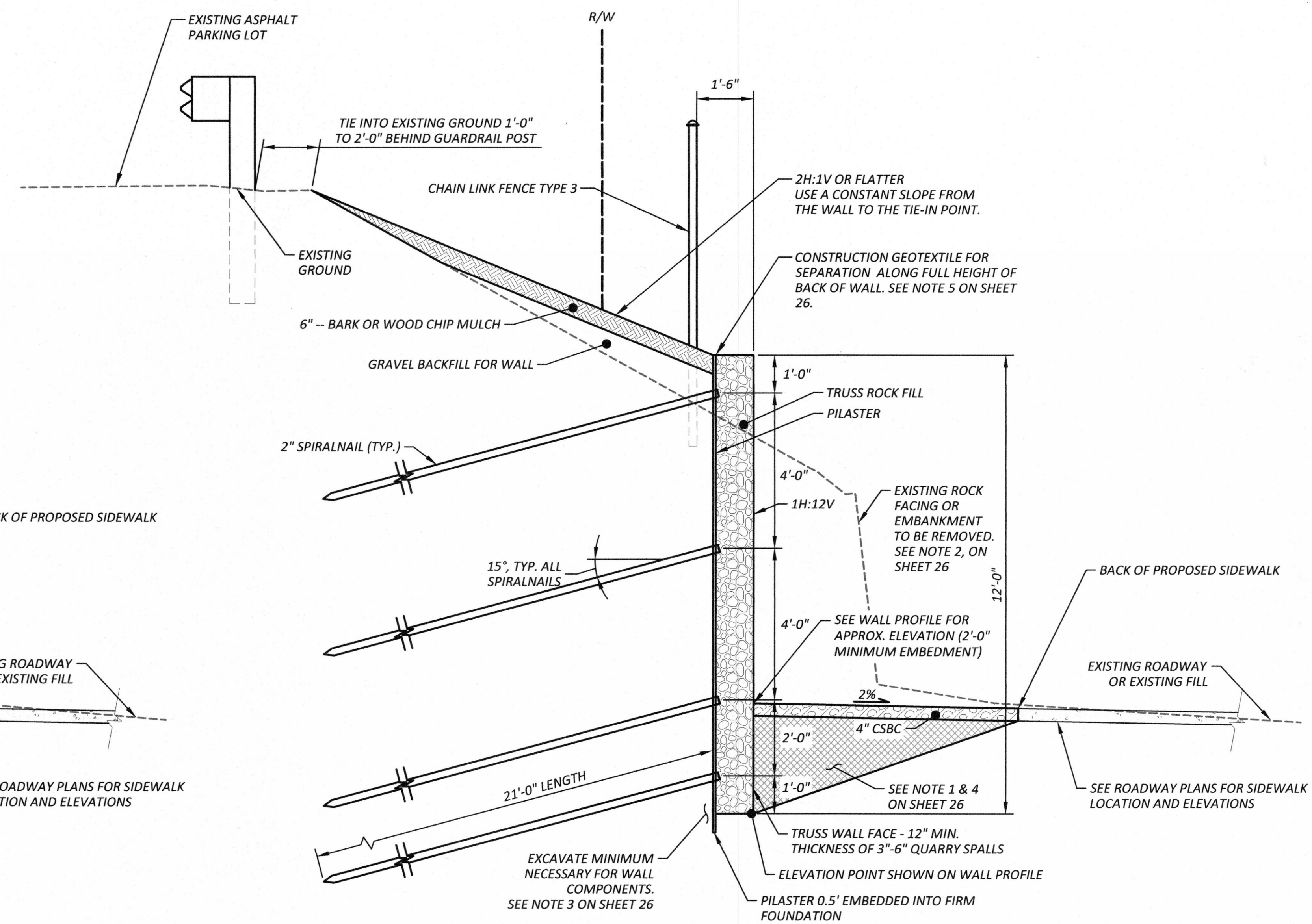

TYPICAL SPIRALNAIL WALL SECTION
STA "Q" 6+31 TO 6+61 112TH STREET SOUTH

DRAWN BY: R. RUSSOM, P.E.	BOOK NO.: ---
DESIGNED BY: R. RUSSOM, P.E.	SURVEYED BY: S. COOK / R. CROSBY
CHECKED BY: G. AMUNDSEN, P.E.	DATE SURVEYED: JUNE 2017
REVIEWED BY: G. AMUNDSEN, P.E.	DATE PLOTTED: March 7, 2023

NO.	DATE	REVISION	BY	APPROVED

Pierce County
 Planning & Public Works
 Office of the County Engineer
 2702 South 42nd Street, Suite 109
 Tacoma, Washington 98409
 An APWA Accredited Agency

 3-7-2023

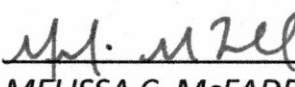
Office of the County Engineer
 APPROVED BY:

 MELISSA C. MCFADDEN, P.E. DATE 3.8.2023
 KRAIG W. SHANER, P.E.
 FIELD ENGINEERING SECTION MANAGER

112TH STREET SOUTH
C STREET SOUTH TO A STREET SOUTH
SPIRALNAIL WALL SECTIONS 2 OF 3
CRP 5853

SHEET
25
 OF
53

NOTES:

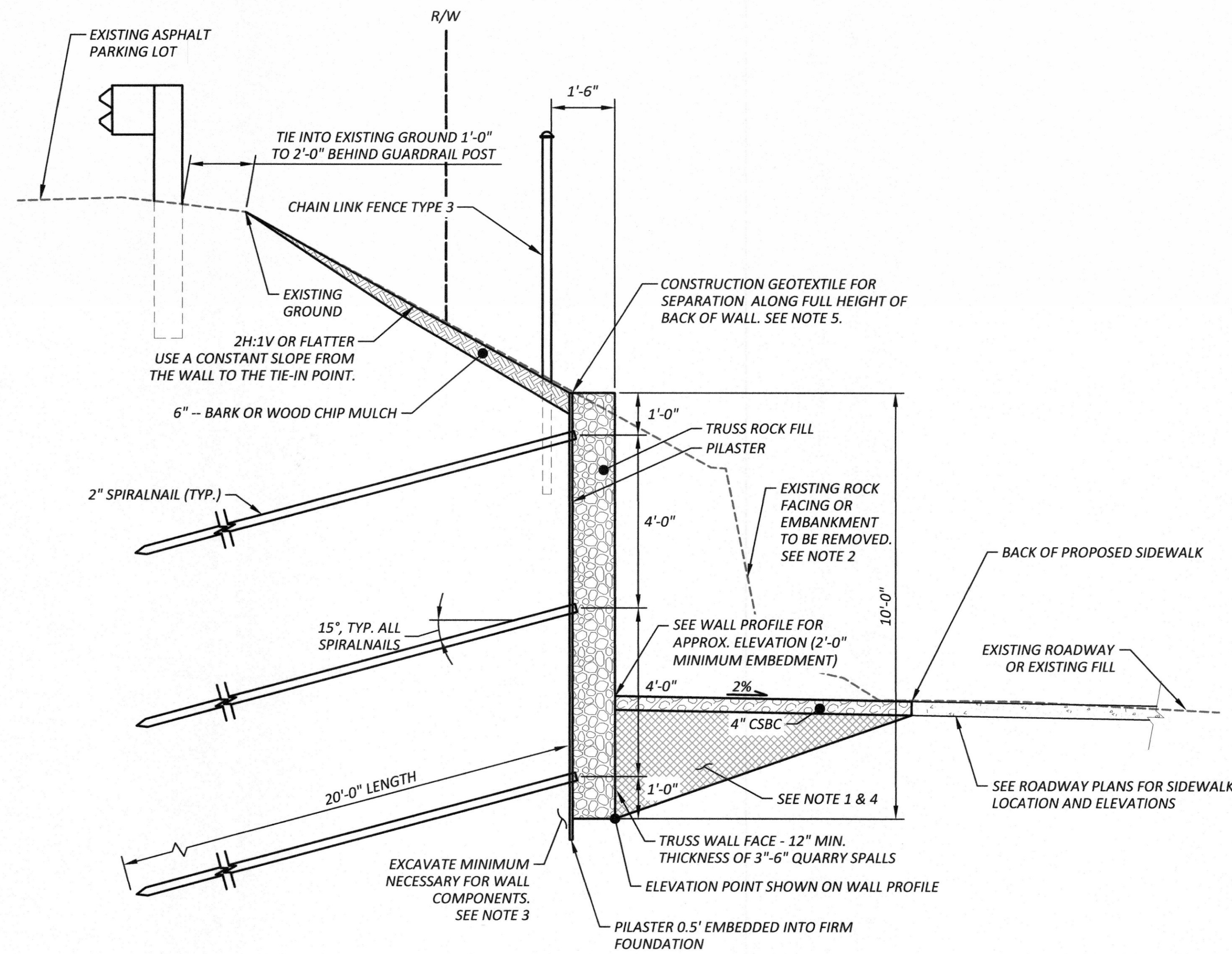
1. EXCAVATION IN FRONT OF THE WALL, THAT IS NOT INCLUDED IN THE BID ITEM "ROADWAY EXCAVATION INCL. HAUL" SHALL BE INCLUDED IN THE BID ITEM "SPIRALNAIL WALL".
2. REMOVAL AND DISPOSAL OF THE EXISTING ROCK FACING SHALL BE INCLUDED IN THE BID ITEM "REMOVING EXISTING ROCK FACING".
3. EXCAVATION NECESSARY TO EMBED THE SPIRALNAIL WALL AND TO TRIM THE FACE OF THE BACKSIDE EMBANKMENT SHALL BE INCLUDED IN THE BID ITEM "SPIRALNAIL WALL".
4. EMBANKMENT AND EMBANKMENT COMPACTION IN FRONT OF THE WALL THAT IS NOT INCLUDED IN THE BID ITEM "EMBANKMENT COMPACTION" SHALL BE INCLUDED IN THE BID ITEM "SPIRALNAIL WALL".
5. CONSTRUCTION GEOTEXTILE FOR SEPARATION ALONG FULL HEIGHT OF BACK OF WALL SHALL BE INCLUDED IN THE BID ITEM "SPIRALNAIL WALL".



TYPICAL SPIRALNAIL WALL SECTION
 STA "Q" 6+67 TO 7+09 112TH STREET SOUTH
 STA "Q" 7+45 112TH STREET SOUTH

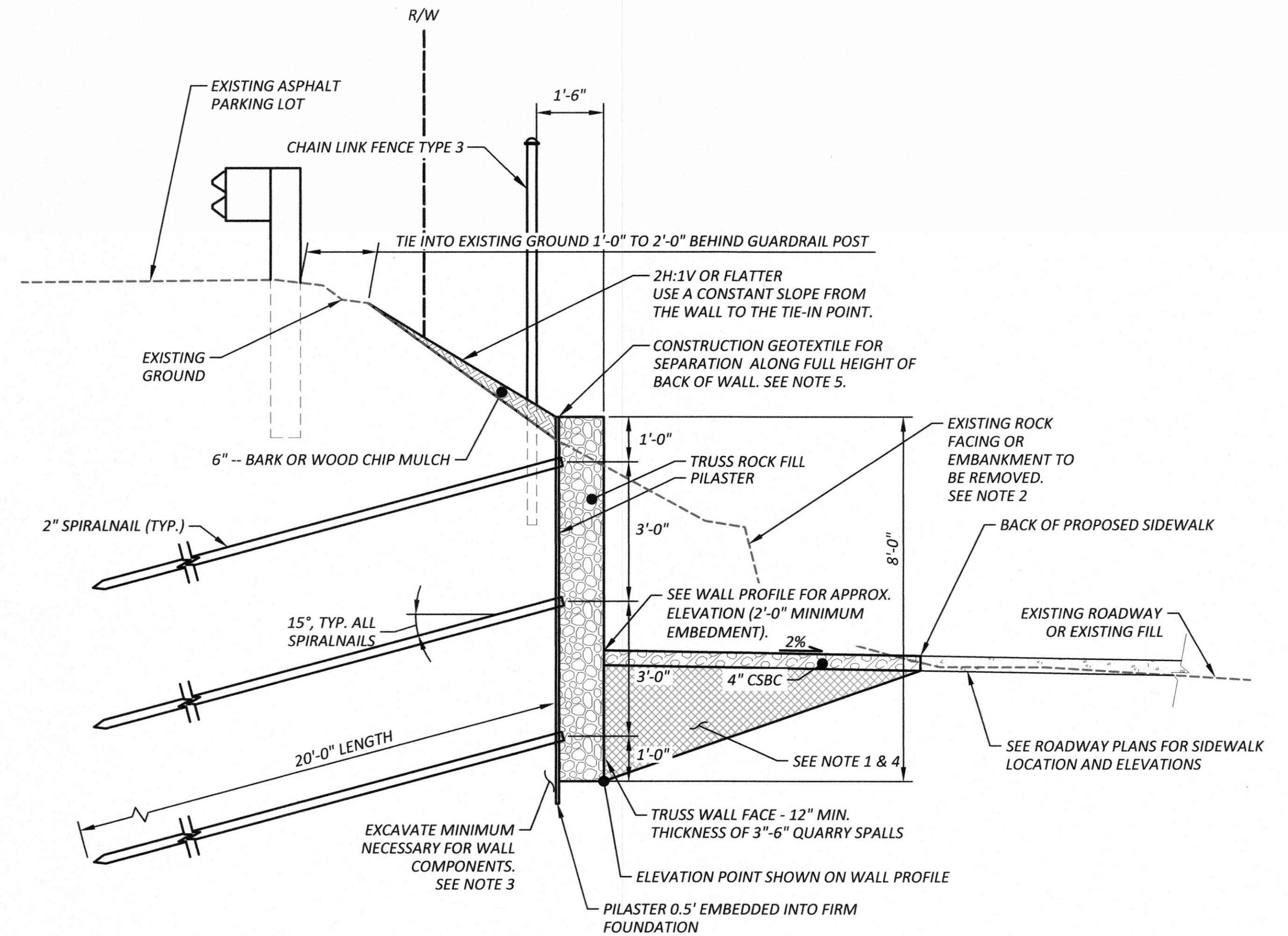

TYPICAL SPIRALNAIL WALL SECTION
 STA "Q" 7+15 TO 7+39 112TH STREET SOUTH
 STA "Q" 7+51 TO 7+53 112TH STREET SOUTH

Drawing: P:\5853-1125\1125\1125\BRIDGE\DRAWINGS\CONSTRUCTION\PLANSHEETS\5853_SPIRALNAILWALL_DETAILS03
 Xrefs: 5853_PROPOSEDROW_INDEX.DWG
 Date: 03/07/2023 Time: 10:10:31 AM Plotted by: AKINGTA

DRAWN BY: R. RUSSOM, P.E.	BOOK NO.:
DESIGNED BY: R. RUSSOM, P.E.	SURVEYED BY: S. COOK / R. CROSBY
CHECKED BY: G. AMUNDSEN, P.E.	DATE SURVEYED: JUNE 2017
REVIEWED BY: G. AMUNDSEN, P.E.	DATE PLOTTED: March 7, 2023

NO.	DATE	REVISION	BY	APPROVED

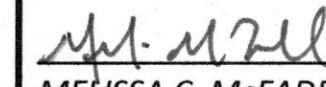

Pierce County
 Planning & Public Works
 Office of the County Engineer
 2702 South 42nd Street, Suite 109
 Tacoma, Washington 98409
 An APWA Accredited Agency

Office of the County Engineer
 APPROVED BY:

 MELISSA C. MCFADDEN, P.E. DATE: 3.8.2023
 KRAIG W. SHANER, P.E.
 FIELD ENGINEERING SECTION MANAGER
 3-7-2023

112TH STREET SOUTH
C STREET SOUTH TO A STREET SOUTH
SPIRALNAIL WALL SECTIONS 3 OF 3
CRP 5853

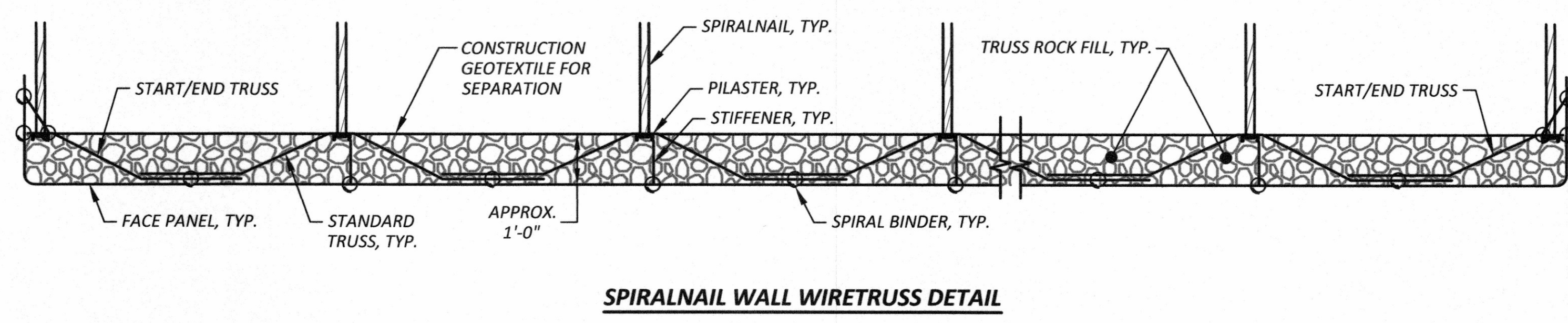
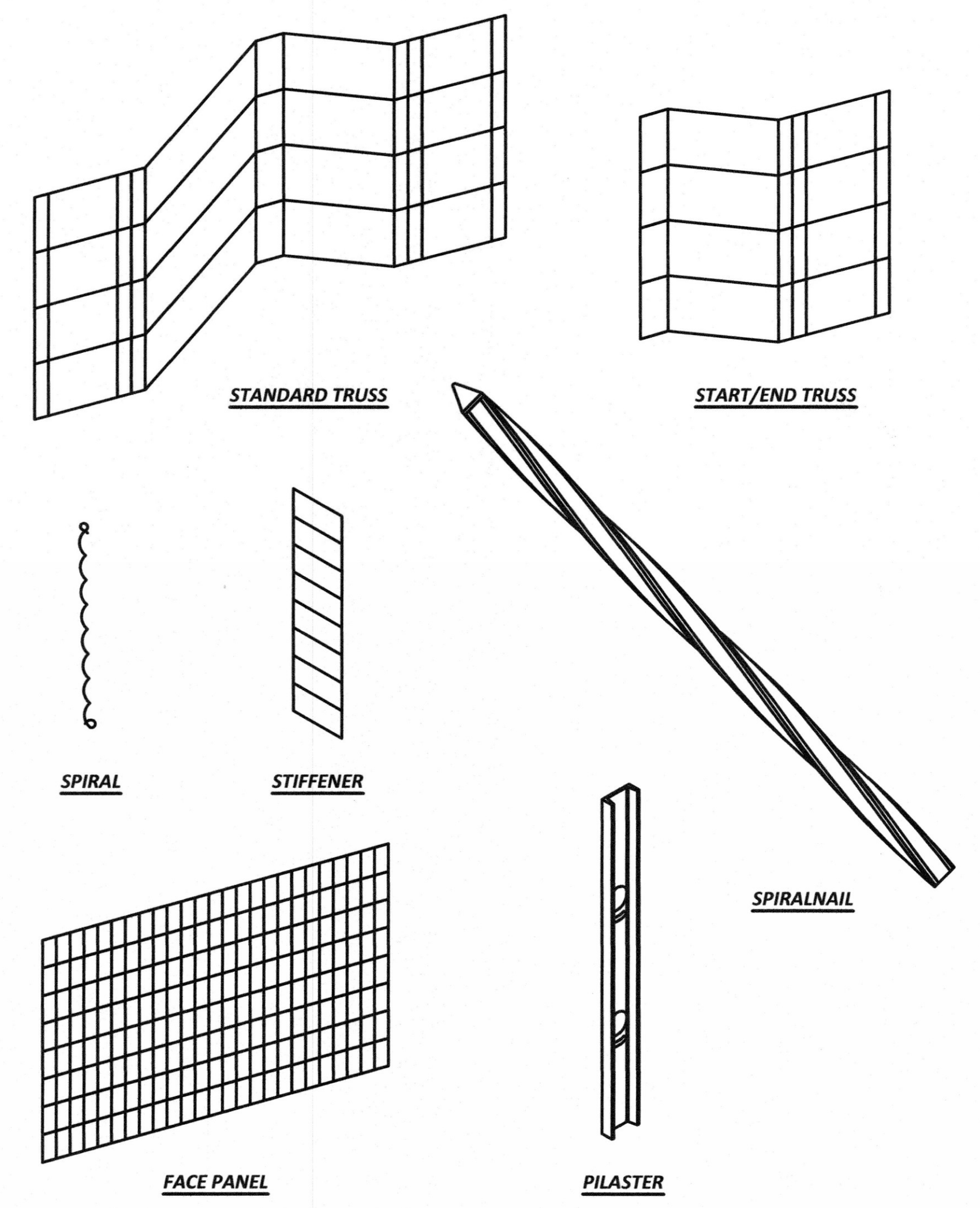
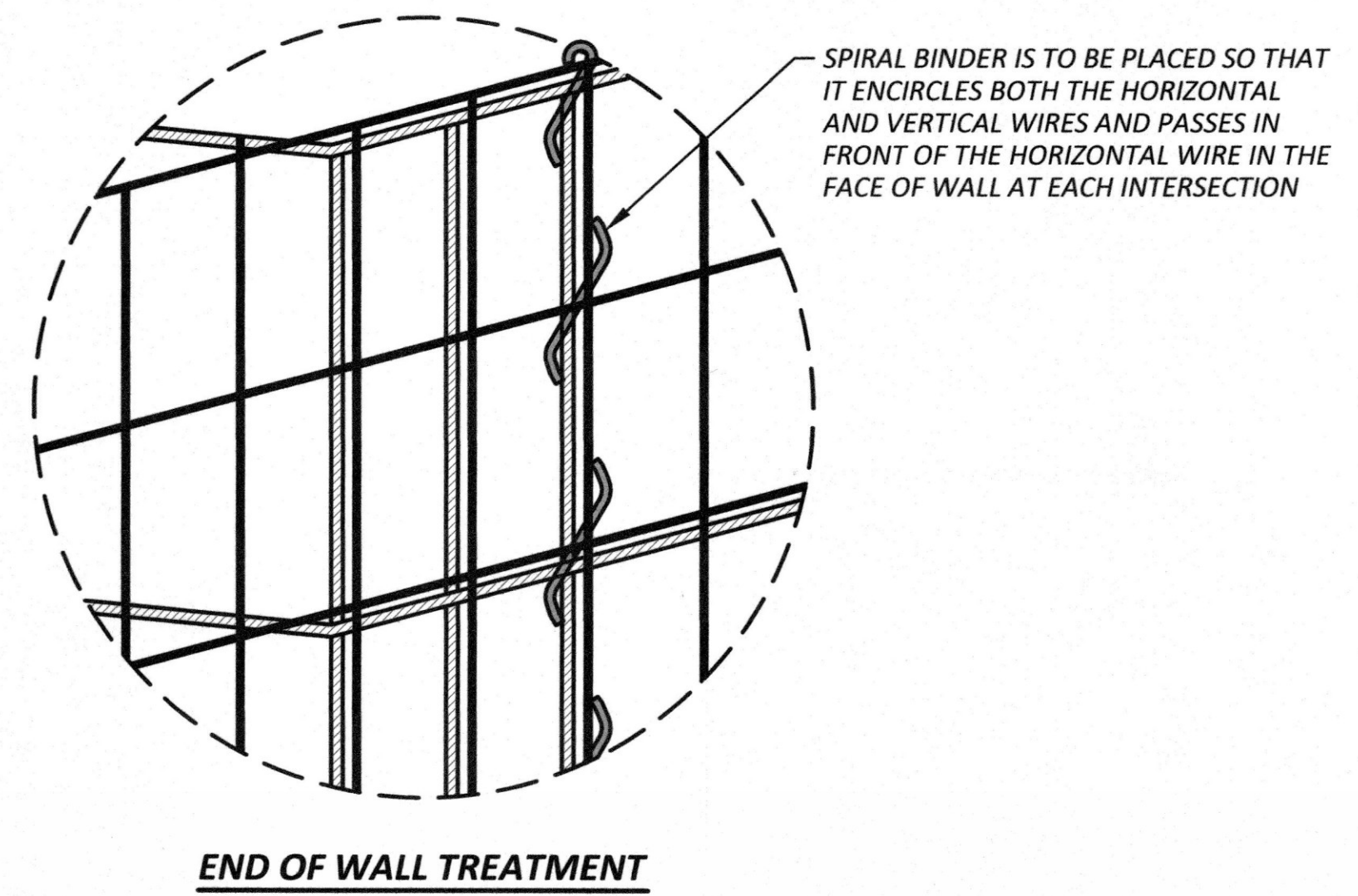
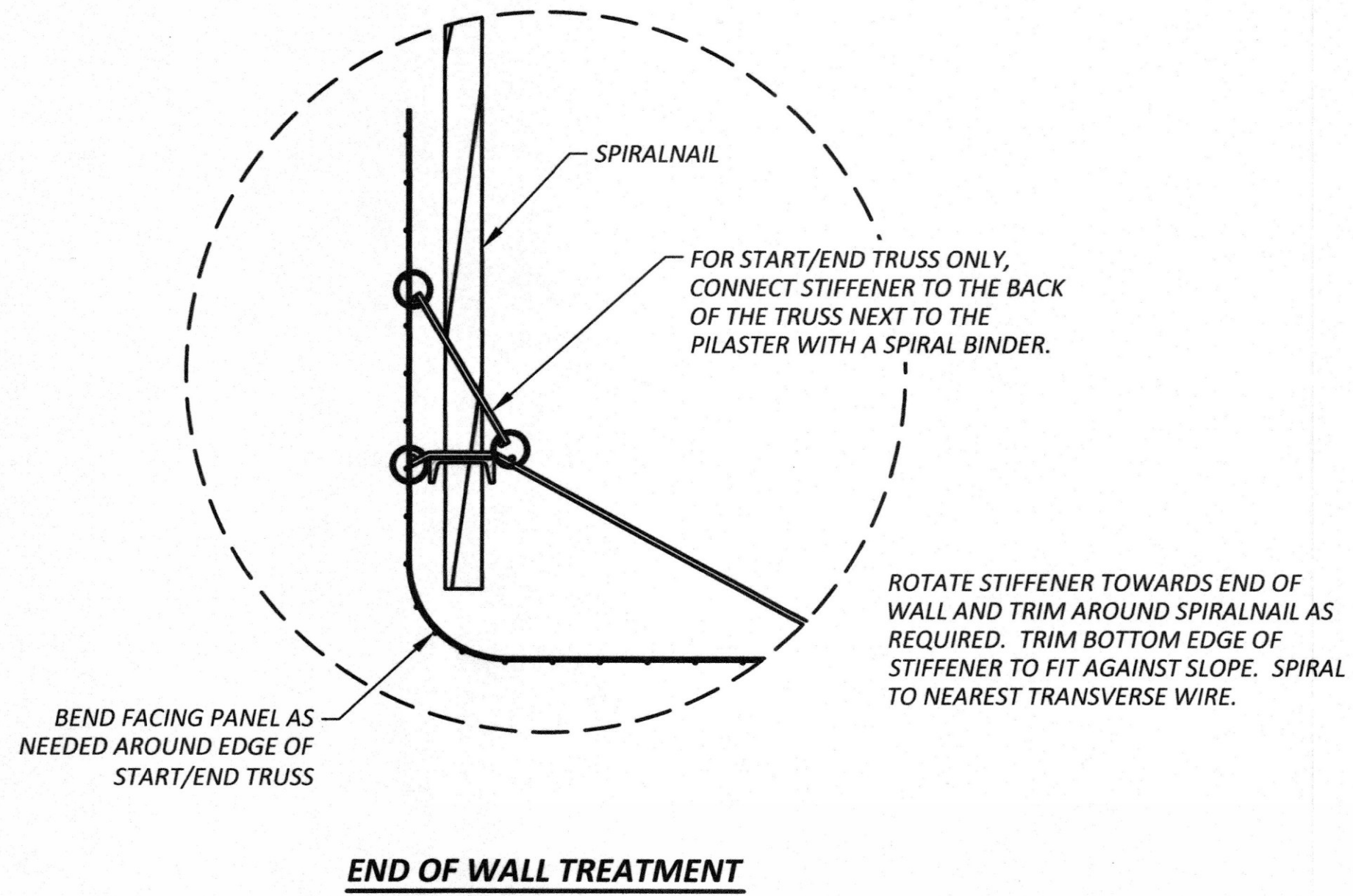
SHEET
26
 OF
53

Drawing: P:\5853-1125T\1125T\BRIDGE\DRAWINGS\CONSTRUCTION\PLANSHEETS\5853_SPIRALNAILWALL.DWG Layout Tab: SPIRAL NAIL WALL DETAILS
 Xrefs: 5853_PROPOSEDROW_INDEX.DWG
 Date: 03/07/2023 Time: 10:11:23 AM Plotted by: AKINGTA



DRAWN BY: R. RUSSOM, P.E.	BOOK NO.: ---
DESIGNED BY: R. RUSSOM, P.E.	SURVEYED BY: S. COOK / R. CROSBY
CHECKED BY: G. AMUNDSEN, P.E.	DATE SURVEYED: JUNE 2017
REVIEWED BY: G. AMUNDSEN, P.E.	DATE PLOTTED: March 7, 2023

NO.	DATE	REVISION	BY	APPROVED

Pierce County
 Planning & Public Works
 Office of the County Engineer
 2702 South 42nd Street, Suite 109
 Tacoma, Washington 98409
 An APWA Accredited Agency

3-9-2023

Office of the County Engineer
 APPROVED BY:

 MELISSA C. McFADDEN, P.E. DATE 3.6.2023
 KRAIG W. SHANER, P.E.
 FIELD ENGINEERING SECTION MANAGER

112TH STREET SOUTH
C STREET SOUTH TO A STREET SOUTH
SPIRALNAIL WALL DETAILS
CRP 5853

SHEET
27
 OF
53

Drawing: P:\5853-1125\1125\125\125\BRIDGE\DRAWINGS\CONSTRUCTION\PLANSHEETS\5853_SPIRALNAILWALL.DWG Layout Tab: SPIRALNAILWALL_DETAILS_PANELS
 Xrefs: 5853_PROPOSEDROW_INDEX.DWG
 Date: 03/07/2023 Time: 10:11:47 AM Plotted by: AKINGTA

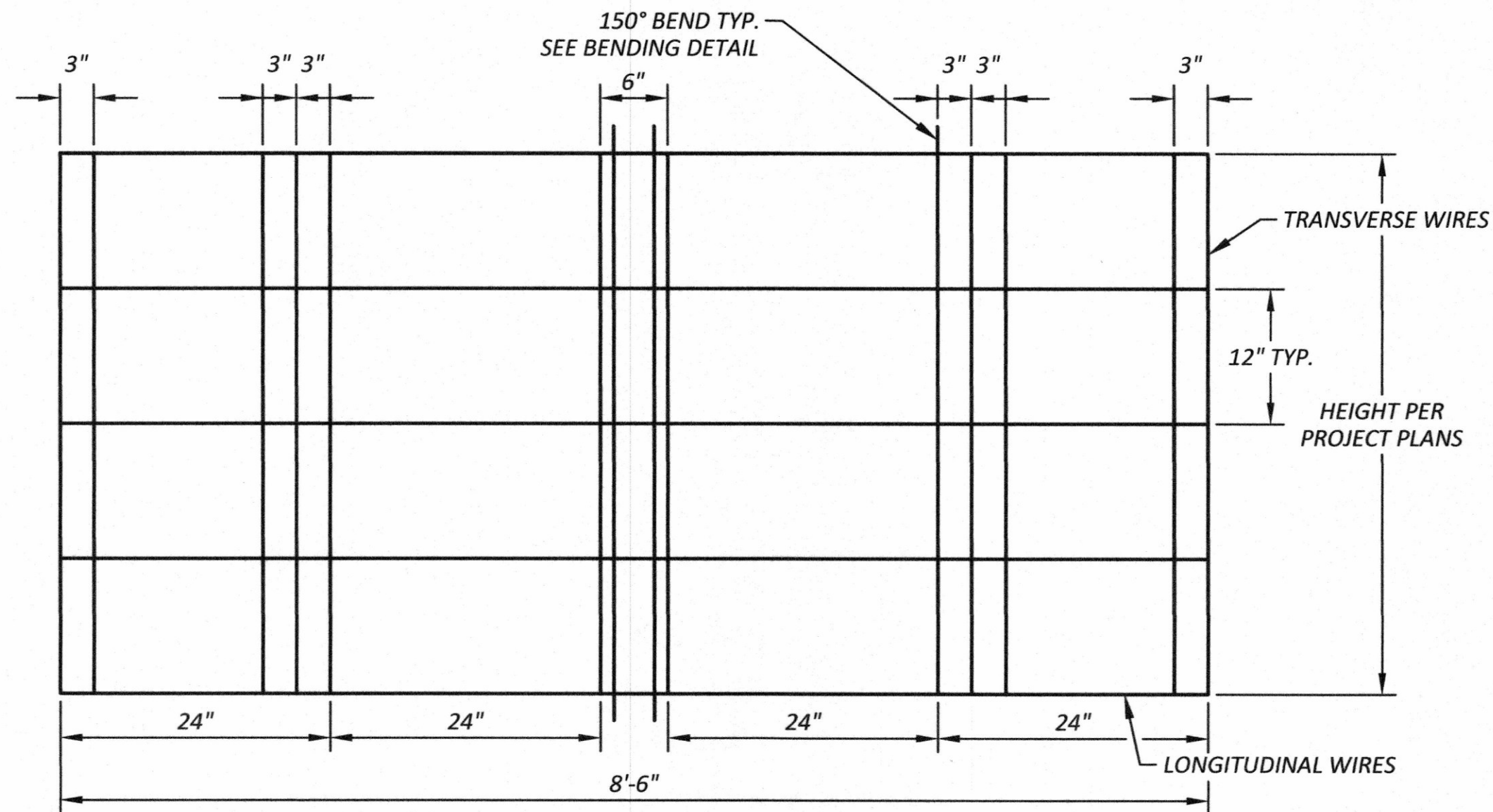

WIRE MAT SIZE AND SPACING

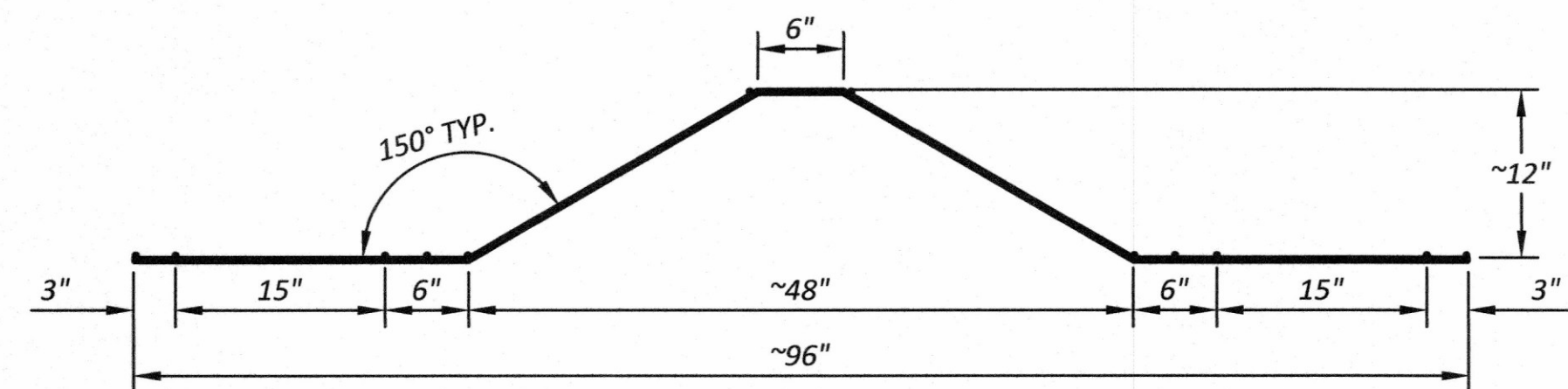

BENDING DETAILS

STANDARD TRUSS

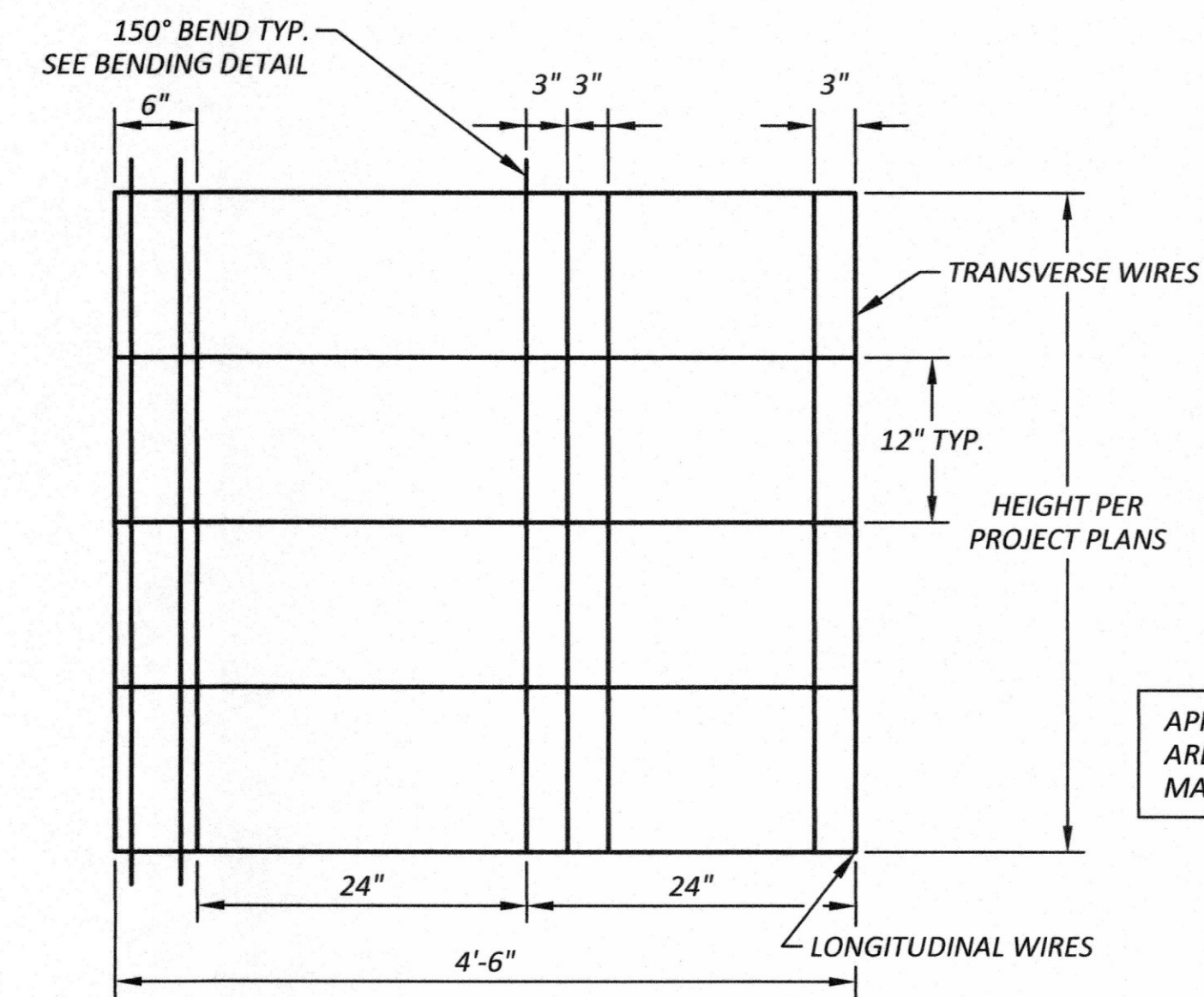

WIRE MAT SIZE AND SPACING

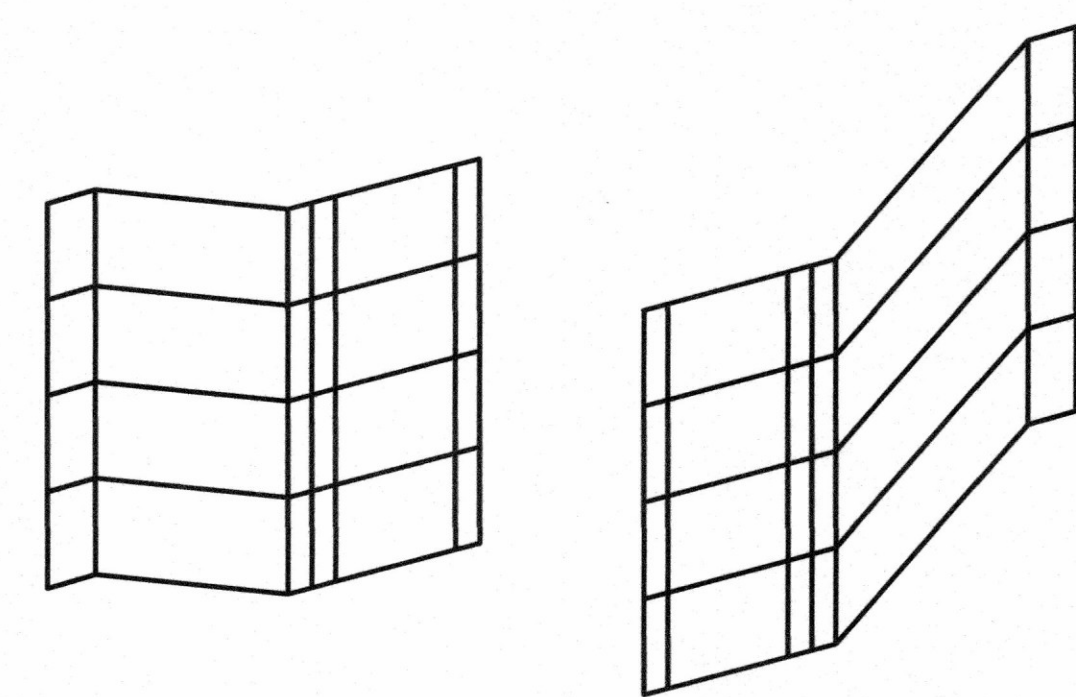

ISOMETRIC VIEW

APPROX. (~) DIMENSIONS ARE BASED ON BENDS AND MAY DIFFER SLIGHTLY

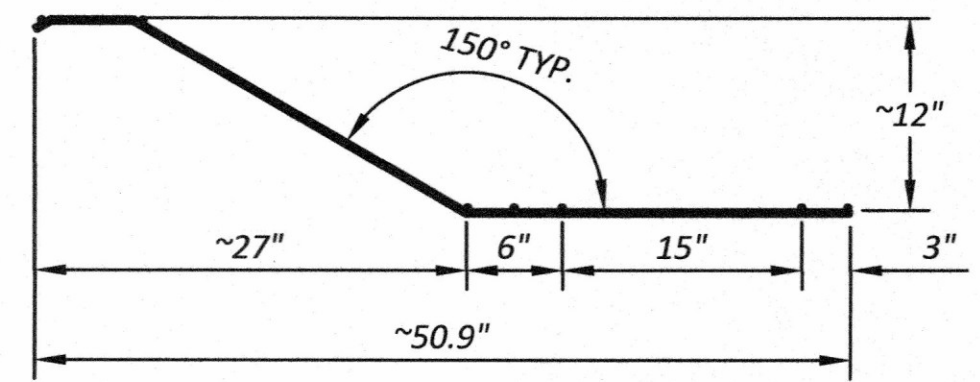

BENDING DETAILS

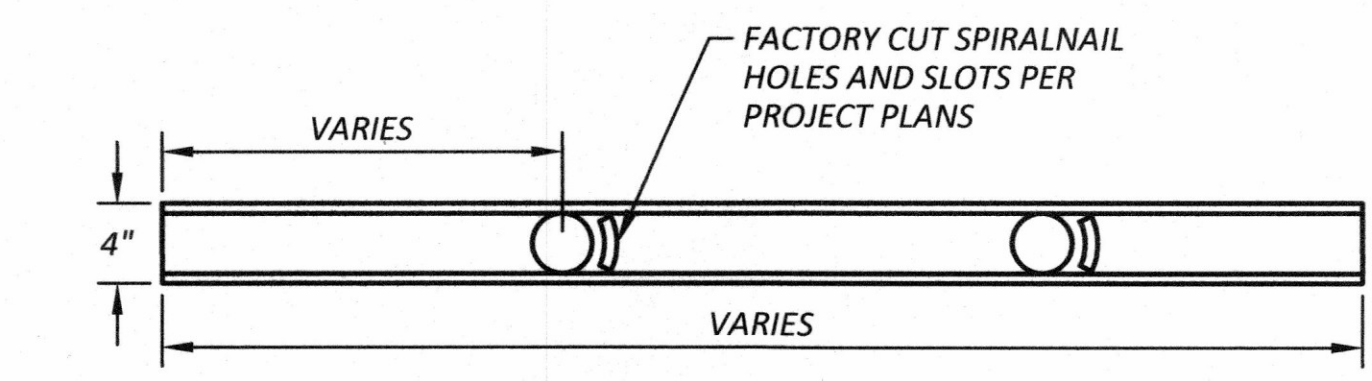

TOP VIEW

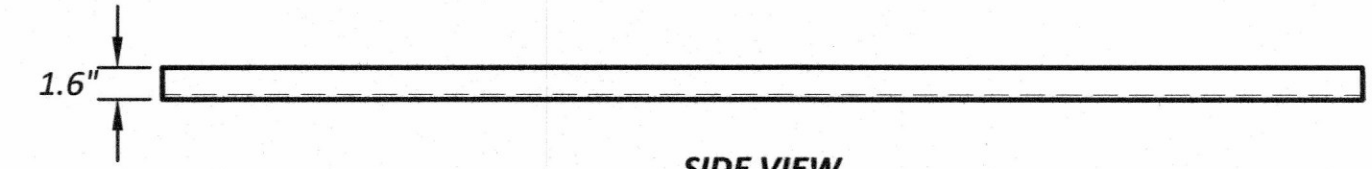

SIDE VIEW

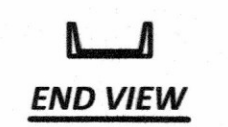

END VIEW

PILASTER CHANNEL

START/END TRUSS

DRAWN BY: R. RUSSOM, P.E.	BOOK NO.:
DESIGNED BY: R. RUSSOM, P.E.	SURVEYED BY: S. COOK / R. CROSBY
CHECKED BY: G. AMUNDSEN, P.E.	DATE SURVEYED: JUNE 2017
REVIEWED BY: G. AMUNDSEN, P.E.	DATE PLOTTED: March 7, 2023

NO.	DATE	REVISION	BY	APPROVED

Pierce County
 Planning & Public Works
 Office of the County Engineer
 2702 South 42nd Street, Suite 109
 Tacoma, Washington 98409
 An APWA Accredited Agency

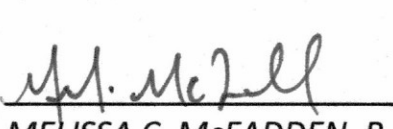

 3-7-2023

Office of the County Engineer
 APPROVED BY:

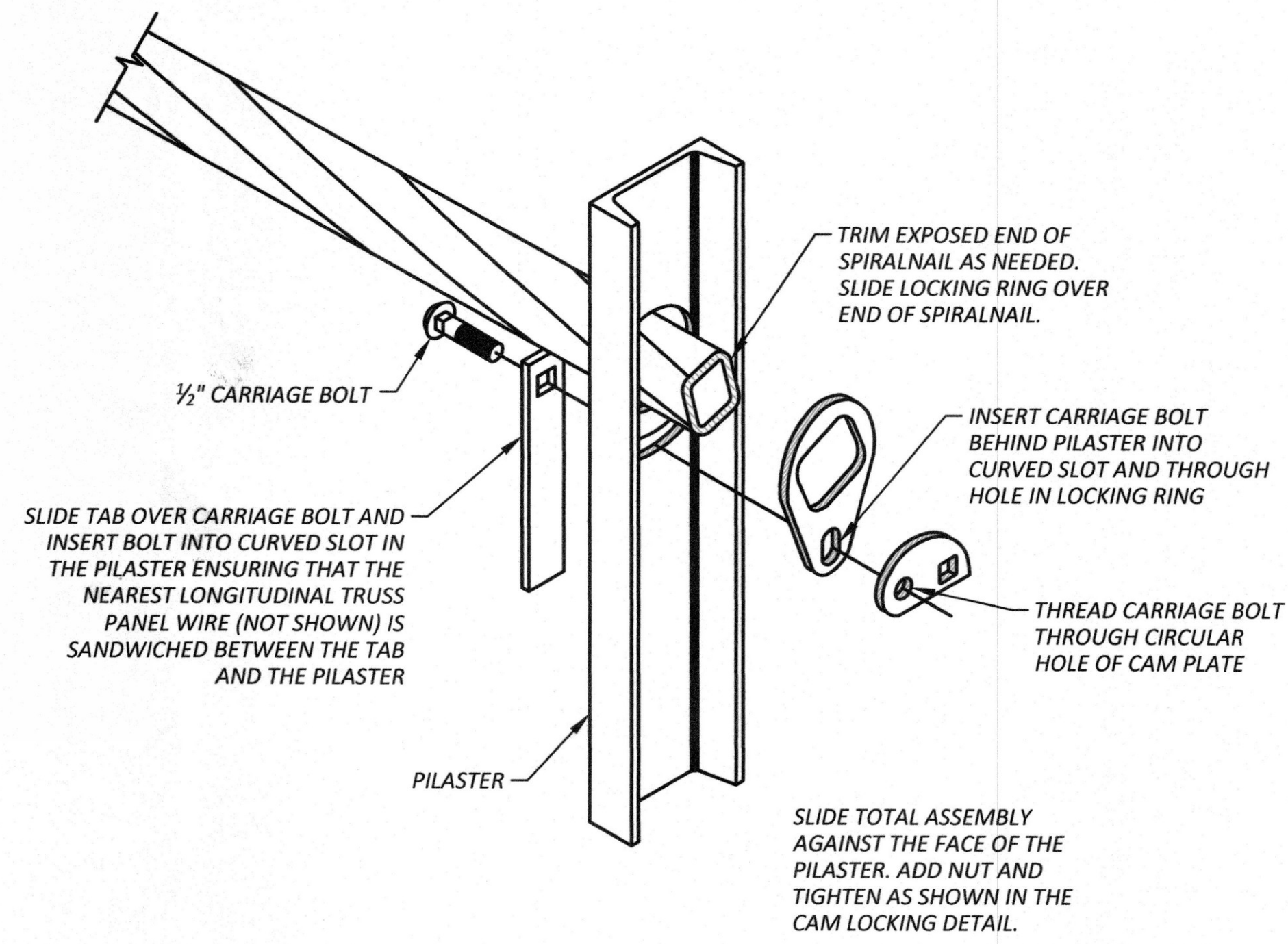
 MELISSA C. McFADDEN, P.E. DATE 3.6.2023
 KRAIG W. SHANER, P.E.
 FIELD ENGINEERING SECTION MANAGER

112TH STREET SOUTH
C STREET SOUTH TO A STREET SOUTH
SPIRALNAIL WALL DETAILS
CRP 5853

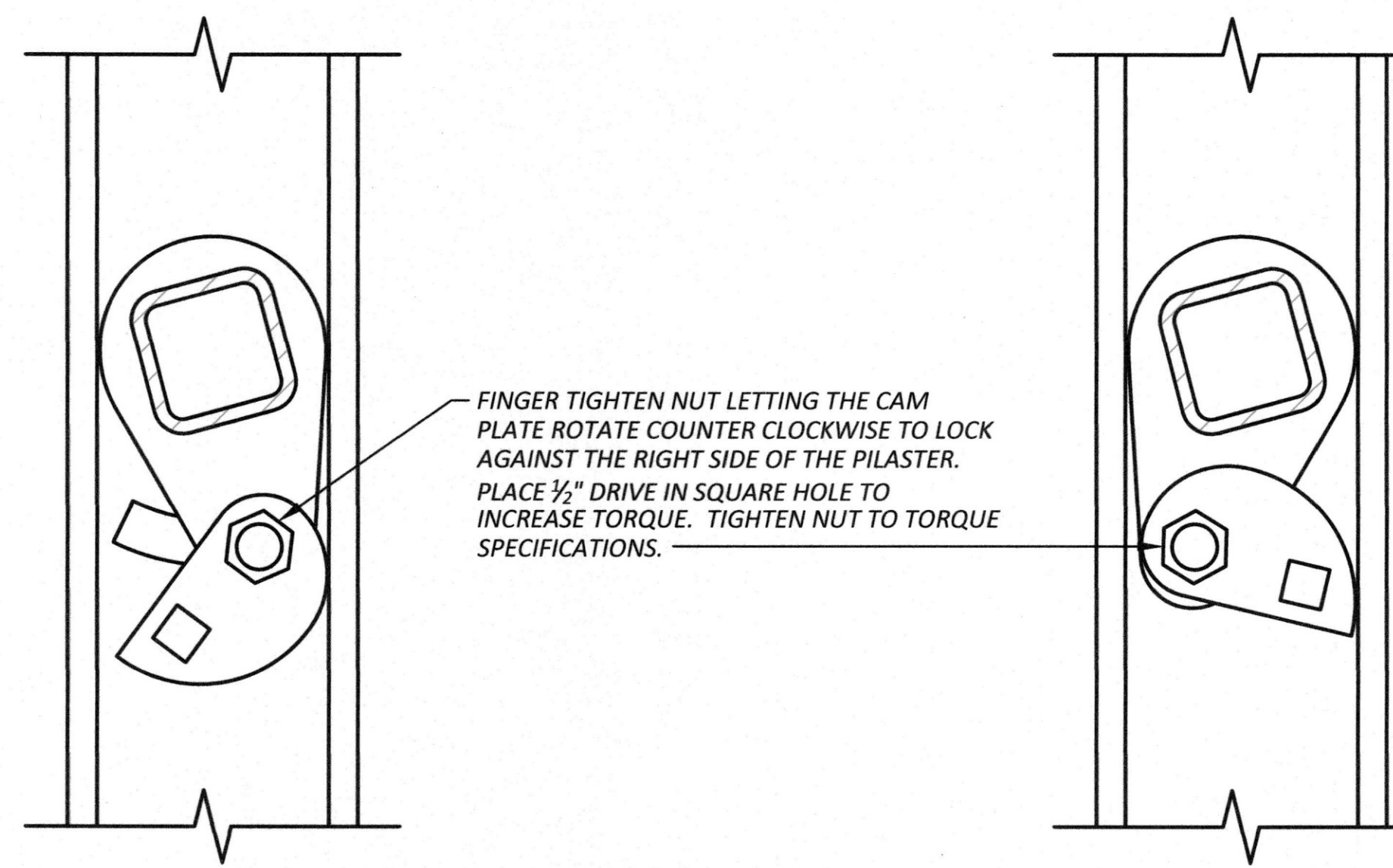

CAM LOCK ASSEMBLY



CAM LOCK LOCKING DETAIL

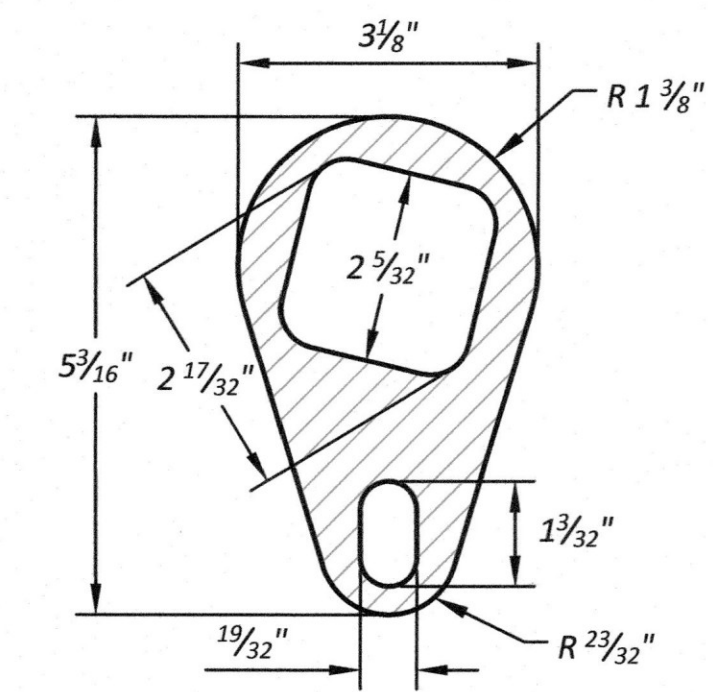

LOCKING RING

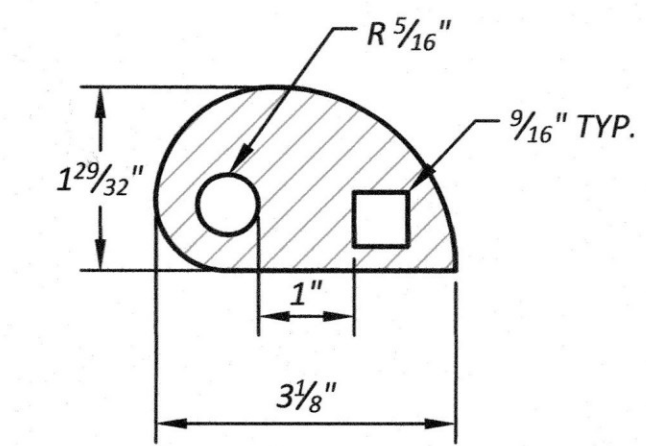

CAM PLATE

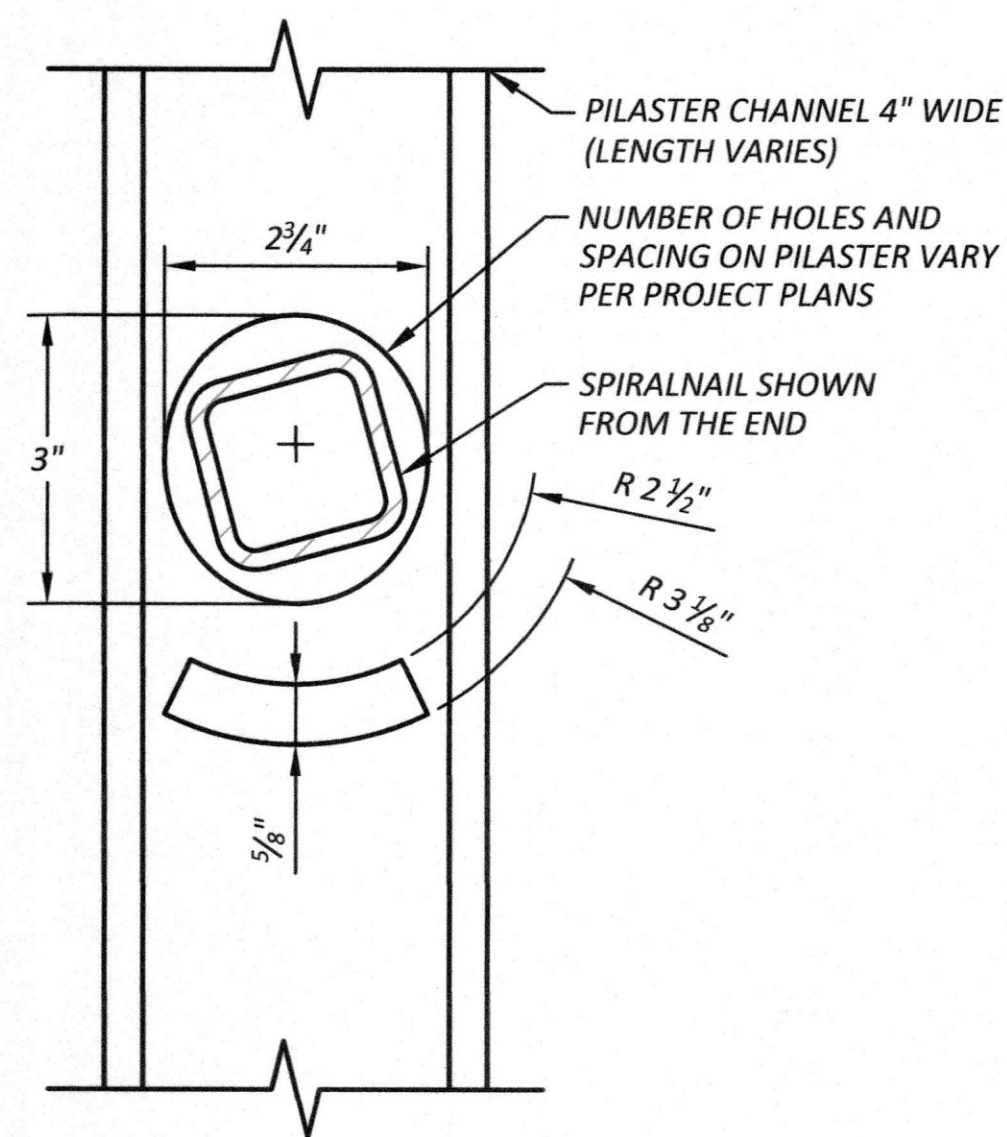

PILASTER

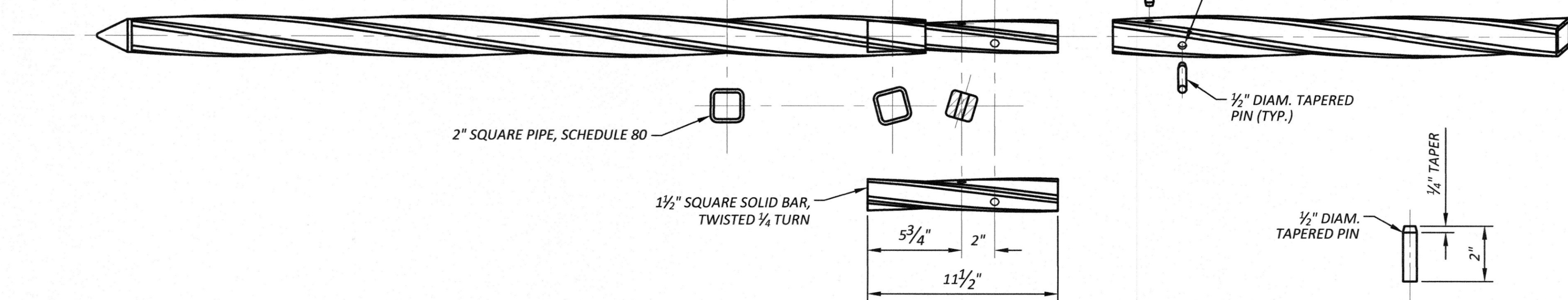

EXTENSION POST

TAPERED PIN

OPTIONAL SPLICING DETAIL FOR SPIRALNAIL

Drawing: P:\5853-1125\1125\BRIDGE\DRAWINGS\CONSTRUCTION\PLANSHEETS\5853_SPIRALNAILWALL.DWG Layout Tab: SPIRALNAILWALL_DETAILS_NAILS
 Xrefs: 5853_PROPOSEDROW_INDEX.DWG
 Date: 03/07/2023 Time: 10:12:09 AM Plotted by: AKINGTA

DRAWN BY: R. RUSSOM, P.E.	BOOK NO.: ---
DESIGNED BY: R. RUSSOM, P.E.	SURVEYED BY: S. COOK / R. CROSBY
CHECKED BY: G. AMUNDSEN, P.E.	DATE SURVEYED: JUNE 2017
REVIEWED BY: G. AMUNDSEN, P.E.	DATE PLOTTED: March 7, 2023

NO.	DATE	REVISION	BY	APPROVED

Pierce County
 Planning & Public Works
 Office of the County Engineer
 2702 South 42nd Street, Suite 109
 Tacoma, Washington 98409
 An APWA Accredited Agency

Office of the County Engineer

APPROVED BY:

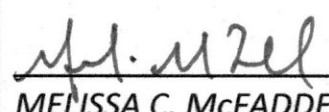
 MELISSA C. McFADDEN, P.E. DATE: 3.6.2023

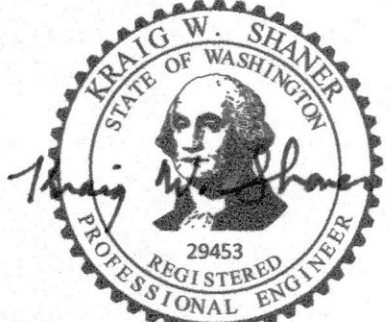
 KRAIG W. SHANER, P.E.
 FIELD ENGINEERING SECTION MANAGER
 3-7-2023

112TH STREET SOUTH
C STREET SOUTH TO A STREET SOUTH
SPIRALNAIL WALL DETAILS
CRP 5853

SHEET
29
 OF
53