

**STEP 1**  
PLACE THE FIRST COURSE OF SOIL REINFORCEMENT MATS ON PREPARED FOUNDATION.

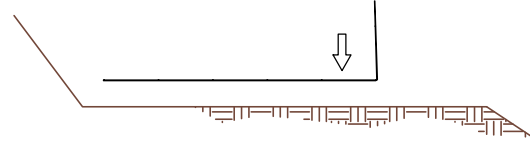

**STEP 2**  
PLACE THE BACKING MAT AGAINST THE INSIDE FACE OF THE SOIL REINFORCEMENT MAT. CLIP THE SECOND-TO-TOP TRANSVERSE WIRE ON THE BACKING MAT TO THE TOP TRANSVERSE WIRE ON THE SOIL REINFORCEMENT MAT.

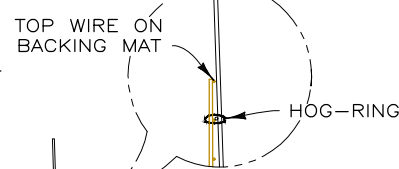

INSTALL CONTINUOUS FILTER FABRIC, MIRAMESH, OR HARDWARE CLOTH. HOG-RING TO TOP WIRE ON THE BACKING MAT.

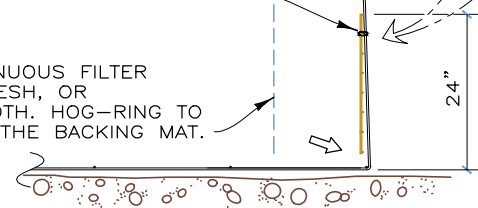

**STEP 3**  
PLACE AND COMPACT THE BACKFILL IN LAYERS AND DENSITIES AS SPECIFIED IN THE PROJECT PLANS. LEAVE A VOID AT THE FACE AS SHOWN.

PLACE THE SECOND COURSE OF SOIL REINFORCEMENT MATS WITH THE BASE LONGITUDINAL WIRES RESTING ON THE TOP TRANSVERSE WIRE OF THE BACKING MAT BELOW. SLIDE THE SOIL REINFORCEMENT MAT INTO ALIGNMENT.

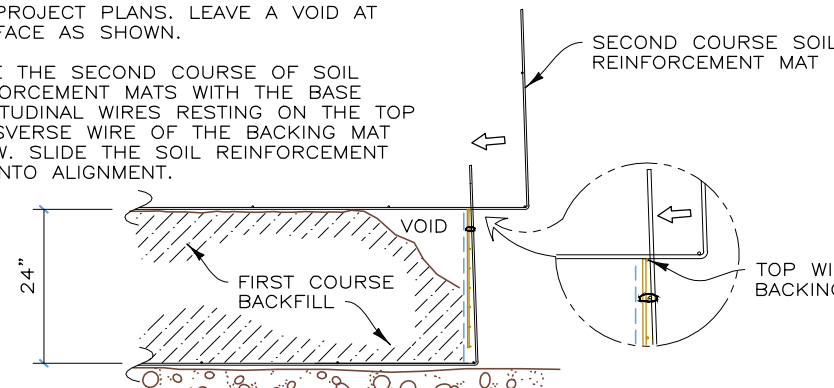

**CONSTRUCTION SEQUENCE**  
NOT TO SCALE

**STEP 4**  
HOOK THE BOTTOM TRANSVERSE WIRE OF THE BACKING MAT OVER THE VERTICAL PRONGS ON THE LOWER MAT. ROTATE THE BACKING MAT TO VERTICAL AND CLIP THE SECOND-TO-TOP TRANSVERSE WIRE ON THE BACKING MAT TO THE TOP WIRE ON THE SOIL REINFORCEMENT MAT.

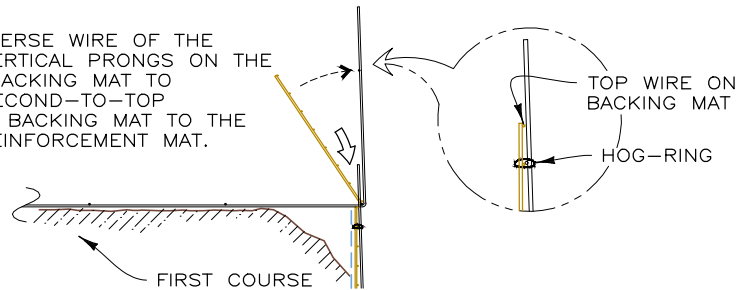

**STEP 5**  
INSTALL THE CONTINUOUS FILTER FABRIC, MIRAMESH, OR HARDWARE CLOTH. PLACE AND COMPACT THE BACKFILL TO THE BASE ELEVATION OF THE NEXT MAT. REPEAT STEPS 3 THROUGH 5 TO THE TOP LIFT.

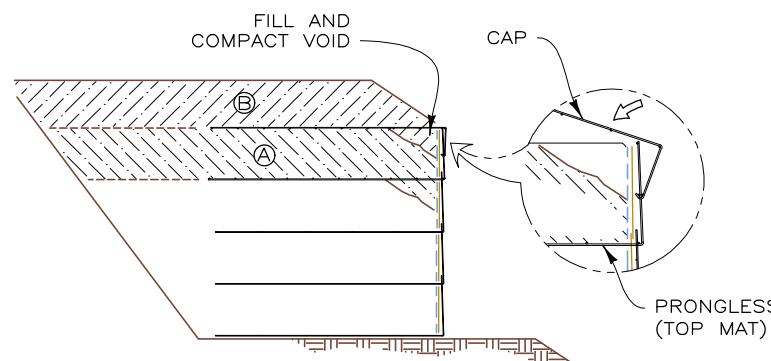
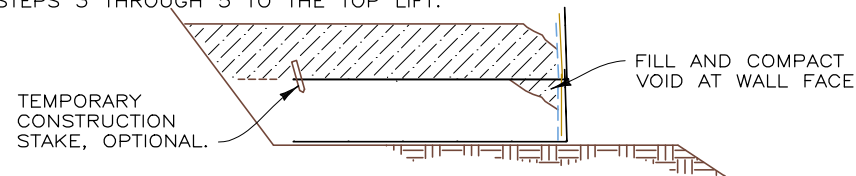

**STEP 6: TOP LIFT**  
PLACE THE TOP LIFT PRONGLESS MAT, BACKING MAT AND CONTINUOUS FILTER FABRIC, MIRAMESH, OR HARDWARE CLOTH. PLACE AND COMPACT BACKFILL IN AREA "A". HOOK THE CAP OVER THE MIDDLE TRANSVERSE WIRE ON THE PRONGLESS MAT, AND ROTATE INTO PLACE. BACKFILL "B" TO 1'-6" MIN. COVER OVER THE CAP.

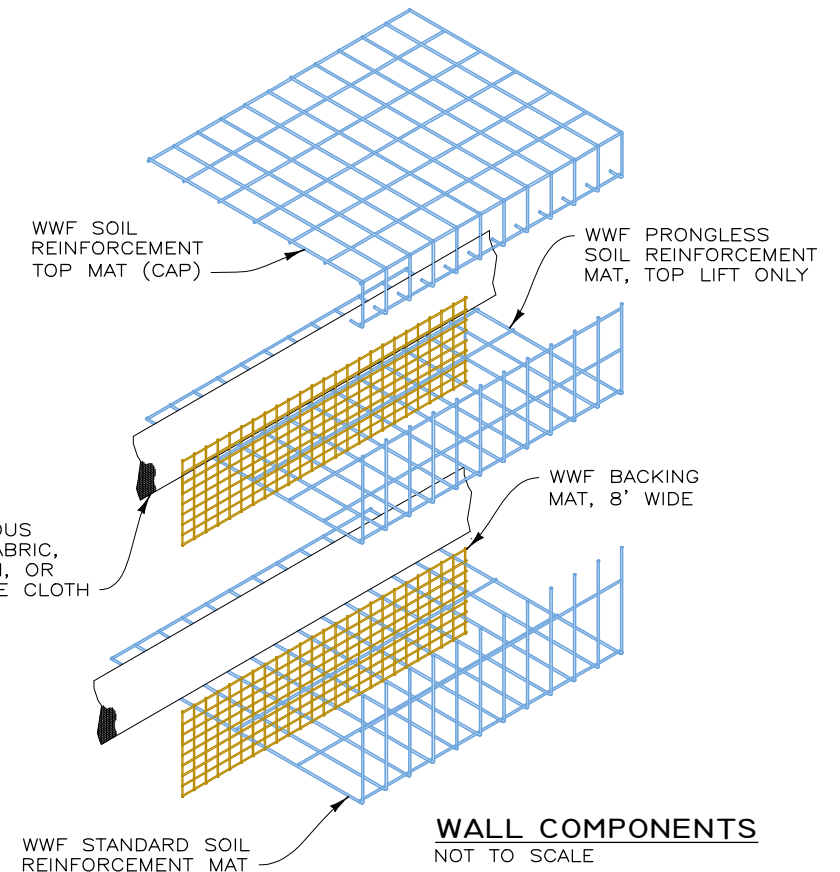

**WALL COMPONENTS**  
NOT TO SCALE

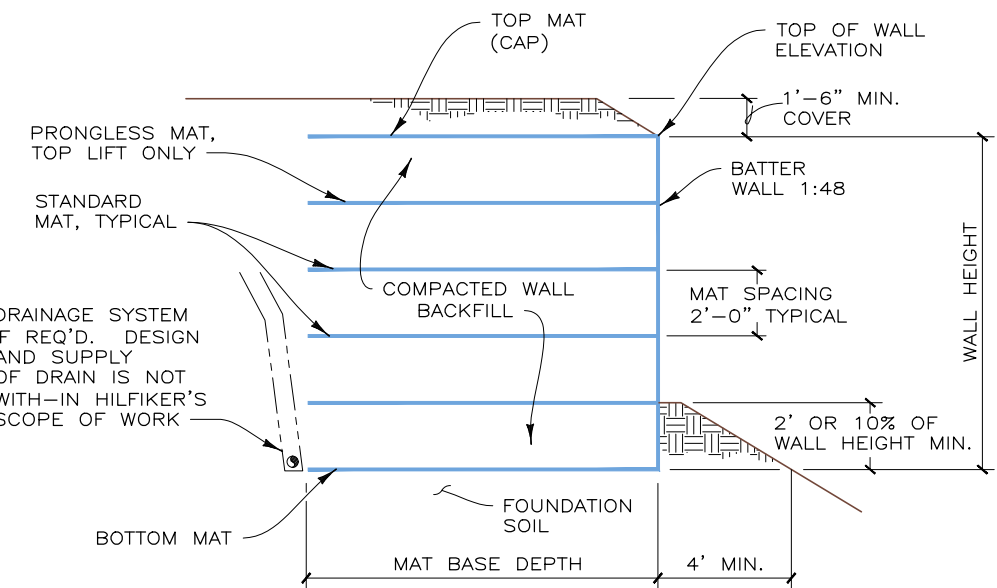

**TYPICAL SECTION**  
NOT TO SCALE

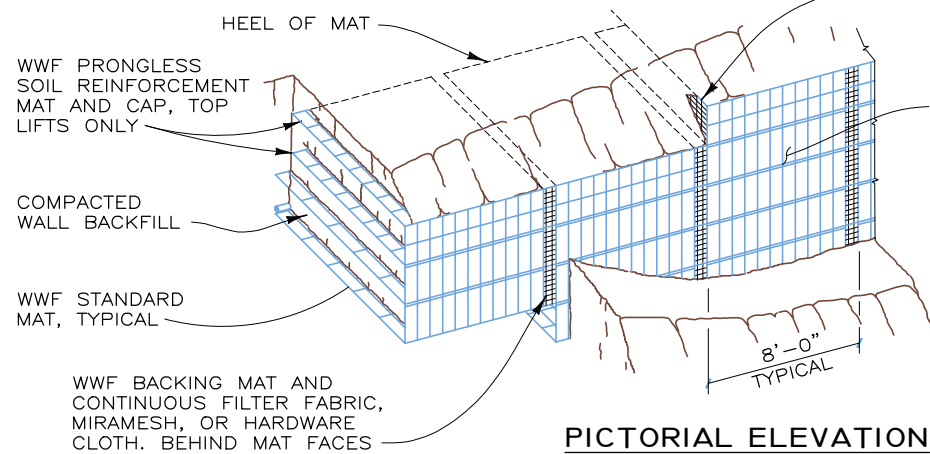

**PICTORIAL ELEVATION**  
NOT TO SCALE

RETURN BACKING MAT AND CONTINUOUS FILTER FABRIC, MIRAMESH, OR HARDWARE CLOTH. AT EXPOSED END OF TOP LIFTS, TYPICAL

FACE OF WELDED WIRE WALL

**NOTES:**

1. THESE DETAILS ARE INTENDED FOR INFORMATION ONLY. THEY MAY OR MAY NOT APPLY TO SPECIFIC PROJECTS.
2. THESE DETAILS SHOW HARDWARE CLOTH BEHIND THE BACKING MATS. IN SOME APPLICATIONS, FILTER FABRIC OR MIRAMESH WILL BE REQUIRED INSTEAD OF HARDWARE CLOTH. IN THAT CASE, THESE DETAILS SHOULD BE REVISED ACCORDINGLY.
3. WWF=WELDED WIRE FABRIC.

**GRAPHIC SCALE**

LINE IS 20 UNITS LONG ON ORIGINAL DRAWING

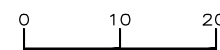

PROJ.MGR.

ENGINEER

CADD BY

HRW

**HILFIKER RETAINING WALLS**



1902 Hilfiker Lane  
Eureka, CA 95503-5711  
TOLL-FREE 800.762.8962  
PH 707.443.5093 FAX 707.443.2891  
WEBSITE www.hilfiker.com E-MAIL info@hilfiker.com



DWG DATE

NOV 98

REVISION DATE

1 AUG 22

SCALE

NOTED

STANDARD DRAWING

WELDED WIRE RETAINING WALL  
24" LIFTS

STANDARD DETAILS

PROJECT NO.

SHEET

1

OF 3

STANDARD DETAILS WELDED WIRE WALL 8' WIDE MATS

THIS DRAWING IS FURNISHED SOLELY FOR THE USE OF OR IN CONNECTION WITH THIS PROJECT AND THE PROPRIETARY INFORMATION SHOWN HEREON IS NOT TO BE TRANSMITTED TO ANY OTHER ORGANIZATION WITHOUT SPECIFIC AUTHORIZATION BY THE HILFIKER COMPANY. HILFIKER RETAINING WALLS ARE PROTECTED BY ONE OR MORE OF THE FOLLOWING PATENTS: 2,436,613; 2,436,697; 2,886,616; 4,117,686; 4,329,089; 4,324,506; 4,391,557; 4,505,621; 4,343,318; 4,661,023; 4,856,939; 4,929,125; 5,076,735; 5,647,695; 5,722,799; 5,733,072; 6,357,970B1; 6,874,975B2; 7,033,118B2; AND OTHERS. OTHER PATENTS PENDING (2008)

REV.NO.	DATE	BY	DESCRIPTION
1	6 JAN 03	DR	MINOR REVISIONS
2	17 OCT 08	AMJ	UPDATED BORDER, MINOR REVISIONS
3	1 AUG 12	AMJ	ADDED COLOR TO DETAILS
4	23 OCT 13	AMJ	MINOR REVISIONS, FIXED LEADERS
5	1 AUG 22	NMD	ADDED MIRAMESH

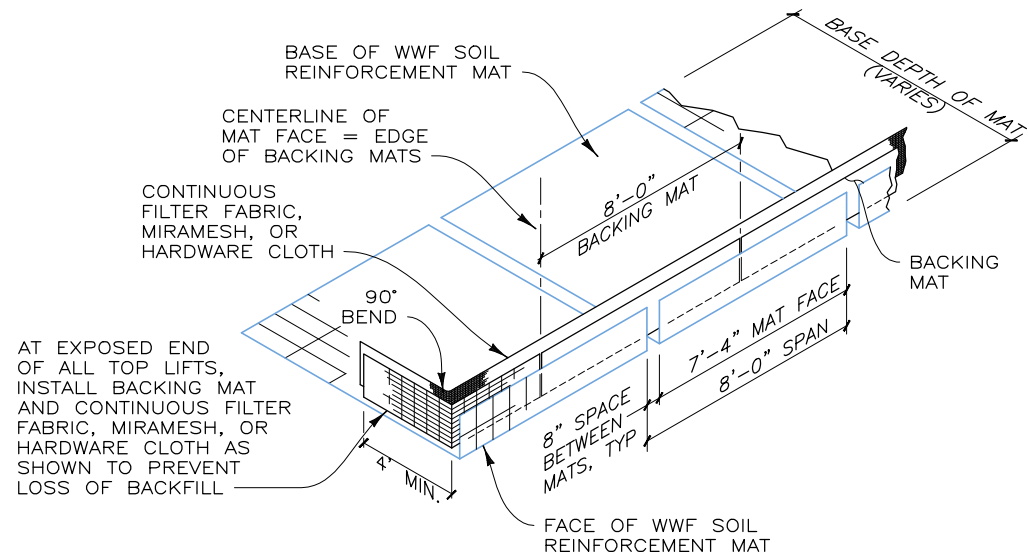

**ISOMETRIC VIEW**  
**WELDED WIRE WALL COMPONENTS WITH RETURN MAT**  
 NOT TO SCALE

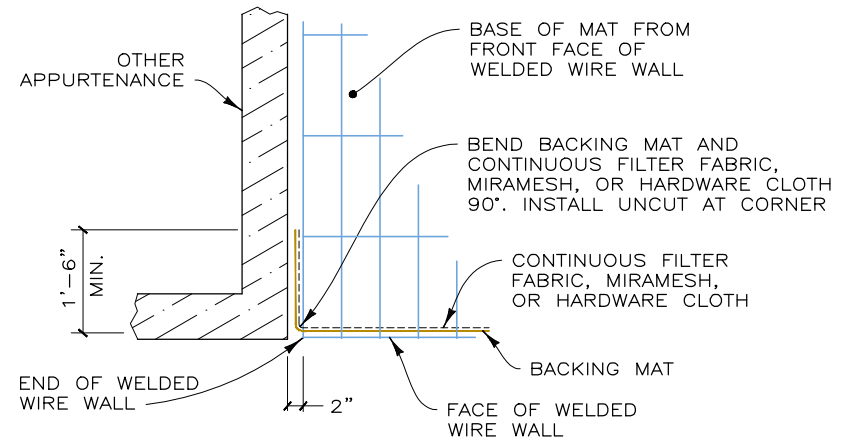

**PLAN VIEW**  
**WELDED WIRE WALL END AT OTHER APPURTENANCE**  
 NOT TO SCALE

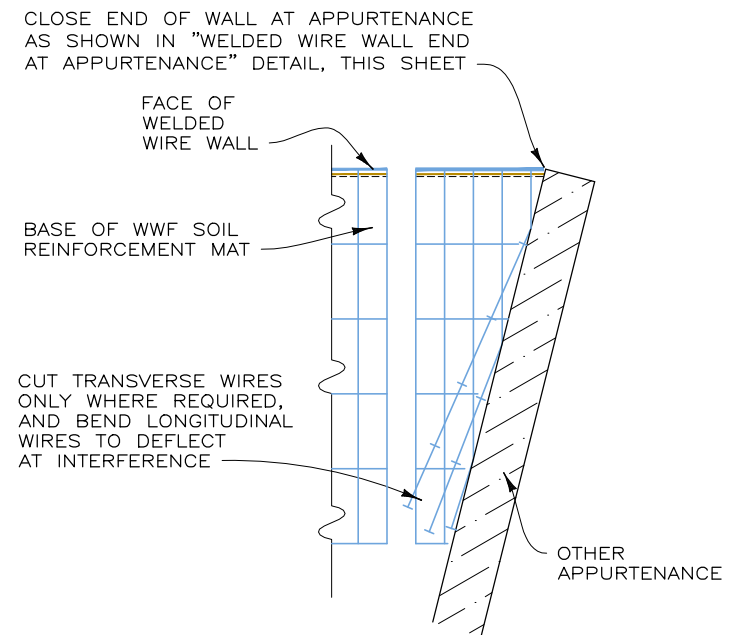

**PLAN VIEW**  
**DEFLECTED LONGITUDINAL WIRES**  
 NOT TO SCALE

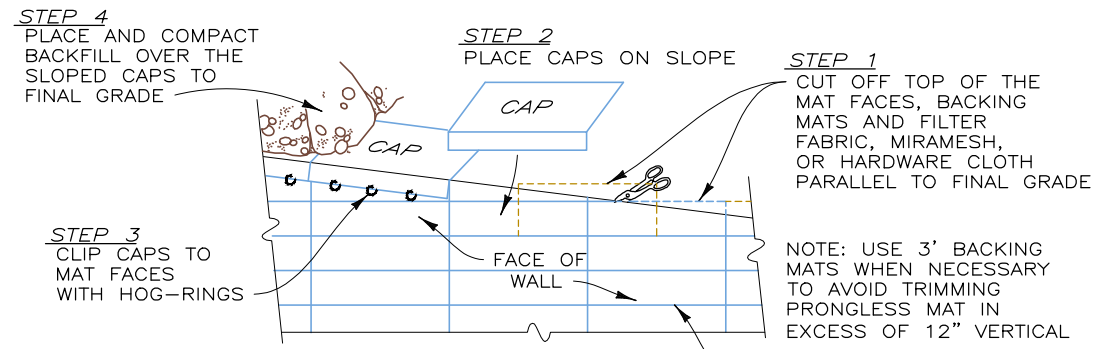

**PICTORIAL ELEVATION**  
**SLOPED CAP MAT DETAIL**  
 NOT TO SCALE

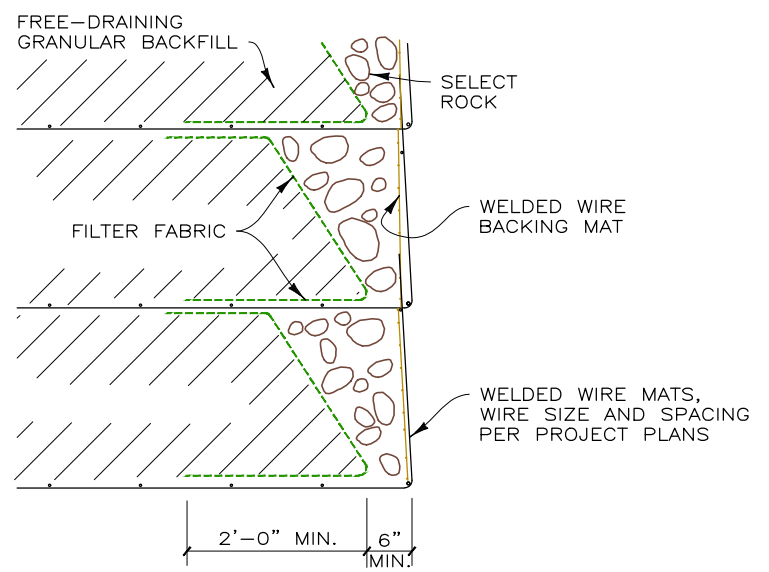

**SECTION**  
**ROCK FACING DETAIL**  
 NOT TO SCALE

**LEGEND**  
 (THIS DETAIL ONLY)

P	PRONGLESS MAT
S	STANDARD MAT
S	STANDARD MAT

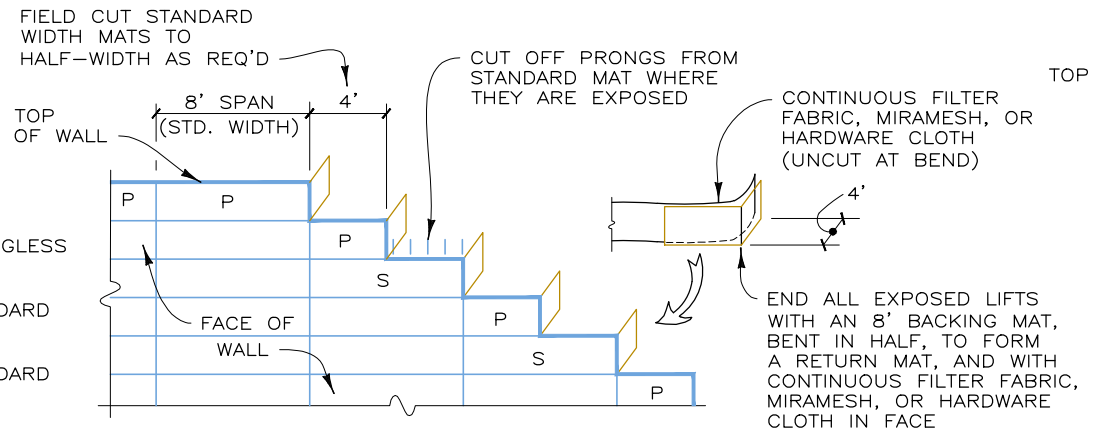

**RETURN MATS AND TOP OF WALL DETAIL**  
 NOT TO SCALE

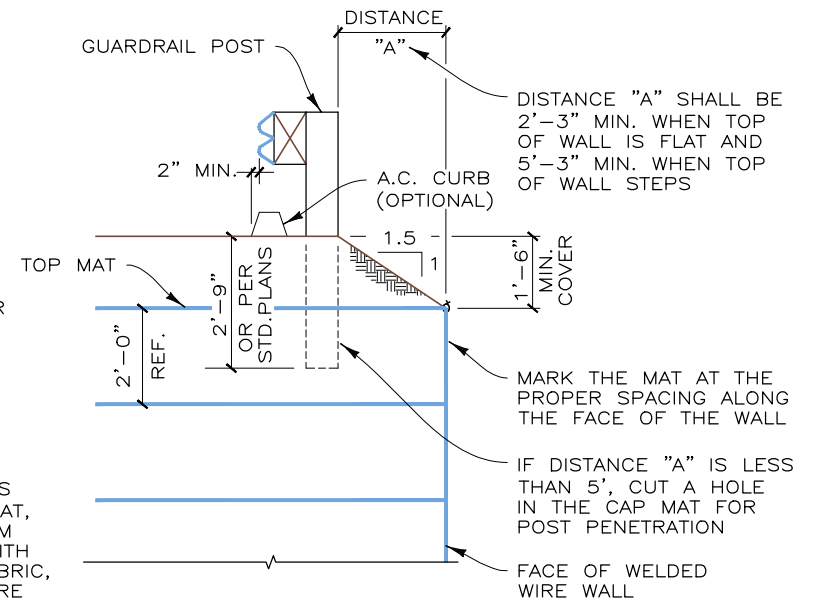

**SECTION**  
**GUARDRAIL DETAIL**  
 NOT TO SCALE  
 (FENCE DETAIL SIMILAR)

STANDARD DETAILS\WELDED WIRE WALL\8' WIDE MATS

THIS DRAWING IS FURNISHED SOLELY FOR THE USE OF OR IN CONNECTION WITH THIS PROJECT AND THE PROPRIETARY INFORMATION SHOWN HEREON IS NOT TO BE TRANSMITTED TO ANY OTHER ORGANIZATION WITHOUT SPECIFIC AUTHORIZATION BY THE HILFIKER COMPANY. HILFIKER RETAINING WALLS ARE PROTECTED BY ONE OR MORE OF THE FOLLOWING PATENTS: 243,613; 243,697; 288,616; 4,117,686; 4,329,089; 4,324,506; 4,391,557; 4,505,621; 4,343,318; 4,661,023; 4,856,939; 4,929,125; 5,076,735; 5,647,695; 5,722,799; 5,733,072; 6,357,970B1; 6,874,975B2; 7,033,118B2; AND OTHERS. OTHER PATENTS PENDING (2008)

REV.NO.	DATE	BY	DESCRIPTION
1	6 JAN 03	DR	MINOR REVISIONS
2	17 OCT 08	AMJ	UPDATED BORDER, MINOR REVISIONS
3	1 AUG 12	AMJ	ADDED COLOR TO DETAILS
4	23 OCT 13	AMJ	MINOR REVISIONS, FIXED LEADERS
5	1 AUG 22	NMD	ADDED MIRAMESH

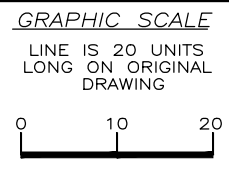

PROJ.MGR.  
 ENGINEER  
 CADD BY  
 HRW

**HILFIKER RETAINING WALLS**

1902 Hilfiker Lane  
 Eureka, CA 95503-5711  
 TOLL-FREE 800.762.8962  
 PH 707.443.5093 FAX 707.443.2891  
 WEB SITE www.hilfiker.com E-MAIL info@hilfiker.com

SINCE 1902  
 QUALITY PRODUCTS

DWG DATE  
 NOV 98  
 REVISION DATE  
 1 AUG 22  
 SCALE  
 NOTED

STANDARD DRAWING	PROJECT NO.
WELDED WIRE RETAINING WALL 24" LIFTS	SHEET 2
STANDARD DETAILS	OF 3

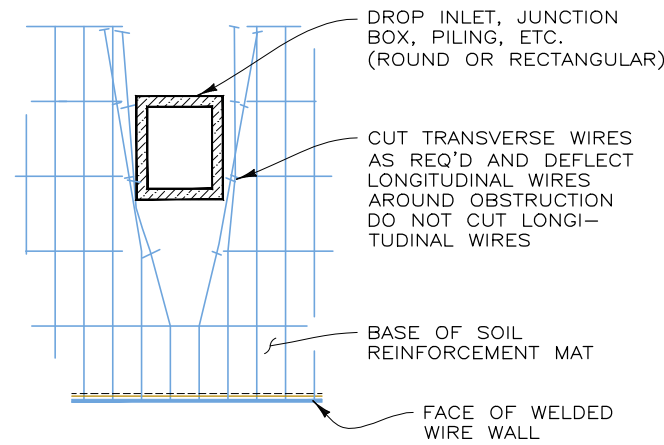

PLAN VIEW

**MAT PENETRATION DETAIL**  
NOT TO SCALE

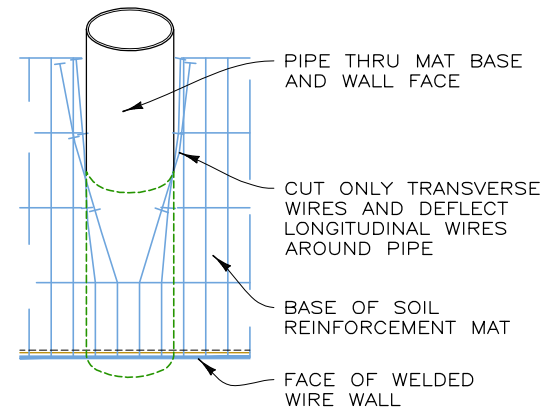

PLAN VIEW

**ANGLED PIPE PENETRATION**  
NOT TO SCALE

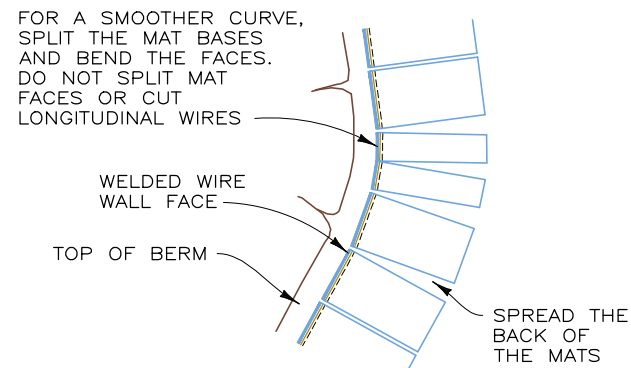

PLAN VIEW

**CONCAVE CURVE**  
NOT TO SCALE

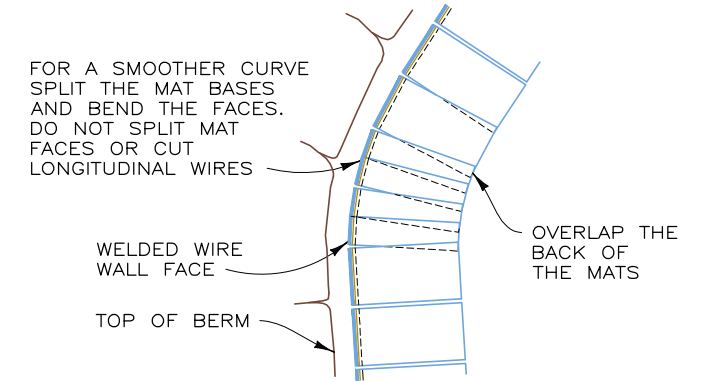

PLAN VIEW

**CONVEX CURVE**  
NOT TO SCALE

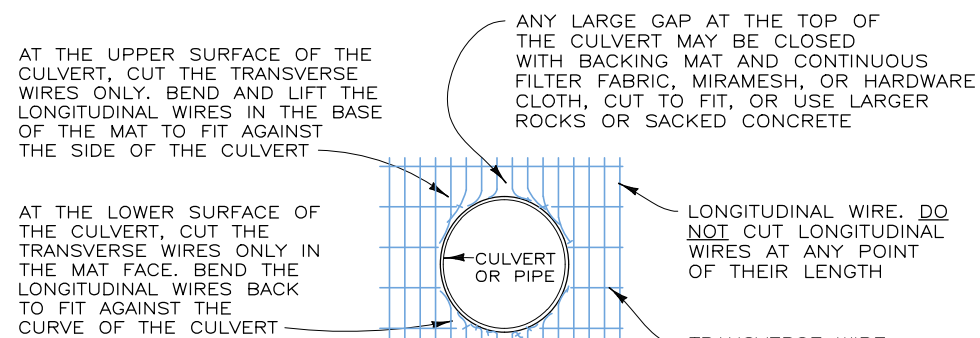

ELEVATION

**CULVERT THRU WALL FACE**  
NOT TO SCALE

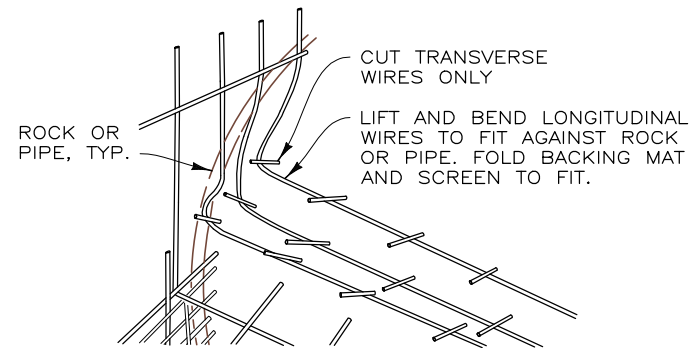

PICTORIAL

**FITTING MATS TO OBSTRUCTION**  
NOT TO SCALE

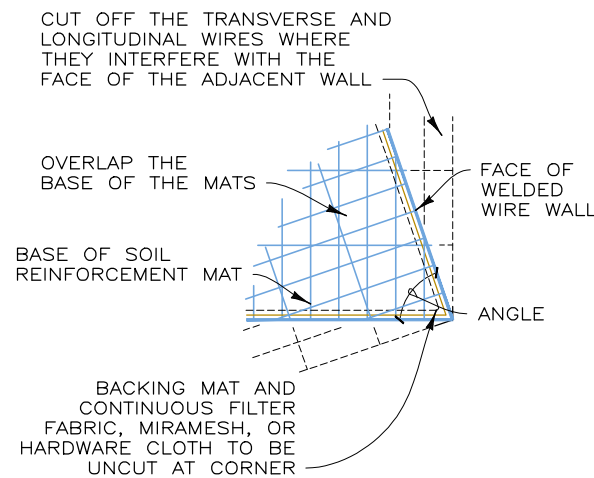

**ACUTE CONVEX ANGLE**  
NOT TO SCALE

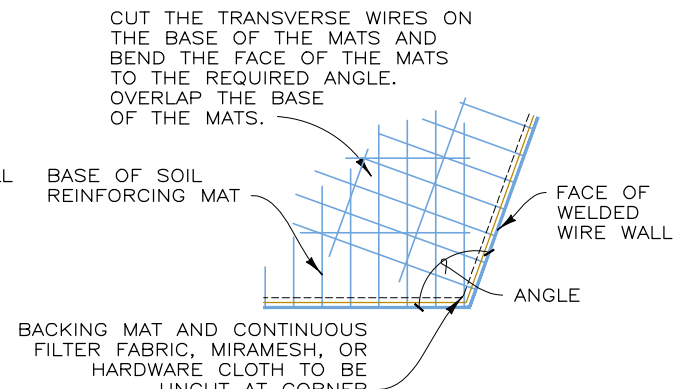

PLAN VIEW

**OBTUSE CONVEX ANGLE**  
NOT TO SCALE

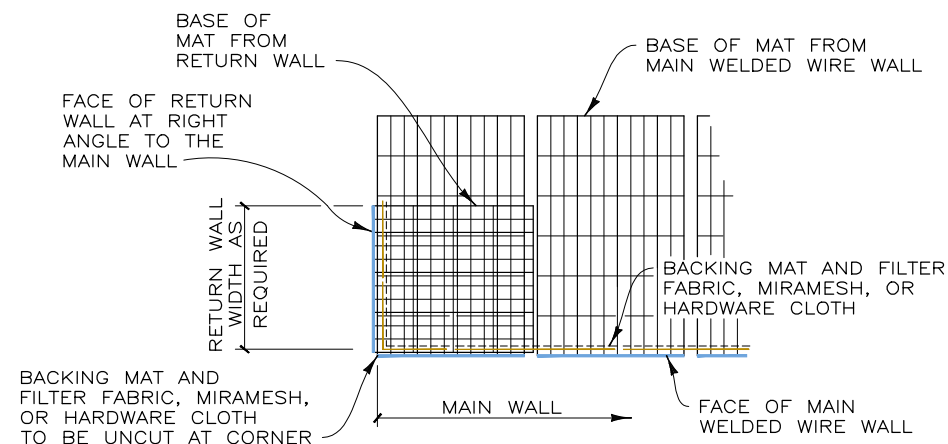

PLAN VIEW

**RETURN WALL DETAIL**  
NOT TO SCALE

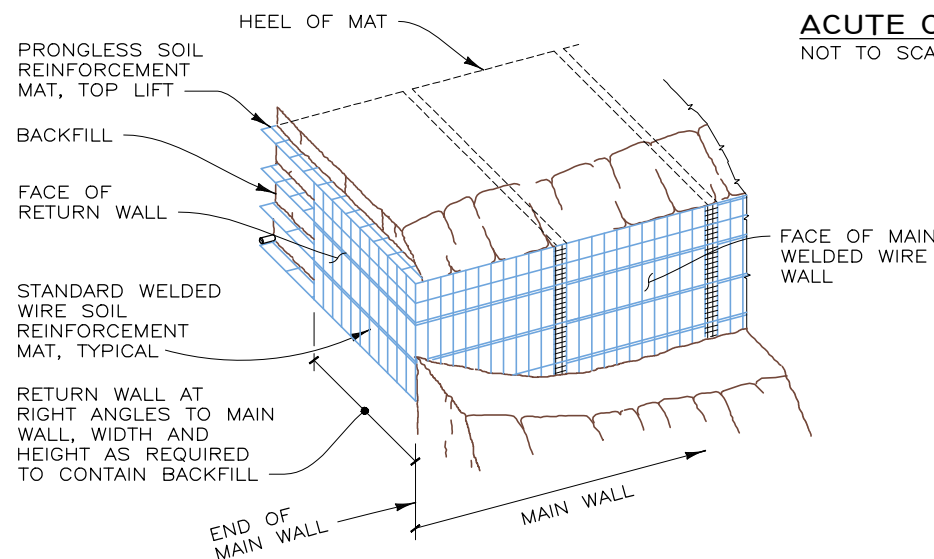

PICTORIAL

**RETURN WALL DETAIL**  
NOT TO SCALE

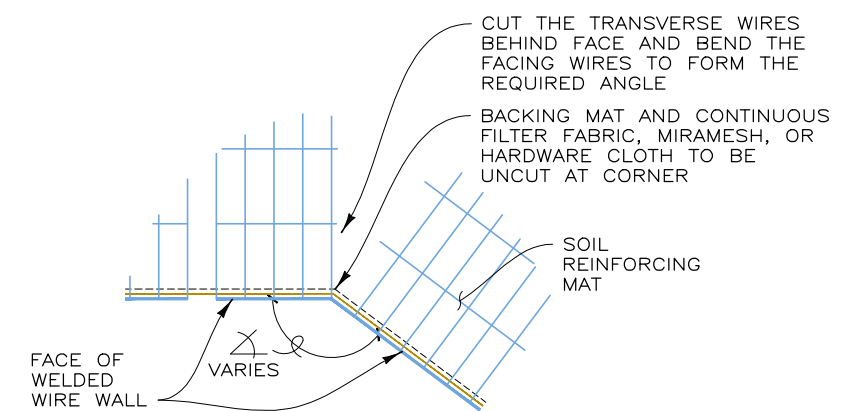

PLAN VIEW

**CONCAVE ANGLE DETAIL**  
NOT TO SCALE

STANDARD DETAILS WELDED WIRE WALL 8' WIDE MATS

THIS DRAWING IS FURNISHED SOLELY FOR THE USE OF OR IN CONNECTION WITH THIS PROJECT AND THE PROPRIETARY INFORMATION SHOWN HEREON IS NOT TO BE TRANSMITTED TO ANY OTHER ORGANIZATION WITHOUT SPECIFIC AUTHORIZATION BY THE HILFIKER COMPANY. HILFIKER RETAINING WALLS ARE PROTECTED BY ONE OR MORE OF THE FOLLOWING PATENTS: 2,433,613; 2,433,697; 2,886,616; 4,117,686; 4,329,089; 4,324,506; 4,391,557; 4,505,621; 4,343,318; 4,661,023; 4,856,939; 4,929,125; 5,076,735; 5,647,695; 5,722,799; 5,733,072; 6,357,970B1; 6,874,975B2; 7,033,118B2; AND OTHERS. OTHER PATENTS PENDING (2008)

REV. NO.	DATE	BY	DESCRIPTION
1	6 JAN 03	DR	MINOR REVISIONS
2	17 OCT 08	AMJ	UPDATED BORDER, MINOR REVISIONS
3	1 AUG 12	AMJ	ADDED COLOR TO DETAILS
4	23 OCT 13	AMJ	MINOR REVISIONS, FIXED LEADERS
5	1 AUG 22	NMD	ADDED MIRAMESH

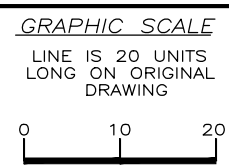

PROJ. MGR.  
ENGINEER  
CADD BY  
HRW

**HILFIKER RETAINING WALLS**

1902 Hilfiker Lane  
Eureka, CA 95503-5711  
TOLL-FREE 800.762.8962  
PH 707.443.5093 FAX 707.443.2891  
WEBSITE www.hilfiker.com E-MAIL info@hilfiker.com

SINCE 1902  
QUALITY PRODUCTS

DWG DATE  
NOV 98  
REVISION DATE  
1 AUG 22  
SCALE  
NOTED

STANDARD DRAWING	PROJECT NO.
WELDED WIRE RETAINING WALL 24" LIFTS	SHEET 3
STANDARD DETAILS	OF 3