

STEP 1
PLACE THE FIRST COURSE OF SOIL REINFORCEMENT MATS ON PREPARED FOUNDATION.
PLACE CONTINUOUS MIRAGRID AS SHOWN.

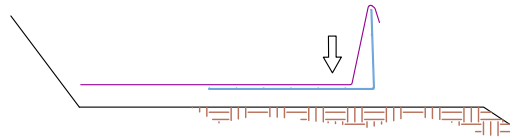

STEP 2
PLACE THE BACKING MAT AND MIRAMESH (IF REQUIRED) AGAINST THE INSIDE FACE OF THE SOIL REINFORCEMENT MAT. CLIP THE SECOND-TO-TOP TRANSVERSE WIRE ON THE BACKING MAT TO THE TOP TRANSVERSE WIRE ON THE SOIL REINFORCEMENT MAT.

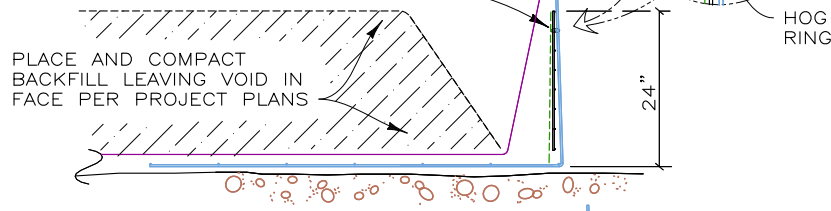

STEP 3
BRING THE MIRAGRID OVER THE FRONT AND TOP OF THE BACKFILL AS SHOWN. PLACE SPECIAL FILLING IN THE FACE OF THE WALL PER PROJECT PLANS. LEAVE A VOID AS SHOWN.

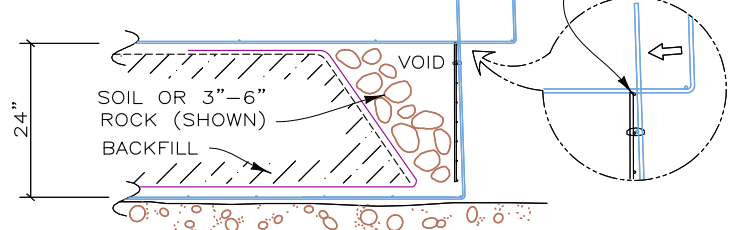

STEP 4
HOOK THE BOTTOM TRANSVERSE WIRE OF THE BACKING MAT OVER THE VERTICAL PRONGS ON THE LOWER MAT. ROTATE THE BACKING MAT TO VERTICAL AND CLIP THE SECOND-TO-TOP TRANSVERSE WIRE ON THE BACKING MAT AND THE MIRAGRID (IF REQUIRED) TO THE TOP WIRE ON THE SOIL REINFORCEMENT MAT.

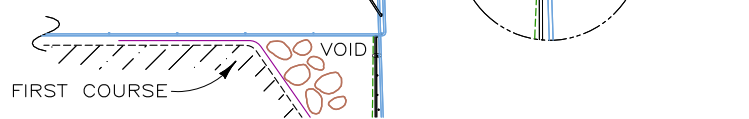

STEP 5
INSTALL MIRAGRID AS IN STEPS 1 AND 2. PLACE AND COMPACT THE BACKFILL AND ROCK TO THE BASE ELEVATION OF THE NEXT MAT. REPEAT STEPS 2 THROUGH 5 TO THE TOP LIFT.

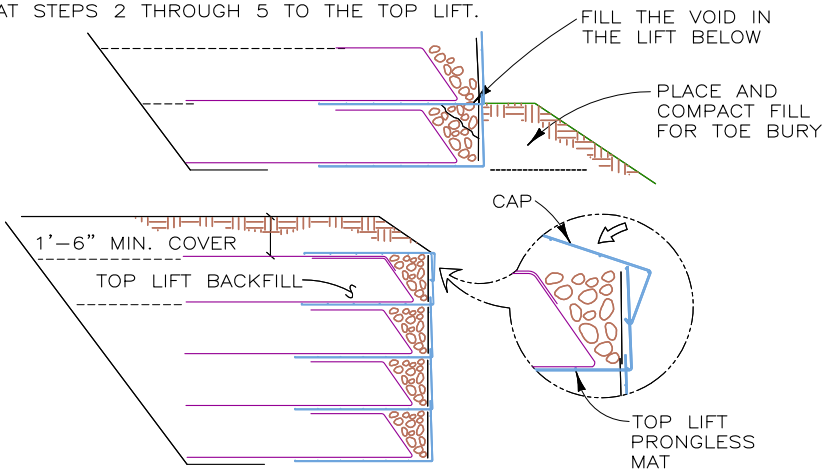

STEP 6: TOP LIFT
PLACE THE TOP LIFT PRONGLESS MAT, BACKING MAT AND MIRAGRID. PLACE AND COMPACT BACKFILL AND ROCK OR SOIL IN THE TOP LIFT. PLACE FINAL LAYER OF MIRAGRID, OVERLAPPING PER PROJECT PLANS. HOOK THE CAP OVER THE MIDDLE TRANSVERSE WIRE ON THE PRONGLESS MAT, AND ROTATE INTO PLACE. PLACE AND COMPACT COVER OVER TOP MAT TO 1'-6\"/>

CONSTRUCTION SEQUENCE

NOT TO SCALE

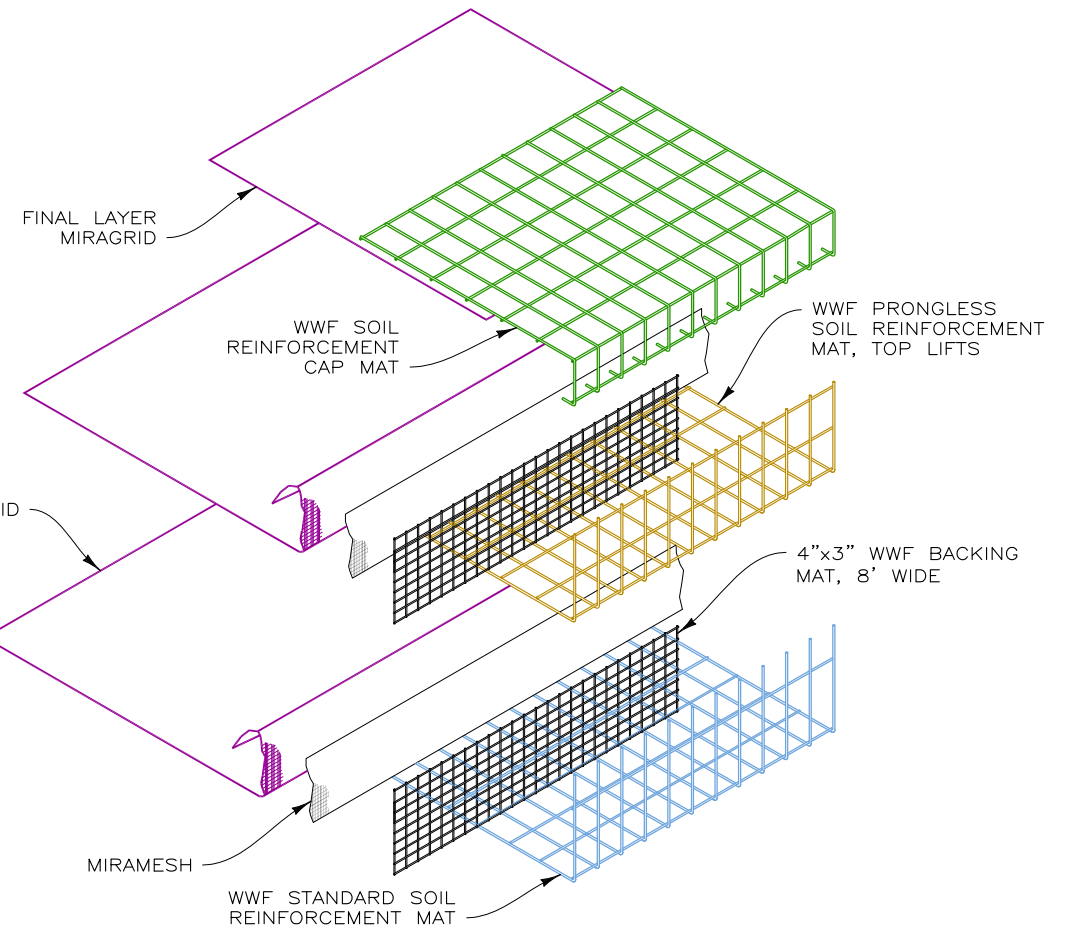

WALL COMPONENTS
NOT TO SCALE

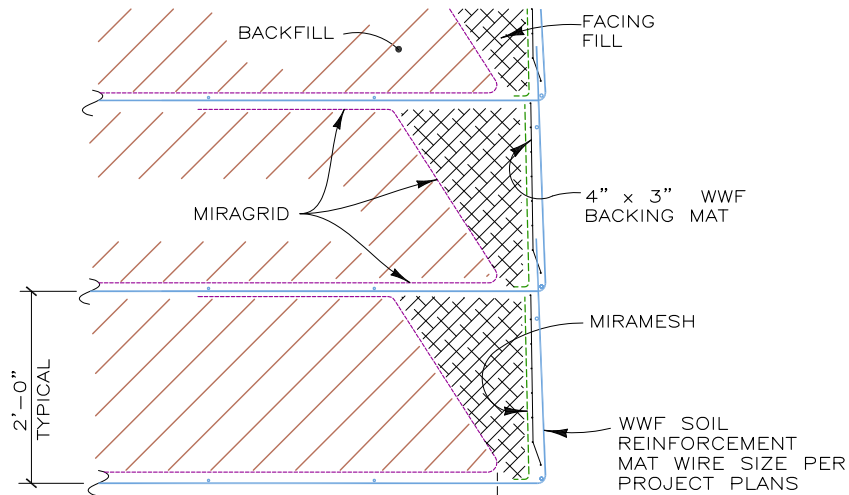

SECTION WALL FACE DETAIL
NOT TO SCALE

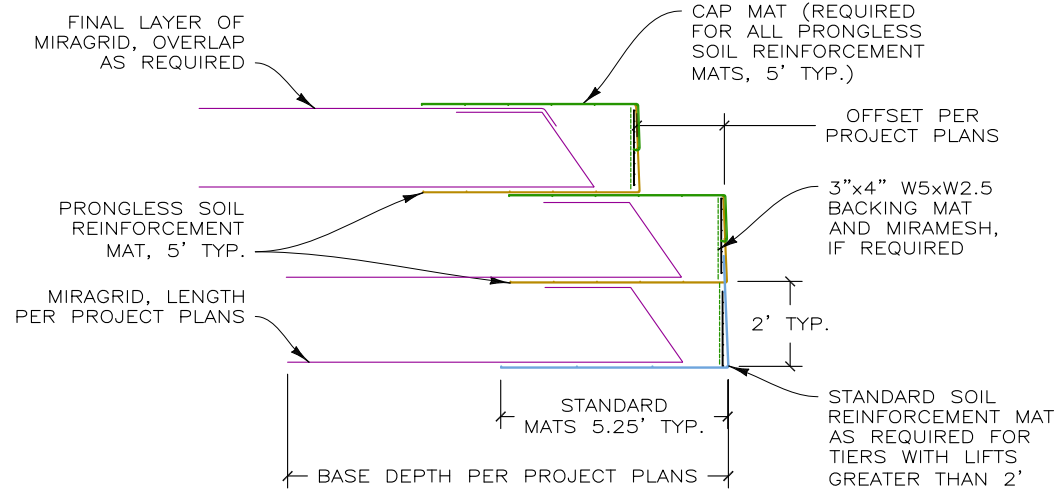

WIRE FACED MIRAGRID WALL DETAILS
NOT TO SCALE

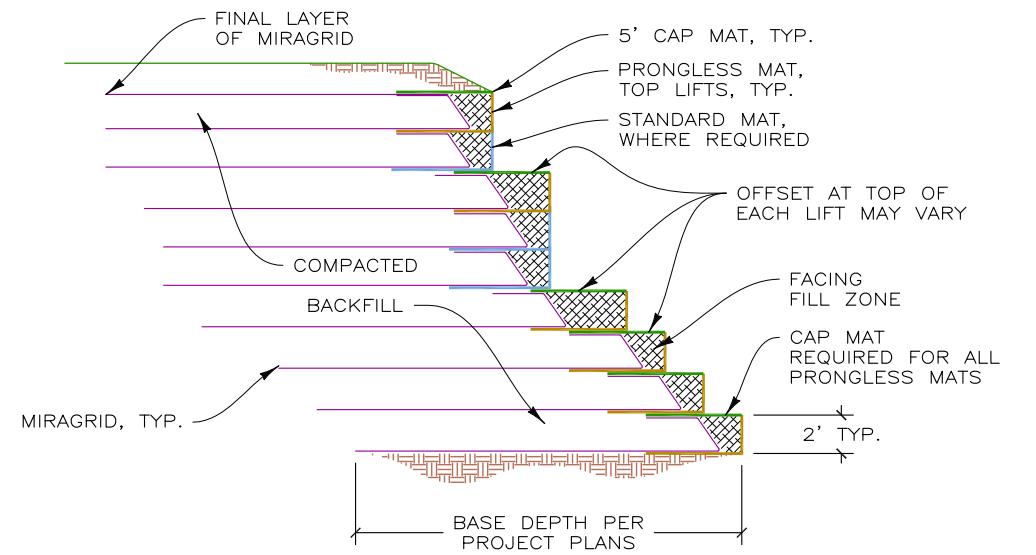

MIRAGRID VARIABLE BATTER WALL SECTION
NOT TO SCALE

STANDARD DRAWINGS\WELDED WIRE WALL\WIRE FACED MIRAGRID WALL

THIS DRAWING IS FURNISHED SOLELY FOR THE USE OF OR IN CONNECTION WITH THIS PROJECT AND THE PROPRIETARY INFORMATION SHOWN HEREON IS NOT TO BE TRANSMITTED TO ANY OTHER ORGANIZATION WITHOUT SPECIFIC AUTHORIZATION BY THE HILFIKER COMPANY. HILFIKER RETAINING WALLS ARE PROTECTED BY ONE OR MORE OF THE FOLLOWING PATENTS: 243,613; 243,697; 288,616; 4,117,686; 4,329,089; 4,324,508; 4,391,557; 4,505,621; 4,343,318; 4,661,023; 4,856,939; 4,929,125; 5,076,735; 5,647,695; 5,722,799; 5,733,072; 6,357,970B1; 6,874,975B2; 7,033,118B2; AND OTHERS. OTHER PATENTS PENDING (2008)

REV.NO.	DATE	BY	DESCRIPTION

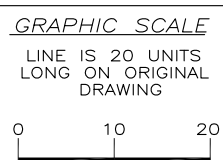

PROJ. MGR.
HKH
ENGINEER
CADD BY
AMJ

HILFIKER RETAINING WALLS

1902 Hilfiker Lane
Eureka, CA 95503-5711
TOLL-FREE 800.762.8962
PH 707.443.5093 FAX 707.443.2691
WEBSITE www.hilfiker.com E-MAIL Info@hilfiker.com

DWG DATE
10 JUN 14
REVISION DATE
SCALE
NOTED

STANDARD DRAWING
WELDED WIRE WALL
WIRE FACED MIRAGRID WALL
STANDARD DETAILS

PROJECT NO.
--
SHEET
1
OF 1